

CONSTRUCTION DRAWINGS
FOR
CLARK PARCELS YAMPA RIVER IMPROVEMENTS
753 DOUGHERTY ROAD & 35975 US HIGHWAY 40

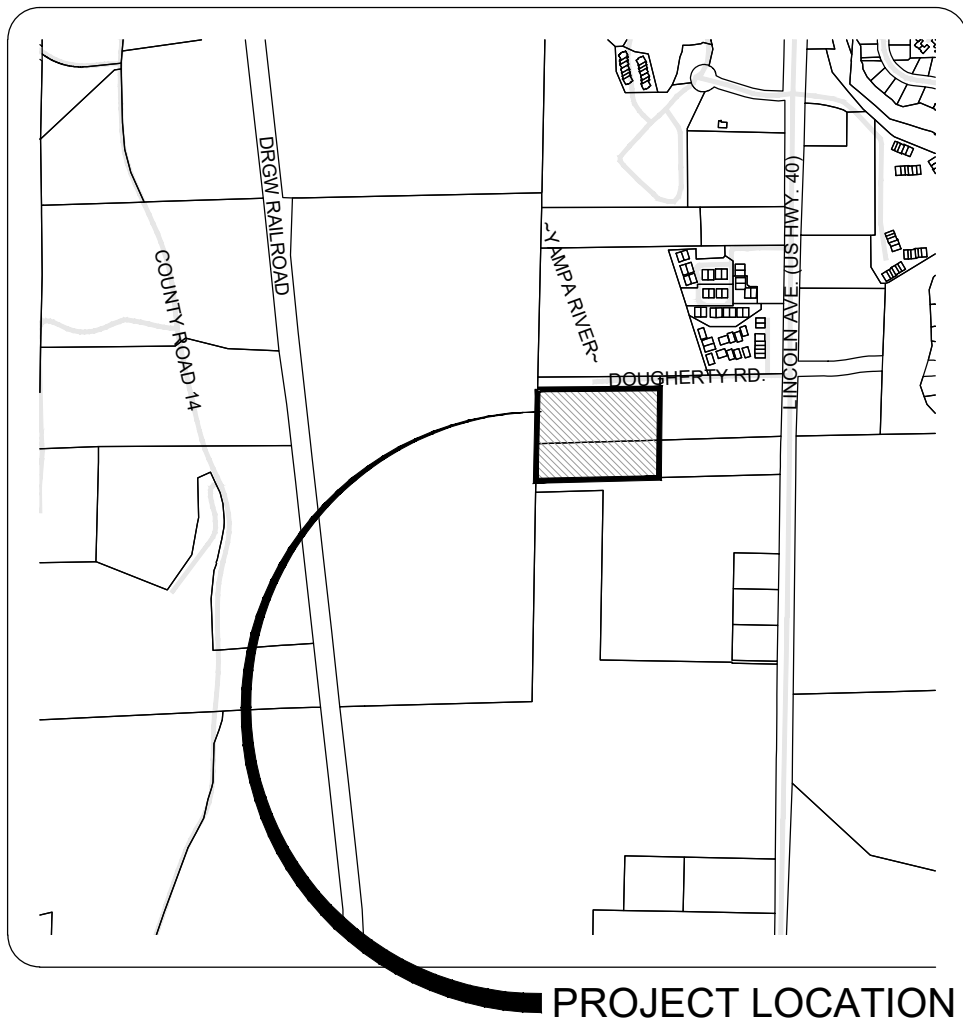

VICINITY MAP

PROJECT TEAM

OWNERS
BACK ATCHA LLC
753 DOUGHERTY ROAD
STEAMBOAT SPRINGS, CO 80487

SOUTHSHORE PLOW SERVICE LLC
D/B/A SNOW COUNTRY NURSERY
35975 US HIGHWAY 40
STEAMBOAT SPRINGS, CO 80487

CIVIL ENGINEER
LANDMARK CONSULTANTS, INC.
141 9TH STREET
STEAMBOAT SPRINGS, CO 80487
(970) 871-9494
ATTN: RYAN SPAUSTAT, P.E.

BASE MAPPING SURVEYOR
LANDMARK CONSULTANTS, INC.
141 9TH STREET
STEAMBOAT SPRINGS, CO 80487
(970) 871-9494
ATTN: JEFF GUSTAFSON, P.L.S.

UTILITY CONTACT LIST

UTILITY PROVIDER	CONTACT	PHONE NUMBER
CITY OF STEAMBOAT SPRINGS PUBLIC WORKS	JON SNYDER, P.E.	(970) 871-8293
CITY OF STEAMBOAT SPRINGS UTILITIES	MICHELLE CARR, P.E.	(970) 871-8207
MT. WERNER WATER & SANITATION DISTRICT	FRANK ALFONE	(970) 879-2424
YAMPA VALLEY ELECTRIC ASSOCIATION	LARRY BALL	(970) 871-2282
ATMOS ENERGY	DON CRANE	(970) 879-3223
CENTURY LINK	JASON SHARPE	(970) 328-8290
COMCAST	ANDY NEWBY	(303) 547-4584
UTILITY NOTIFICATION CENTER OF COLORADO	N/A	(800) 922-1987

THIS LIST IS PROVIDED AS A COURTESY REFERENCE ONLY. LANDMARK CONSULTANTS, INC. ASSUMES NO RESPONSIBILITY FOR THE ACCURACY OR COMPLETENESS OF THIS LIST. IN NO WAY SHALL THIS LIST RELINQUISH THE CONTRACTOR'S RESPONSIBILITY FOR LOCATING ALL UTILITIES PRIOR TO COMMENCING ANY CONSTRUCTION ACTIVITY. PLEASE CONTACT THE UTILITY NOTIFICATION CENTER OF COLORADO (UNCC) AT 811 FOR ADDITIONAL INFORMATION.

SHEET INDEX

- C.001 - COVER SHEET
- C.002 - NOTES
- C.003 - EXISTING CONDITIONS EXHIBIT
- C.100 - CONSTRUCTION SET
- C.110 - RIVER CROSS-SECTIONS
- C.500 - DETAILS

NO.	DATE	BY	DESCRIPTION

PROJECT: 2545-001
DATE: 10/16/2023
CONTACT: RYAN SPAUSTAT
EMAIL: ryan@landmark-co.com

Clark Parcels
Yampa River Rehabilitation
Cover Sheet

SHEET
C.001

CALL UTILITY NOTIFICATION CENTER OF COLORADO



Know what's below.
Call before you dig.

CALL 2 BUSINESS DAYS IN ADVANCE BEFORE YOU DIG, GRADE, OR EXCAVATE FOR THE MARKING OF UNDERGROUND MEMBER UTILITIES.



NOT VALID WITHOUT ORIGINAL SIGNATURE AND DATE

DRAWING FILE NAME: P:\525-070\Drawings\Drawings\254-001-C002\Notes.dwg LAYOUT NAME: C002 DATE: Oct 17, 2023 3:58pm CAD OPERATOR: dls
LIST OF REVISIONS: (4/20/2023)

GENERAL NOTES

- TOPOGRAPHIC AND EXISTING CONDITIONS PER CITY GIS DATA AND SUPPLEMENTED WITH LANDMARK CONSULTANTS, INC. ARCHIVED SURVEY FIELD DATA. LANDMARK IS NOT RESPONSIBLE FOR THE ACCURACY OR COMPLETENESS OF THE EXISTING CONDITIONS AND/OR PROPERTY INFORMATION (INCLUDING EASEMENTS AND ENCUMBRANCES) AND THE OWNER ASSUMES ALL RISK WITH COMPLYING WITH THE LEGAL REQUIREMENTS OF THIS PROJECT.
- ROUT COUNTY PLAN REVIEW AND APPROVAL IS ONLY FOR GENERAL CONFORMANCE WITH CITY DESIGN CRITERIA AND THE CITY CODE. THE COUNTY IS NOT RESPONSIBLE FOR THE COMPLETENESS, ACCURACY AND ADEQUACY OF THE DRAWINGS, DESIGN, DIMENSIONS, AND ELEVATIONS SHALL BE CONFIRMED AND CORRELATED AT THE JOB SITE.
- ONE COPY OF THE APPROVED CONSTRUCTION PLANS AND SPECIFICATIONS SHALL BE KEPT ON THE JOB SITE AT ALL TIMES. PRIOR TO THE START OF CONSTRUCTION, VERIFY WITH PROJECT ENGINEER THE LATEST REVISION DATE OF THE APPROVED CONSTRUCTION PLANS.
- ALL MATERIALS, WORKMANSHIP, AND CONSTRUCTION OF PUBLIC IMPROVEMENTS SHALL MEET OR EXCEED THE STANDARDS AND SPECIFICATIONS SET FORTH IN THE CITY OF STEAMBOAT SPRINGS TECHNICAL SPECIFICATIONS (MARCH, 2016 EDITION), THE "STANDARD SPECIFICATIONS FOR ROAD AND BRIDGE CONSTRUCTION" BY THE COLORADO DEPARTMENT OF TRANSPORTATION, (2017 EDITION), AND APPLICABLE STATE AND FEDERAL REGULATIONS, WHERE THERE IS A DIRECT CONFLICT BETWEEN THESE PLANS AND THE SPECIFICATIONS, OR ANY APPLICABLE STANDARDS, THE MOST RESTRICTIVE STANDARD SHALL APPLY.
- ALL NECESSARY PERMITS AND APPROVALS FROM ALL APPLICABLE AGENCIES AS REQUIRED MUST BE OBTAINED IN ORDER TO PERFORM THE WORK. THIS INCLUDES, BUT IS NOT LIMITED TO, RIGHT-OF-WAY PERMIT, GRADING AND EXCAVATION PERMIT, CONSTRUCTION Dewatering PERMIT, STORM WATER QUALITY PERMIT, ARMY CORP. OF ENGINEERS PERMIT, ETC. IT IS THE APPLICABLE CONTRACTOR'S RESPONSIBILITY TO OBTAIN A COPY OF ALL APPLICABLE CODES, LICENSES, SPECIFICATIONS, AND STANDARDS NECESSARY TO PERFORM THE WORK, AND BE FAMILIAR WITH THEIR CONTENTS PRIOR TO COMMENCING ANY WORK.
- PRIOR TO START OF CONSTRUCTION A PRE-CONSTRUCTION MEETING SHALL BE SCHEDULED WITH THE APPROPRIATE CONTRACTORS, ENGINEER, SURVEYOR, TESTING COMPANY, AFFECTED AGENCIES AND KEY SUBCONTRACTORS A MINIMUM OF 48-HOURS PRIOR TO THE START OF WORK.
- THE LOCAL ENTITY AND ENGINEER SHALL BE NOTIFIED AT LEAST 2 WORKING DAYS PRIOR TO THE START OF ANY EARTH DISTURBING ACTIVITY, OR CONSTRUCTION ON ANY AND ALL PUBLIC IMPROVEMENTS. THE LOCAL ENTITY RESERVES THE RIGHT NOT TO ACCEPT THE IMPROVEMENTS IF SUBSEQUENT TESTING REVEALS AN IMPROPER INSTALLATION.
- COORDINATE WITH THE PROJECT ENGINEER TO IDENTIFY PROJECT INSPECTION AND TESTING REQUIREMENTS. PROVIDE FOR INSPECTIONS AND TESTING AT AN ADEQUATE FREQUENCY FOR THE PROJECT ENGINEER TO DOCUMENT THAT PROJECT IS CONSTRUCTED IN CONFORMANCE WITH THE APPROVED PLANS AND SPECIFICATIONS. PRIOR TO MAKING ANY CHANGES TO THE APPROVED PLANS, IT IS THE APPROPRIATE CONTRACTOR'S RESPONSIBILITY TO COORDINATE WITH THE PROJECT ENGINEER.
- PROVIDE THE OWNER, ENGINEER, THEIR CONSULTANTS, INDEPENDENT TESTING LABORATORIES, ANY GOVERNMENTAL AGENCIES WITH JURISDICTIONAL INTERESTS, OTHER REPRESENTATIVES AND PERSONNEL ACCESS TO THE SITE AND THE WORK AT REASONABLE TIMES FOR THEIR OBSERVATION, INSPECTING, AND TESTING. PROVIDE THEM PROPER AND SAFE CONDITIONS FOR SUCH ACCESS AND ADVISE THEM OF THE DEVELOPER'S SITE SAFETY PROCEDURES AND PROGRAMS SO THAT THEY MAY COMPLY THEREWITH AS IS APPLICABLE. COORDINATE WITH THE PROJECT ENGINEER SO THAT INSPECTING AND TESTING ARE PROVIDED AT AN ADEQUATE FREQUENCY FOR THE PROJECT ENGINEER TO AFFIRM THAT WORK WAS COMPLETED IN SUBSTANTIAL CONFORMANCE WITH THESE APPROVED PLANS.
- SUBMIT A CONSTRUCTION SITE MANAGEMENT PLAN (CSMP) FOR REVIEW AND APPROVAL BY THE CITY CONSTRUCTION SERVICES FOREMAN PRIOR TO START OF CONSTRUCTION. THE CSMP MUST BE MAINTAINED ON-SITE AND UPDATED AS NEEDED TO REFLECT CURRENT CONDITIONS.
- ALL CONTRACTORS ARE SPECIFICALLY CAUTIONED THAT THE LOCATION AND/OR ELEVATION OF EXISTING UTILITIES, AS SHOWN ON THESE PLANS, IS BASED ON RECORDS OF THE VARIOUS UTILITY COMPANIES AND, WHERE POSSIBLE, MEASUREMENTS TAKEN IN THE FIELD. THE INFORMATION IS NOT TO BE RELIED UPON AS BEING EXACT OR COMPLETE. CONTACT THE UTILITY NOTIFICATION CENTER OF COLORADO (UNCC) AT 1-800-422-1997, AT LEAST 2 WORKING DAYS PRIOR TO BEGINNING EXCAVATION OR GRADING, TO HAVE ALL LOCATIONS MARKED. OTHER UNREGISTERED UTILITY ENTITIES (I.E. DITCH / IRRIGATION COMPANY) ARE TO BE LOCATED BY CONTACTING THE RESPECTIVE REPRESENTATIVE. UTILITY SERVICE LATERALS ARE ALSO TO BE LOCATED PRIOR TO BEGINNING EXCAVATION OR GRADING, THE TYPE, SIZE, LOCATION AND NUMBER OF ALL KNOWN UNDERGROUND UTILITIES ARE APPROXIMATE WHEN SHOWN ON THE DRAWINGS. VERIFY THE EXISTENCE AND LOCATION OF ALL UNDERGROUND UTILITIES ALONG THE ROUTE OF THE WORK BEFORE COMMENCING NEW CONSTRUCTION. THE CONTRACTOR SHALL NOTIFY THE ENGINEER OF ALL EXISTING UTILITIES THAT CONFLICT WITH THE PROPOSED IMPROVEMENTS SHOWN ON THESE PLANS.
- COORDINATE AND COOPERATE WITH THE LOCAL ENTITY, AND ALL UTILITY COMPANIES INVOLVED, WITH REGARD TO RELOCATIONS, ADJUSTMENTS, EXTENSIONS AND REARRANGEMENTS OF EXISTING UTILITIES DURING CONSTRUCTION, AND TO ASSURE THAT THE WORK IS ACCOMPLISHED IN A TIMELY FASHION, AND WITH A MINIMUM DISRUPTION OF SERVICE. CONTACT, IN ADVANCE, ALL PARTIES AFFECTED BY ANY DISRUPTION OF ANY UTILITY SERVICE AS WELL AS THE UTILITY COMPANIES.
- PROTECT ALL UTILITIES DURING CONSTRUCTION AND COORDINATE WITH THE APPROPRIATE UTILITY COMPANY FOR ANY UTILITY CROSSINGS REQUIRED.
- WHEN APPLICABLE, THE DEVELOPER AND/OR CONTRACTOR SHALL HAVE ON-SITE AT ALL TIMES, EACH OF THE FOLLOWING:
 - BEST MANAGEMENT PRACTICES (BMP) MAINTENANCE FOLDER
 - UP-TO-DATE STORMWATER MANAGEMENT PLAN (SWMP) THAT ACCURATELY REPRESENTS CURRENT FIELD CONDITIONS
 - ONE (1) SIGNED COPY OF THE APPROVED PLANS
 - ONE (1) COPY OF THE APPROPRIATE STANDARDS AND SPECIFICATIONS
 - A COPY OF ANY PERMITS AND EXTENSION AGREEMENTS NEEDED FOR THE JOB.
- IF, DURING THE CONSTRUCTION PROCESS, CONDITIONS ARE ENCOUNTERED WHICH COULD INDICATE A SITUATION THAT IS NOT IDENTIFIED IN THE PLANS OR SPECIFICATIONS, CONTACT THE DESIGNER AND THE LOCAL ENTITY ENGINEER IMMEDIATELY.
- ALL REFERENCES TO ANY PUBLISHED STANDARDS SHALL REFER TO THE LATEST REVISION OF SAID STANDARD, UNLESS SPECIFICALLY STATED OTHERWISE.
- PROVIDE ALL LABOR AND MATERIALS NECESSARY FOR THE COMPLETION OF THE INTENDED IMPROVEMENTS SHOWN ON THESE DRAWINGS, OR DESIGNATED TO BE PROVIDED, INSTALLED, OR CONSTRUCTED, UNLESS SPECIFICALLY NOTED OTHERWISE.
- THE CONTRACTOR SHALL BE RESPONSIBLE FOR RECORDING AS-BUILT INFORMATION ON A SET OF RECORD DRAWINGS KEPT ON THE CONSTRUCTION SITE, AND AVAILABLE TO THE LOCAL ENTITY'S INSPECTOR AT ALL TIMES.
- DIMENSIONS FOR LAYOUT AND CONSTRUCTION ARE NOT TO BE SCALED FROM ANY DRAWING. IF PERTINENT DIMENSIONS OR ELEVATIONS ARE NOT SHOWN, CONTACT THE DESIGNER FOR CLARIFICATION, AND ANNOTATE THE PROVIDED DIMENSION ON THE AS-BUILT RECORD DRAWINGS. CONTOURS ARE NOT SUITABLE FOR CONSTRUCTION LAYOUT.
- SEQUENCE INSTALLATION OF UTILITIES IN SUCH A MANNER AS TO MINIMIZE POTENTIAL UTILITY CONFLICTS. IN GENERAL, GRADE RESTRICTED UTILITIES SUCH AS STORM SEWER AND SANITARY SEWER SHOULD BE CONSTRUCTED PRIOR TO INSTALLATION OF THE WATER LINES AND DRY UTILITIES.
- EXISTING FENCES, TREES, STREETS, SIDEWALKS, CURBS AND GUTTERS, LANDSCAPING, STRUCTURES, AND IMPROVEMENTS DESTROYED, DAMAGED OR REMOVED DUE TO CONSTRUCTION OF THIS PROJECT SHALL BE REPLACED OR RESTORED IN LIKE KIND AT THE CONTRACTOR'S EXPENSE, UNLESS OTHERWISE INDICATED ON THESE PLANS.
- THESE CONSTRUCTION PLANS SHALL BE VALID FOR A PERIOD OF THREE YEARS FROM THE DATE OF APPROVAL BY THE AUTHORITY HAVING JURISDICTION. USE OF THESE PLANS AFTER THE EXPIRATION DATE WILL REQUIRE A NEW REVIEW AND APPROVAL PROCESS BY THE LOCAL ENTITY PRIOR TO COMMENCEMENT OF ANY WORK SHOWN IN THESE PLANS.
- ALL CONSTRUCTION IN AREAS DESIGNATED AS WILD FIRE HAZARD AREAS SHALL BE DONE IN ACCORDANCE WITH THE CONSTRUCTION CRITERIA AS ESTABLISHED IN THE WILD FIRE HAZARD AREA MITIGATION REGULATIONS IN FORCE AT THE TIME OF CONSTRUCTION.
- THE CONTRACTOR AGREES THAT BY COMMENCING CONSTRUCTION THAT HE SHALL ASSUME SOLE AND COMPLETE RESPONSIBILITY FOR JOB SITE CONDITIONS DURING THE CONSTRUCTION OF THE PROJECT, INCLUDING, BUT NOT LIMITED TO, THE SAFETY OF ALL PERSONS AND PROPERTY, THAT THIS REQUIREMENT SHALL APPLY CONTINUOUSLY AND TO NORMAL WORKING HOURS, AND THAT THE CONTRACTOR SHALL DEFEND, INDEMNIFY AND HOLD THE ENGINEER, AND THE GOVERNING AGENCIES AND THE OFFICERS, DIRECTORS, PARTNERS, EMPLOYEES, AGENTS AND OTHER CONSULTANTS OF EACH AND ANY OF THEM HARMLESS FROM ANY AND ALL LIABILITY, REAL OR ALLEGED, IN CONNECTION WITH THE PERFORMANCE OF WORK ON THIS PROJECT, EXCEPT FOR LIABILITY ARISING FROM THE NEGLIGENCE OF THE OWNER, THE ENGINEER, OR THE GOVERNING AGENCIES.
- NOTIFY THE ENGINEER IMMEDIATELY UPON DISCOVERING ANY CONFLICTS OR OTHER PROBLEMS IN CONFORMING TO THE APPROVED CONSTRUCTION DRAWINGS, SPECIFICATIONS OR DETAILS FOR ANY ELEMENT OF THE PROPOSED IMPROVEMENTS PRIOR TO PROCEEDING WITH ITS CONSTRUCTION.
- COORDINATE THE INSTALLATION OR RELOCATION OF THE DRY UTILITY COMPANY'S FACILITIES. COST OF THE DRY UTILITY WORK SHALL BE BORNE BY THE OWNER, EXCEPT AS INDICATED IN THE PLANS AND SPECIFICATIONS.
- PRESERVE PRIVATE AND PUBLIC PROPERTY AND PROTECT IT FROM DAMAGE THAT MAY RESULT FROM CONSTRUCTING THESE PROPOSED IMPROVEMENTS.
- ACCESS TO ALL ADJACENT PROPERTIES AND FACILITIES SHALL BE MAINTAINED AT ALL TIMES. REQUIRED INTERRUPTION OF ACCESS SHALL BE COORDINATED WITH THE PROPERTY AND PROJECT OWNERS.
- IF HAZARDOUS MATERIAL OR SUSPECT MATERIAL IS ENCOUNTERED NOTIFY THE OWNER AND ENGINEER BEFORE CONTINUING WORK. HAZARDOUS MATERIALS SHALL BE REMOVED AS REQUIRED.
- THE APPROPRIATE CONTRACTOR SHALL BE RESPONSIBLE FOR THE SOURCE OF CONSTRUCTION WATER FOR USE ON THIS PROJECT.
- EXCESS MATERIAL SHALL BE REMOVED FROM SITE AND HANDLED IN ACCORDANCE TO ALL RULES AND REQUIREMENTS. A SEPARATE PERMIT MAY BE REQUIRED AND SHALL BE COORDINATED WITH THE AUTHORITY HAVING JURISDICTION.
- OFFSITE AND ADJACENT SITE DATA IS SHOWN FOR REFERENCE PURPOSES ONLY.
- ALL LANDSCAPING, REVEGETATION AND WETLANDS REQUIREMENTS DESIGN IS BY OTHERS. ALL DISTURBED AREAS ARE TO BE REVEGETATED UNLESS OTHERWISE NOTED.
- ENSURE THAT WORK FOR THIS PROJECT BE PERFORMED BY CONTRACTORS (INCLUDING CONTRACTOR'S EMPLOYEES AND AGENTS) POSSESSING THE SKILLS, EXPERTISE AND UNDERSTANDING OF ALL APPLICABLE CODES, SPECIFICATIONS, STANDARDS AND MANUFACTURER REQUIREMENTS. BY COMMENCING WORK, THE CONTRACTORS REPRESENT THAT THEY UNDERSTAND AND ACCEPT THIS REQUIREMENT.
- ALL CONSTRUCTION ACTIVITIES AND DISTURBANCES SHALL OCCUR WITHIN THE PROPERTY LIMITS. WHERE OFF-SITE WORK IS APPROVED, WRITTEN PERMISSION OF THE ADJACENT PROPERTY OWNER MUST BE OBTAINED PRIOR TO ANY OFF-SITE GRADING OR CONSTRUCTION.

CONSTRUCTION NOTES

A. GRADING AND DRAINAGE

- NO WORK SHALL OCCUR IN WETLANDS OR FLOODPLAINS WITHOUT PERMITS. ANY WORK SHALL BE IN ACCORDANCE WITH ISSUED PERMITS.
- VEGETATED SLOPES GREATER THAN 3:1 REQUIRE SOIL STABILIZATION.
- MINIMUM RECOMMENDATIONS (TO BE CONFIRMED OR REPLACED BY GEOTECHNICAL ENGINEER): PROPOSED FILL AREAS WHERE PAVEMENT OR SITE CONCRETE IS ANTICIPATED SHOULD BE PREPARED BY STRIPPING EXISTING TOPSOIL AND ORGANIC MATERIALS, SCARIFICATION TO A DEPTH OF AT LEAST 8 INCHES AND COMPACTION TO MINIMUM VALUES GIVEN BELOW. MOISTURE CONDITIONING MAY BE REQUIRED TO ATTAIN STABILITY AND MINIMUM COMPACTION.
- SITE FILLS AND TRENCH BACKFILL SHOULD CONSIST OF APPROVED ON-SITE OR IMPORTED MATERIALS. FILLS SHOULD BE UNIFORMLY PLACED AND COMPACTED IN 6 TO 8 INCH LOOSE LIFTS TO AT LEAST 95 PERCENT OF THE MAXIMUM STANDARD PROCTOR DENSITY AND WITHIN 2 PERCENT OF THE OPTIMUM MOISTURE CONTENT (ASTM D698). MOISTURE CONDITIONING OF FILL MATERIALS MAY BE REQUIRED TO ATTAIN MINIMUM COMPACTION AND STABILITY REQUIREMENTS

B. CONSTRUCTION SITE AND STORMWATER MANAGEMENT

- CONTRACTOR SHALL SUBMIT A CONSTRUCTION SITE MANAGEMENT PLAN TO THE CITY FOR APPROVAL PRIOR TO BUILDING PERMIT ISSUANCE.
- WHEN REQUIRED THE CONTRACTOR SHALL PREPARE A STORMWATER MANAGEMENT PLAN. THE STORMWATER MANAGEMENT PLAN SHALL BE PREPARED BY A QUALIFIED INDIVIDUAL WITH KNOWLEDGE IN THE PRINCIPLES AND PRACTICES OF EROSION AND SEDIMENT CONTROL AND POLLUTION PREVENTION. THIS INDIVIDUAL SHOULD BE RESPONSIBLE FOR DEVELOPING, IMPLEMENTING, MAINTAINING, AND REVISING THE STORMWATER MANAGEMENT PLAN FOR THE DURATION OF THE PROJECT.

- THE STORMWATER MANAGEMENT PLAN SHOULD ADDRESS INSTALLATION, INSPECTION AND MAINTENANCE OF ALL NECESSARY EROSION AND SEDIMENT CONTROL DURING CONSTRUCTION AND REMOVE EROSION CONTROL WHEN PROJECT IS COMPLETE AND VEGETATION IS ESTABLISHED. WHEN TEMPORARY EROSION CONTROL MEASURES ARE REMOVED, CLEAN UP AND REMOVE ALL SEDIMENT AND DEBRIS FROM ALL DRAINAGE INFRASTRUCTURE AND OTHER PUBLIC FACILITIES.
- ALL REQUIRED PERIMETER SILT AND CONSTRUCTION FENCING SHALL BE INSTALLED PRIOR TO ANY LAND DISTURBING ACTIVITY (STOCKPILING, STRIPPING, GRADING, ETC.). ALL OTHER REQUIRED EROSION CONTROL MEASURES SHALL BE INSTALLED AT THE APPROPRIATE TIME IN THE CONSTRUCTION SEQUENCE AS INDICATED IN THE APPROVED PROJECT SCHEDULE, CONSTRUCTION PLANS, AND STORMWATER MANAGEMENT PLAN.
- ENSURE THAT NO MUD OR DEBRIS SHALL BE TRACKED ONTO THE EXISTING PUBLIC STREET SYSTEM. MUD AND DEBRIS MUST BE REMOVED BY THE END OF EACH WORKING DAY BY AN APPROPRIATE MECHANICAL METHOD (I.E. MACHINE BROOM SWEEP, LIGHT DUTY FRONT-END LOADER, ETC.) OR AS APPROVED BY THE LOCAL ENTITY STREET INSPECTOR.
- ALL STRUCTURAL EROSION CONTROL MEASURES SHALL BE INSTALLED AT THE LIMITS OF CONSTRUCTION AND AT AREAS WITH DISTURBED SOIL, ON- OR OFF-SITE, PRIOR TO ANY OTHER GROUND-DISTURBING ACTIVITY. ALL EROSION CONTROL MEASURES SHALL BE MAINTAINED IN GOOD REPAIR, UNTIL SUCH TIME AS THE ENTIRE DISTURBED AREAS ARE STABILIZED WITH HARD SURFACE OR LANDSCAPING, TO MITIGATE EROSION. UTILIZE STANDARD EROSION CONTROL TECHNIQUES DESCRIBED IN THE URBAN STORM DRAINAGE CRITERIA MANUAL, VOLUME 3 - BEST MANAGEMENT PRACTICES, AS PUBLISHED BY THE URBAN DRAINAGE AND FLOOD CONTROL DISTRICT (UDFCD).
- PRE-DISTURBANCE VEGETATION SHALL BE PROTECTED AND RETAINED WHEREVER POSSIBLE. REMOVAL OR DISTURBANCE OF EXISTING VEGETATION SHALL BE LIMITED TO THE AREA(S) REQUIRED FOR IMMEDIATE CONSTRUCTION OPERATIONS, AND FOR THE SHORTEST PRACTICAL PERIOD OF TIME.
- IMMEDIATELY CLEAN UP ANY CONSTRUCTION MATERIALS INADVERTENTLY DEPOSITED ON EXISTING STREETS, SIDEWALKS, OR OTHER PUBLIC RIGHTS OF WAY, AND MAKE SURE STREETS AND WALKWAYS ARE CLEANED AT THE END OF EACH WORKING DAY.
- ALL RETAINED SEDIMENTS, PARTICULARLY THOSE ON PAVED ROADWAY SURFACES, SHALL BE REMOVED AND DISPOSED OF IN A MANNER AND LOCATION SO AS NOT TO CAUSE THEIR RELEASE INTO ANY WATERS OF THE UNITED STATES.
- THE STORMWATER VOLUME CAPACITY OF DETENTION PONDS WILL BE RESTORED AND STORM SEWER LINES WILL BE CLEANED UPON COMPLETION OF THE PROJECT.
- THE COLORADO DISCHARGE PERMIT SYSTEM (CDPS) REQUIREMENTS MAKE IT UNLAWFUL TO DISCHARGE OR ALLOW THE DISCHARGE OF ANY POLLUTANT OR CONTAMINATED WATER FROM CONSTRUCTION SITES. POLLUTANTS INCLUDE, BUT ARE NOT LIMITED TO DISCARDED BUILDING MATERIALS, CONCRETE TRUCK WASHOUT, CHEMICALS, OIL AND GAS PRODUCTS, LITTER, AND SANITARY WASTE. TAKE WHATEVER MEASURES ARE NECESSARY TO ASSURE THE PROPER CONTAINMENT AND DISPOSAL OF POLLUTANTS ON THE SITE IN ACCORDANCE WITH ANY AND ALL APPLICABLE LOCAL, STATE, AND FEDERAL REGULATIONS.

PROJECT NOTES:

- AN AUTOCAD COMPATIBLE FILE WILL BE PROVIDED FOR CONSTRUCTION STAKING PURPOSES, UPON ACCEPTANCE OF LANDMARK'S CAD RELEASE POLICY.
- IF THESE DRAWINGS ARE PRESENTED IN A FORMAT OTHER THAN 24" X 36", THE GRAPHIC SCALE SHOULD NOT BE USED.
- THE CONTRACTOR ACKNOWLEDGES AND UNDERSTANDS THAT THE CONTRACT DOCUMENTS MAY REPRESENT IMPERFECT DATA AND MAY CONTAIN ERRORS, OMISSIONS, CONFLICTS, INCONSISTENCIES, CODE VIOLATIONS AND IMPROPER USE OF MATERIALS. SUCH DEFICIENCIES WILL BE CORRECTED WHEN IDENTIFIED. THE CONTRACTOR AGREES TO CAREFULLY STUDY AND COMPARE THE INDIVIDUAL CONTRACT DOCUMENTS AND REPORT AT ONCE IN WRITING TO THE OWNER ANY DEFICIENCIES THE CONTRACTOR MAY DISCOVER. THE CONTRACTOR FURTHER AGREES TO REQUIRE EACH SUBCONTRACTOR TO LIKEWISE STUDY THE DOCUMENTS AND REPORT AT ONCE ANY DEFICIENCIES DISCOVERED.
- THE CONTRACTOR SHALL RESOLVE ALL REPORTED APPLICABLE DEFICIENCIES WITH LANDMARK PRIOR TO AWARDDING ANY SUBCONTRACTS OR STARTING ANY WORK WITH THE CONTRACTOR'S OWN EMPLOYEES. IF ANY DEFICIENCIES CANNOT BE RESOLVED BY THE CONTRACTOR WITHOUT ADDITIONAL TIME OR ADDITIONAL EXPENSES, THE CONTRACTOR SHALL SO INFORM THE OWNER IN WRITING. ANY SUCH ADDITIONAL WORK PERFORMED PRIOR TO RECEIPT OF INSTRUCTIONS FROM THE OWNER WILL BE DONE AT THE CONTRACTOR'S RISK.

CONSTRUCTION PHASE SERVICES:

IT IS UNDERSTOOD AND AGREED THAT LANDMARK DOES NOT HAVE AN OBLIGATION TO CONDUCT CONSTRUCTION OBSERVATION OR REVIEW OF THE CONTRACTOR'S PERFORMANCE OR ANY OTHER CONSTRUCTION PHASE SERVICES, AND THAT SUCH SERVICES WILL BE PROVIDED FOR BY THE OWNER AS MAY BE REQUIRED BY THE CITY OF STEAMBOAT SPRINGS. THE OWNER ASSUMES ALL RESPONSIBILITY FOR INTERPRETATION OF THESE CONSTRUCTION DOCUMENTS AND FOR CONSTRUCTION OBSERVATION AND THE OWNER WAIVES ANY CLAIMS AGAINST LANDMARK THAT MAY BE IN ANY WAY CONNECTED THERETO. IN ADDITION, THE OWNER AGREES, TO THE FULLEST EXTENT PERMITTED BY LAW, TO INDEMNIFY AND HOLD HARMLESS LANDMARK, ITS OFFICERS, DIRECTORS, EMPLOYEES AND SUBCONSULTANTS (COLLECTIVELY, LANDMARK) AGAINST ALL DAMAGES, LIABILITIES OR COSTS, INCLUDING REASONABLE ATTORNEYS' FEES AND DEFENSE COSTS, ARISING OUT OF OR IN ANY WAY CONNECTED WITH THE PERFORMANCE OF SUCH SERVICES BY OTHER PERSONS OR ENTITIES AND FROM ANY AND ALL CLAIMS ARISING FROM MODIFICATIONS, CLARIFICATIONS, INTERPRETATIONS, ADJUSTMENTS OR CHANGES MADE TO THESE CONSTRUCTION DOCUMENTS TO REFLECT CHANGED FIELD OR OTHER CONDITIONS, EXCEPT FOR CLAIMS ARISING FROM THE SOLE NEGLIGENCE OR WILLFUL MISCONDUCT OF LANDMARK.

ABBREVIATIONS	
ADA	AMERICAN'S WITH DISABILITIES ACT
APR	APPROXIMATE
BMP	BEST MANAGEMENT PRACTICE
BOT	BOTTOM
BVCE	BEGIN VERTICAL CURVE ELEVATION
BVCS	BEGIN VERTICAL CURVE STATION
BW / BOW	BOTTOM OF WALL
CAC	CUT AND CAPPED
CAP	CORRUGATED ALUMINUM PIPE
CIP	CAST-IN-PLACE
CL	CENTER LINE
OMP	CORRUGATED METAL PIPE
CO	CLEAN OUT
CP	CONCRETE PIPE
CSP	CORRUGATED STEEL PIPE
DIA	DIAMETER
DIP	DUCTILE IRON PIPE
EG	EXISTING GROUND
EL	ELEVATION
EOA / EA	EDGE OF ASPHALT
EOC	EDGE OF CONCRETE
EOP	EDGE OF PAVEMENT
EVCE	END VERTICAL CURVE ELEVATION
EVCS	END VERTICAL CURVE STATION
EX	EXISTING
F&G	FRAME AND GRATE
F&C	FRAME AND COVER
FES	FLARED END SECTION
FFE	FINISH FLOOR ELEVATION
FH	FIRE HYDRANT
FL	FLOW LINE
FG	FINISH GRADE
FG@BW	FINISH GRADE AT BOTTOM OF WALL
GB	GRADE BREAK
GFFE	GARAGE FINISH FLOOR ELEVATION
GTD	GRADE TO DRAIN
HOPE	HIGH-DENSITY POLYETHYLENE PIPE
INV	INVERT
LBS	POUNDS
LOD	LIMITS OF DISTURBANCE
MAX	MECHANICAL, ELECTRICAL, AND PLUMBING
ME	MAXIMUM
MEP	MATCH EXISTING
MH	MANHOLE
MIN	MINIMUM
MJ	MECHANICAL JOINT
NAP	NOT A PART (NOT INCLUDED IN SCOPE)
NTS	NOT TO SCALE
OFF	OFFSET
PC	POINT OF CURVE
PI	POINT OF INTERSECTION
PCC	POINT OF CONCAVE CURVE
PLDP	POROUS LANDSCAPE DETENTION POND
PRC	POINT OF REVERSE CURVE
PT	POINT OF TANGENT
PVC	POINT OF VERTICAL CURVE / POLYVINYL CHLORIDE PIPE
PVI	POINT OF VERTICAL INTERSECTION
PVT	POINT OF VERTICAL TANGENT
R	RADIUS
RCP	REINFORCED CONCRETE PIPE
REQ	REQUIRED
ROW	RIGHT OF WAY
STA	STATION
TB	THRUST BLOCK
TBC	TOP BACK OF CURB
TBR	TO BE REMOVED
TG	TOP OF GRATE
TOP	TOP OF PIPE
TTO	TAPERED TO GRADE
TW / TOW	TOP OF WALL
TYP	TYPICAL
VCP	VITRIFIED CLAY PIPE
VOL	VOLUME
W/	WITH

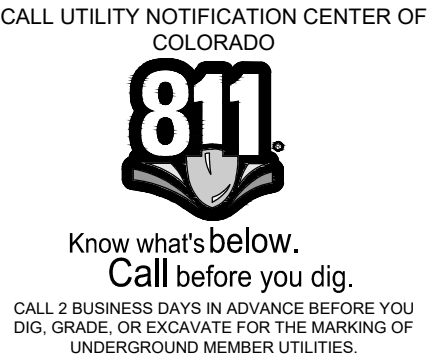

Clark Parcels

Yampa River Rehabilitation Notes

SHEET

C.002

NO.	DATE	BY	DESCRIPTION	PROJECT:	DATE:	CONTACT:	EMAIL:
				254-001	10/16/2023	RYAN SPAULSTAT	ryans@landmark-co.com

LANDMARK CONSULTANTS, INC.
CIVIL ENGINEERS / SURVEYORS

These drawings are instruments of service provided by Landmark Consultants, Inc. and are not to be used for any type of construction or contracting unless signed and sealed by a Professional Engineer in the employ of Landmark Consultants, Inc.

417 9th Street - P.O. Box 77843, Steamboat Springs, CO 80477
(970) 871-5494 - www.LANDMARKCO.com

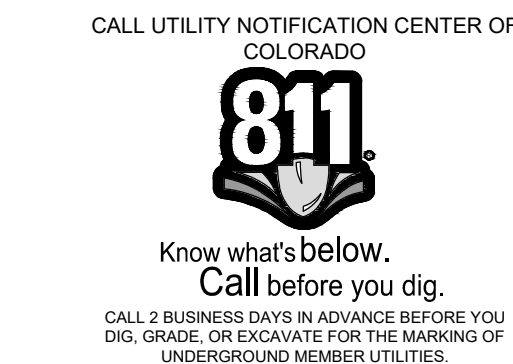

NOT VALID WITHOUT ORIGINAL
SIGNATURE AND DATE

1. ALL PROJECT DATA IS ON VERTICAL DATUM; NAVD 88. SEE NOTES SHEET FOR BENCHMARK REFERENCES.
2. DESIGN SUBJECT TO CHANGE BASED ON USACE AND RUTT COUNTY FLOODPLAIN DEVELOPMENT PERMITTING .

PROJECT:	2545-001
DATE:	10/16/2023
CONTACT:	RYAN SPAUSTAT
EMAIL:	ryans@landmark-co.com

Yampa River Rehabilitation Existing Conditions Exhibit

C.003

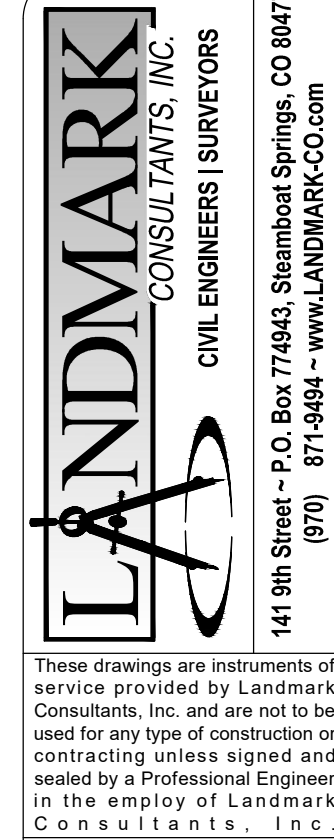

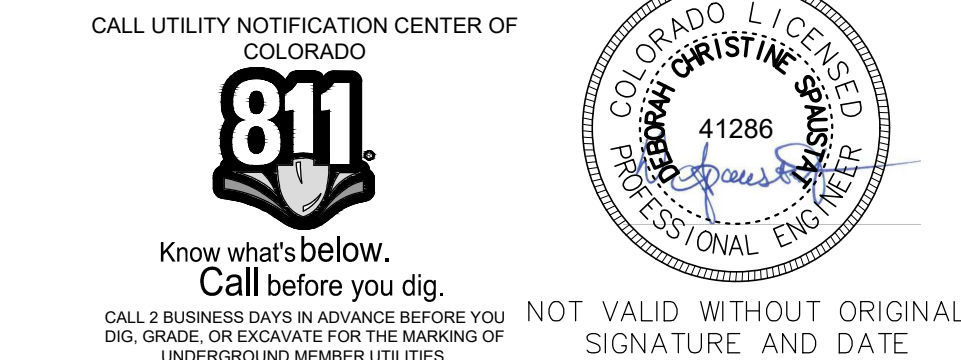
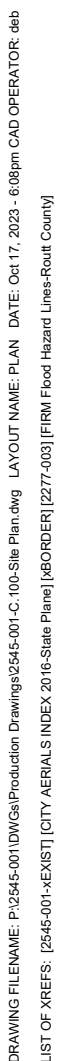

Boulder Vane



A diagram of a boulder vane, which is a long, narrow, and slightly curved structure. It is composed of a series of small, rounded, overlapping segments, resembling a chain of boulders or a series of small, rounded stones. The segments are arranged in a slightly curved line, with the curve facing upwards and to the right.

Root Wad



A diagram of a root wad, which is a long, narrow, and slightly curved structure. It is composed of a series of small, rounded, overlapping segments, resembling a chain of boulders or a series of small, rounded stones. The segments are arranged in a slightly curved line, with the curve facing upwards and to the right.

1. ALL PROJECT DATA IS ON VERTICAL DATUM; NAVD 88. SEE NOTES SHEET FOR BENCHMARK REFERENCES.
2. DESIGN SUBJECT TO CHANGE BASED ON USACE AND ROUTT COUNTY FLOOD DEVELOPMENT PERMITTING .

FILL QUANTITIES						TOTAL VOLUME BELOW OHWM (CY)	DESCRIPTION
REACH LENGTH	LF	BELOW OHWM	CF/LF	TOTAL VOLUME (CF)	TOTAL VOLUME (CY)		
CENTERLINE	488.4						LENGTH OF EX REACH AFFECTED
BANKTONE (LEFT + RIGHT BANK)							
TOTAL LENGTH	897.4	897.4	7.1	6,343.2	234.9	234.9	ASSUMES 3-FT DIAMETER ROCK
ROCKVAE							
RV1	66.4	26.4	14.1	938.7	34.8	13.8	ASSUMES 2 LAYERS OF 3-FT DIAMETER
RV2	68.5	42.6	14.1	968.4	35.9	22.3	ROCK
RV3	61.1	41.1	14.1	863.8	32.0	21.6	
RV4	65.8	49.7	14.1	930.1	34.5	26.0	
RV5	86.5	65.4	14.1	1,222.9	45.3	34.2	
TOTAL				4,924.0	182.4	118.0	
ROOT WAD							
EACH	7		54.8	383.5	14.7	10.7	ASSUMES 6-FT DIAMETER WAD W/ 15-1/2 18-INCH DIAMETER TRUNK ASSUMES 3/4" OF ROOT WAD STRUCTURE BELOW OHWM
GRAVEL BAR							
					TOTAL VOLUME BELOW OHWM (CY)	TOTAL VOLUME DIFFERENTIAL	
CUT (CY)	FILL (CY)	NET (CY)			TOTAL (CY)		
47.62	29.2	67.7			76.8	76.8	
TOTAL PROJECT					508	440	USAC REGIONAL GENERAL PERMIT 37
					1.04	0.90	ALLOYS UP TO 2 CY/FE

[illegible]

Clark Parcels

SHEET

C.100

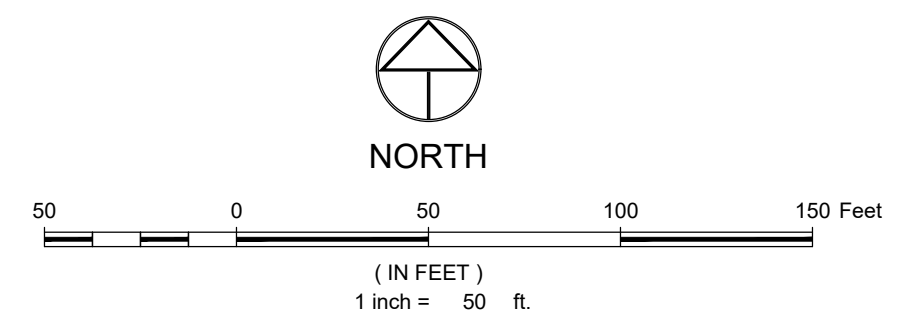
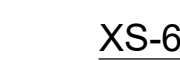
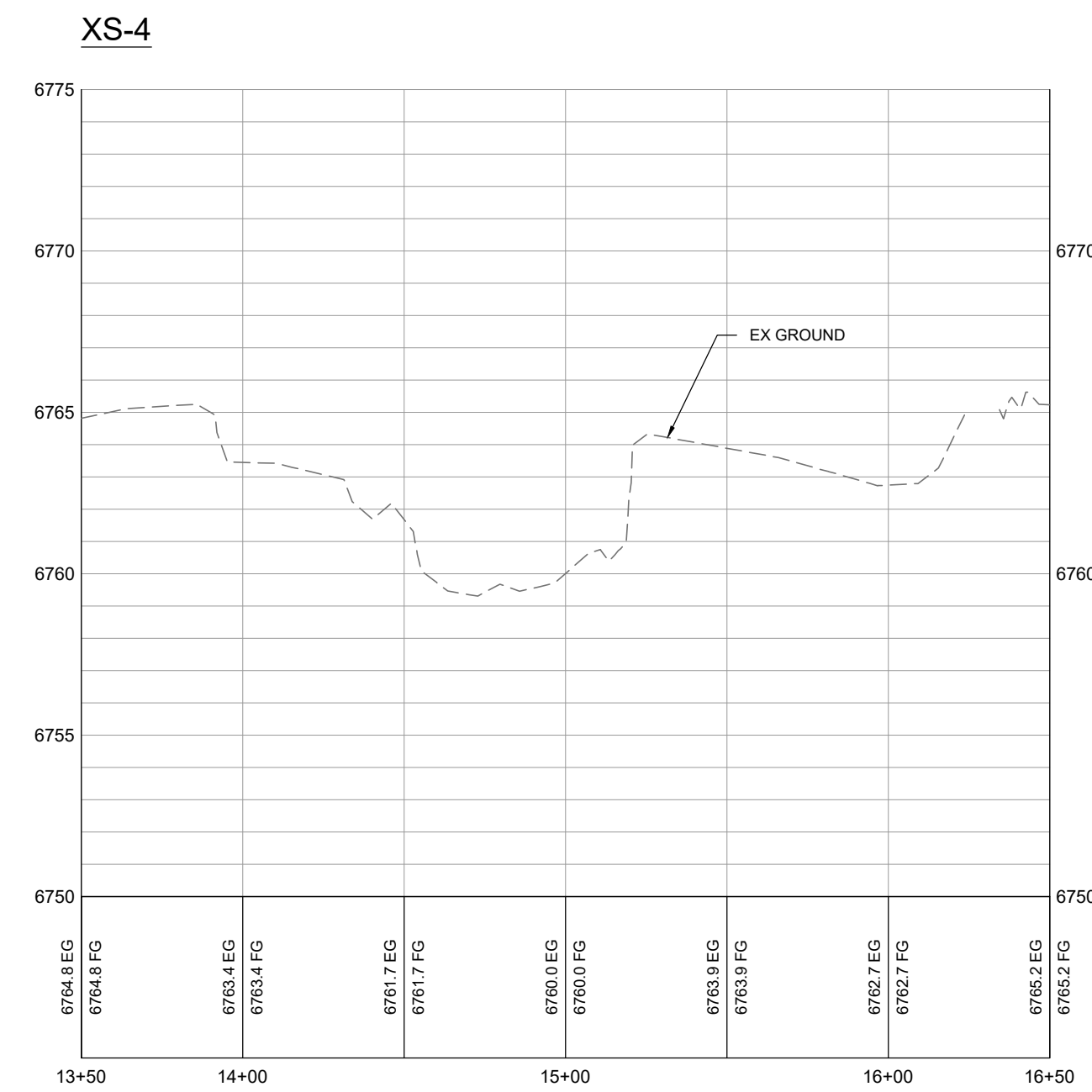
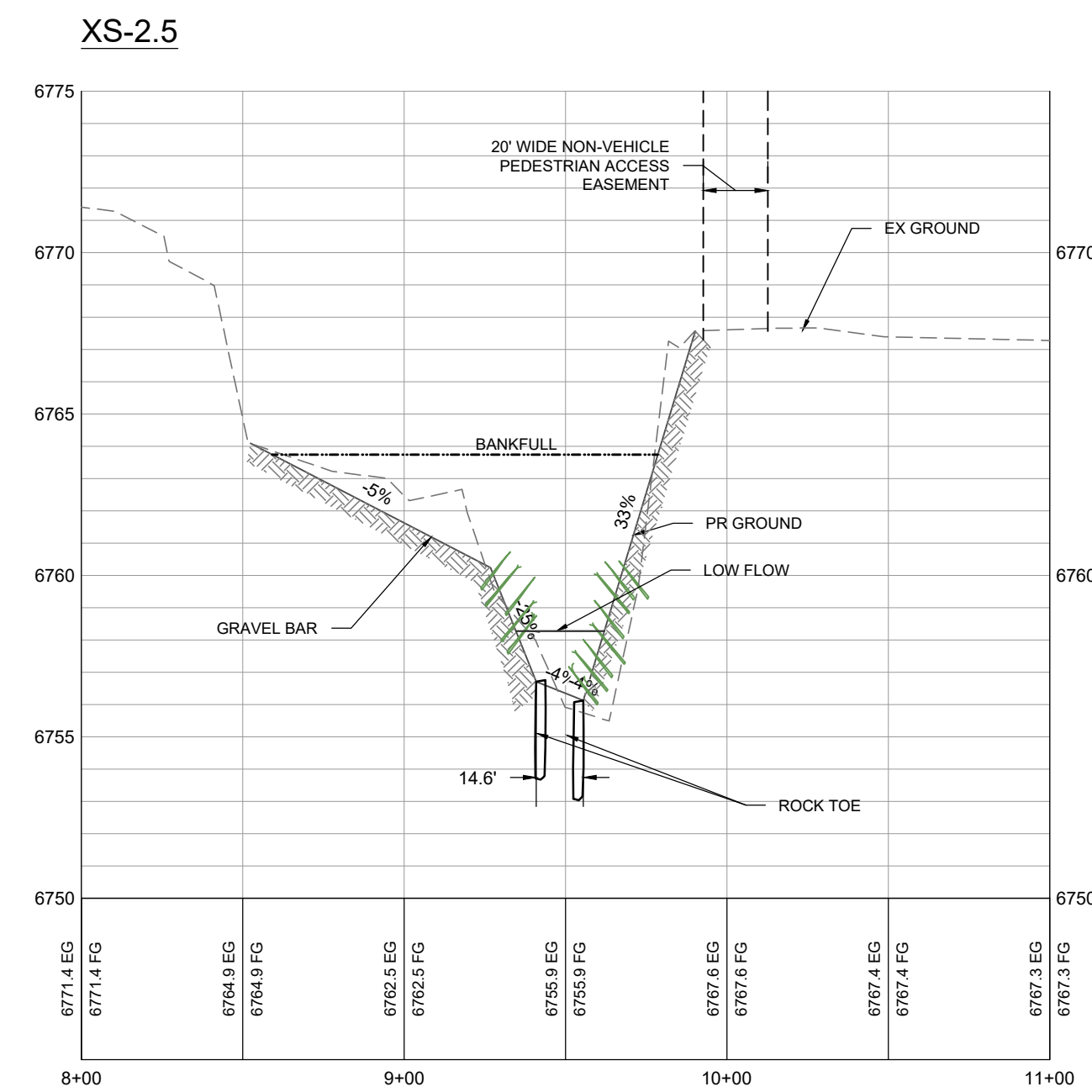
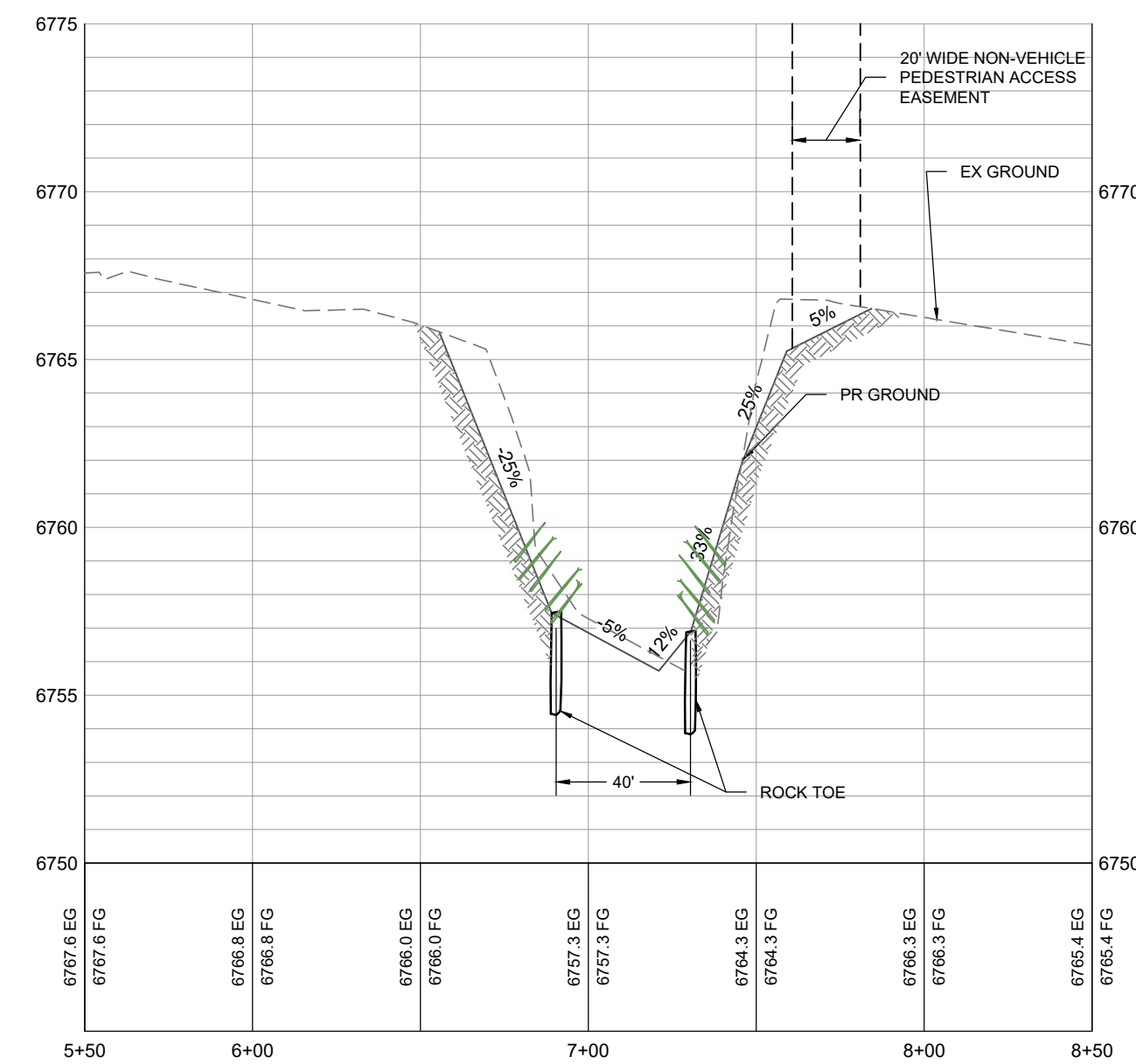
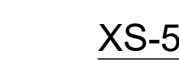
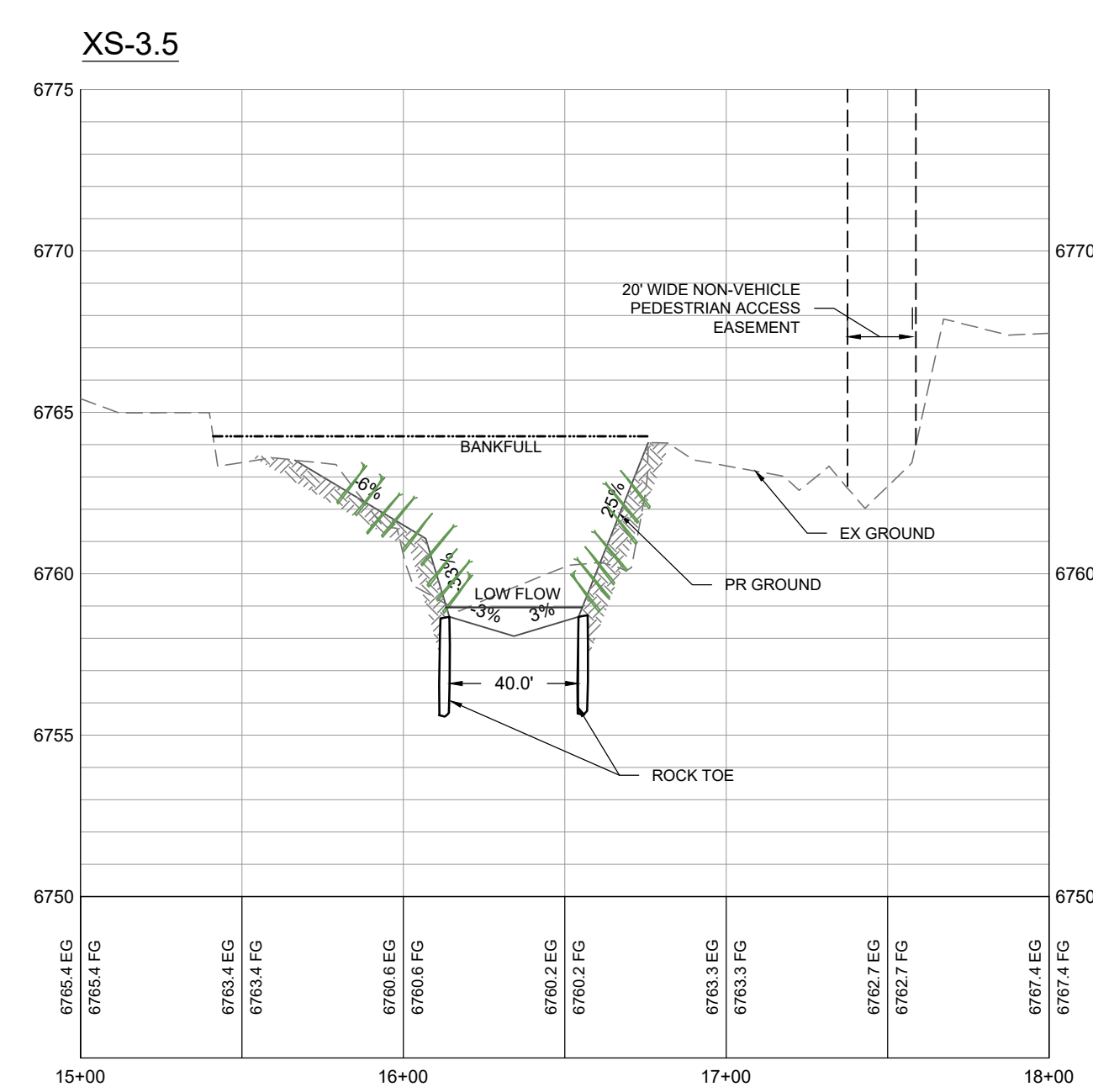
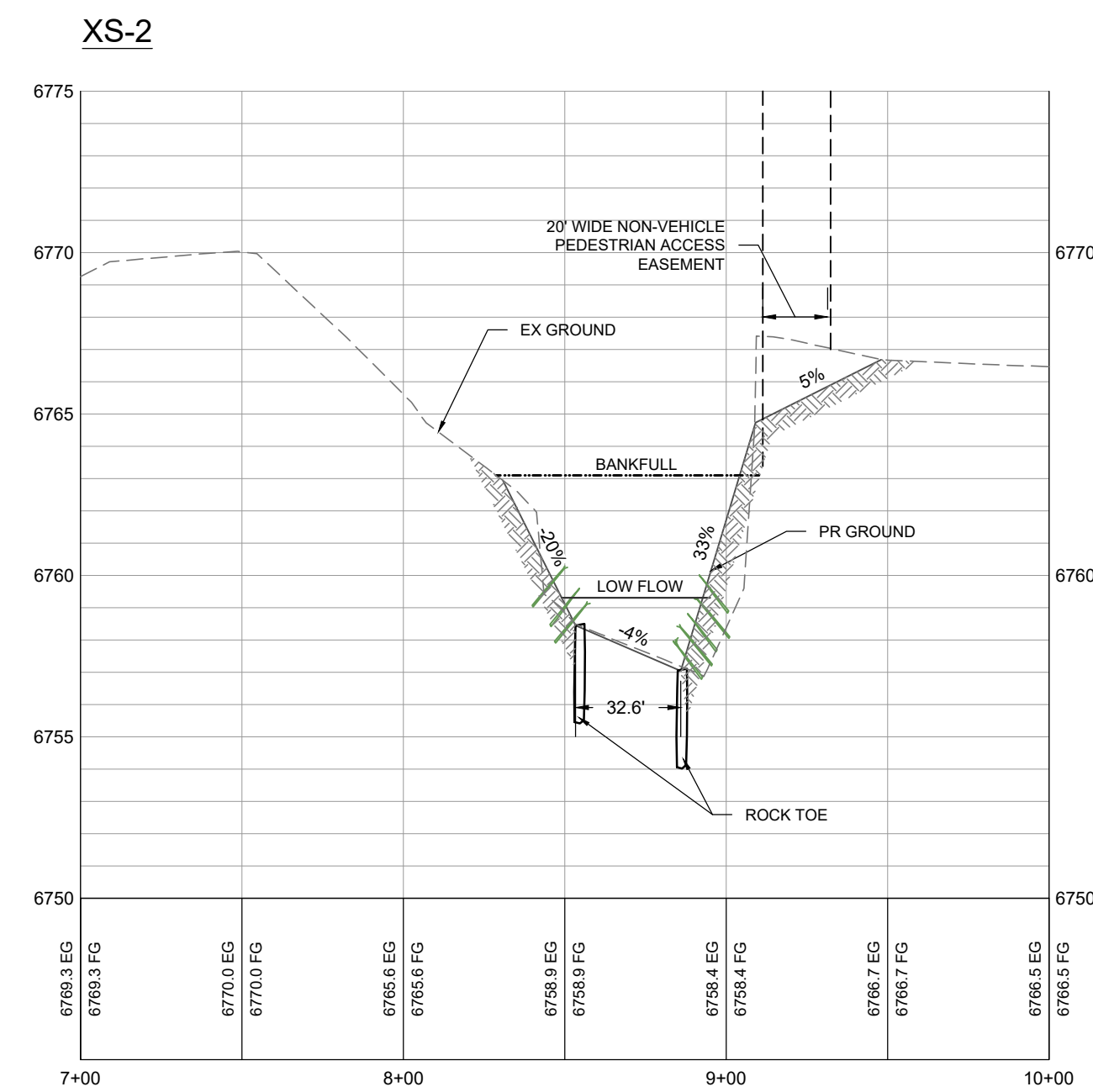
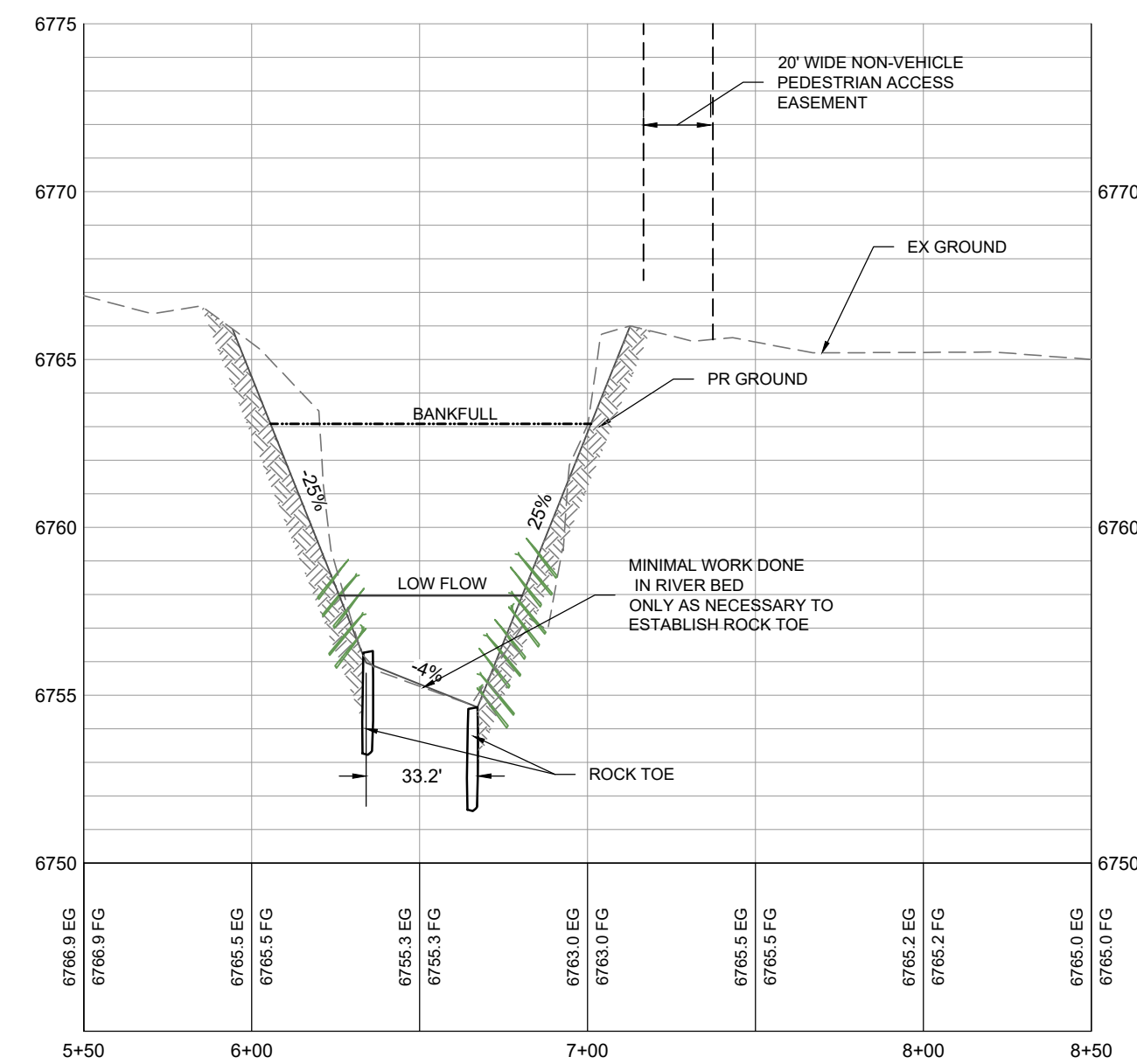
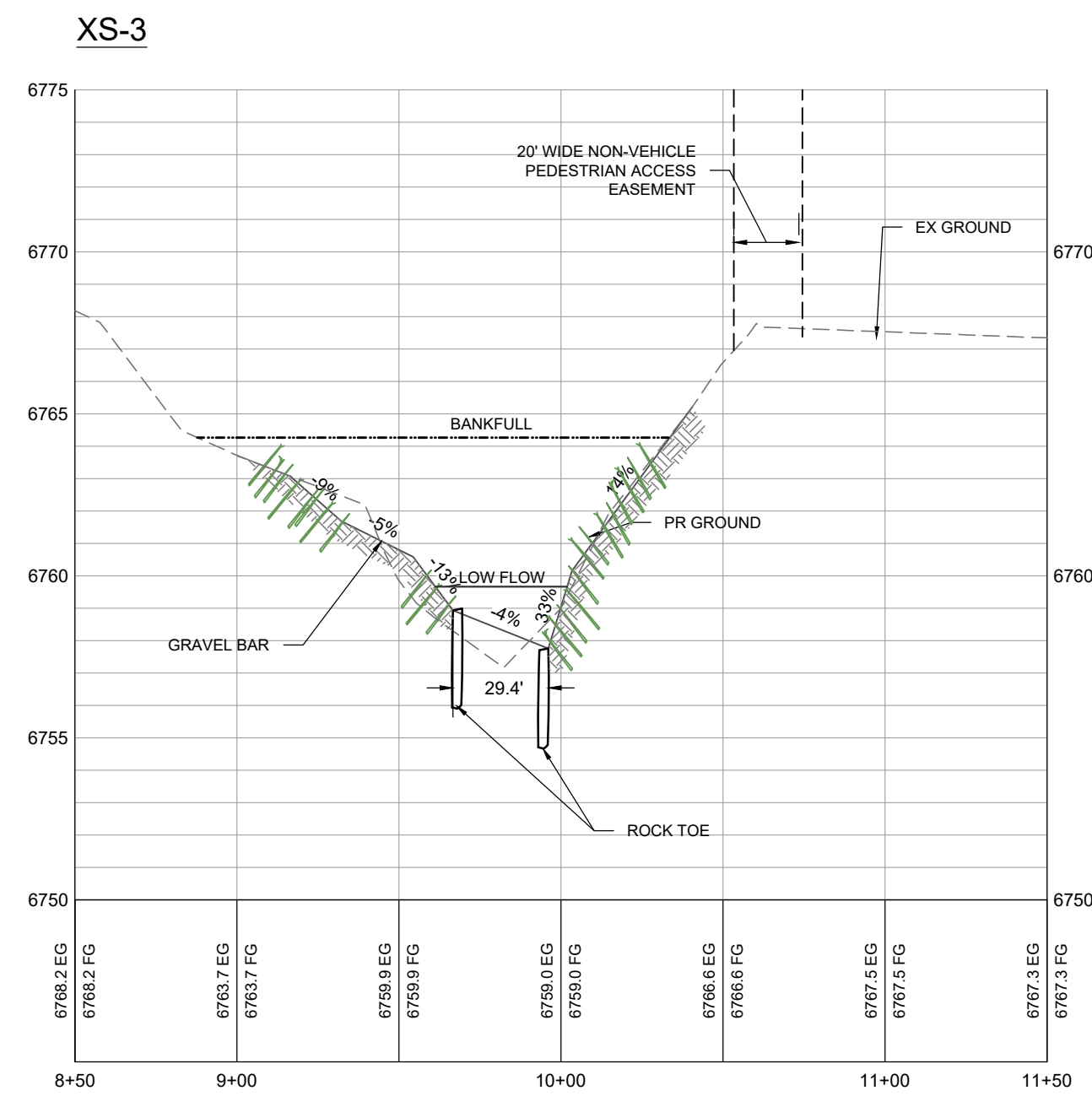
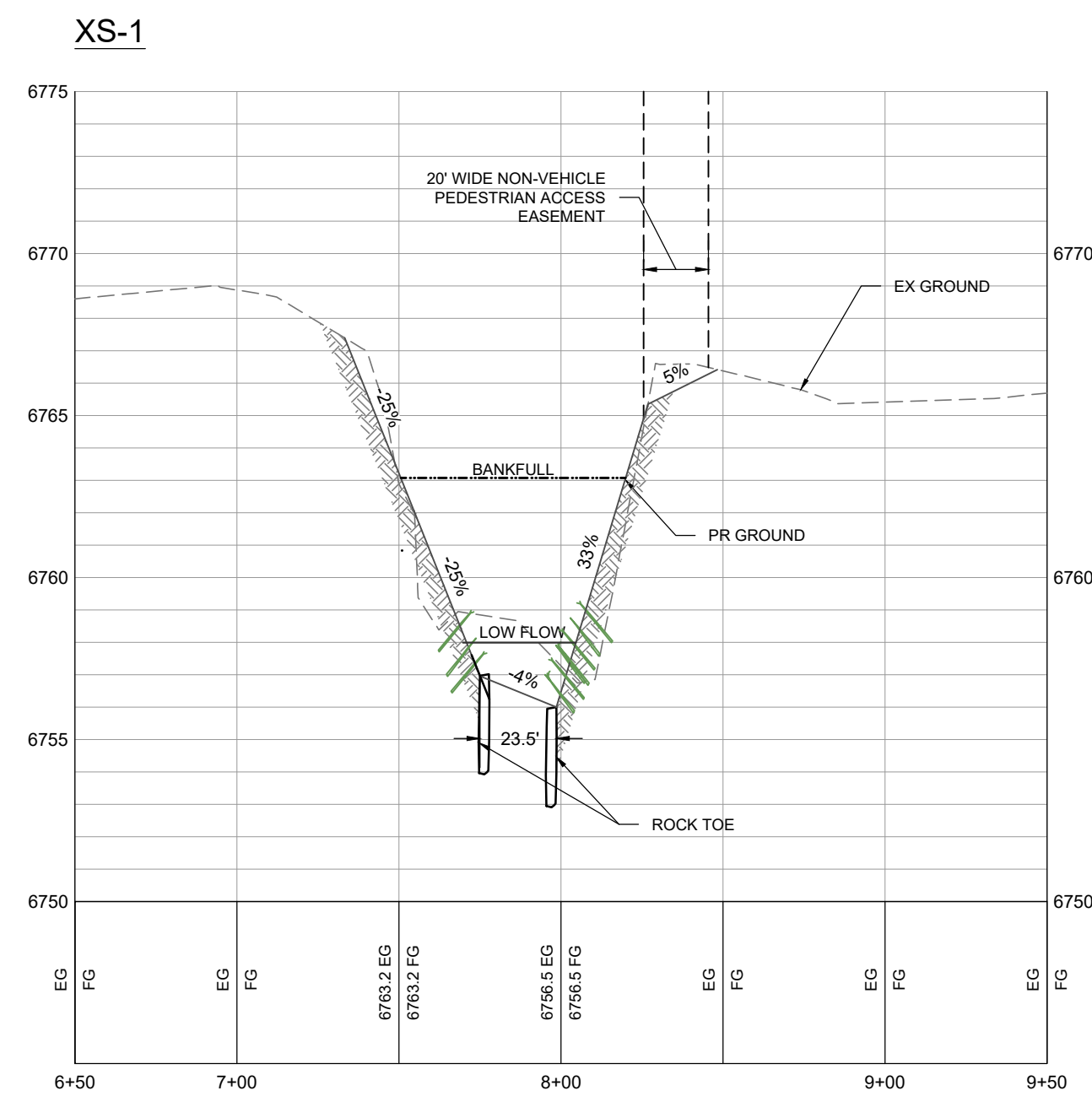
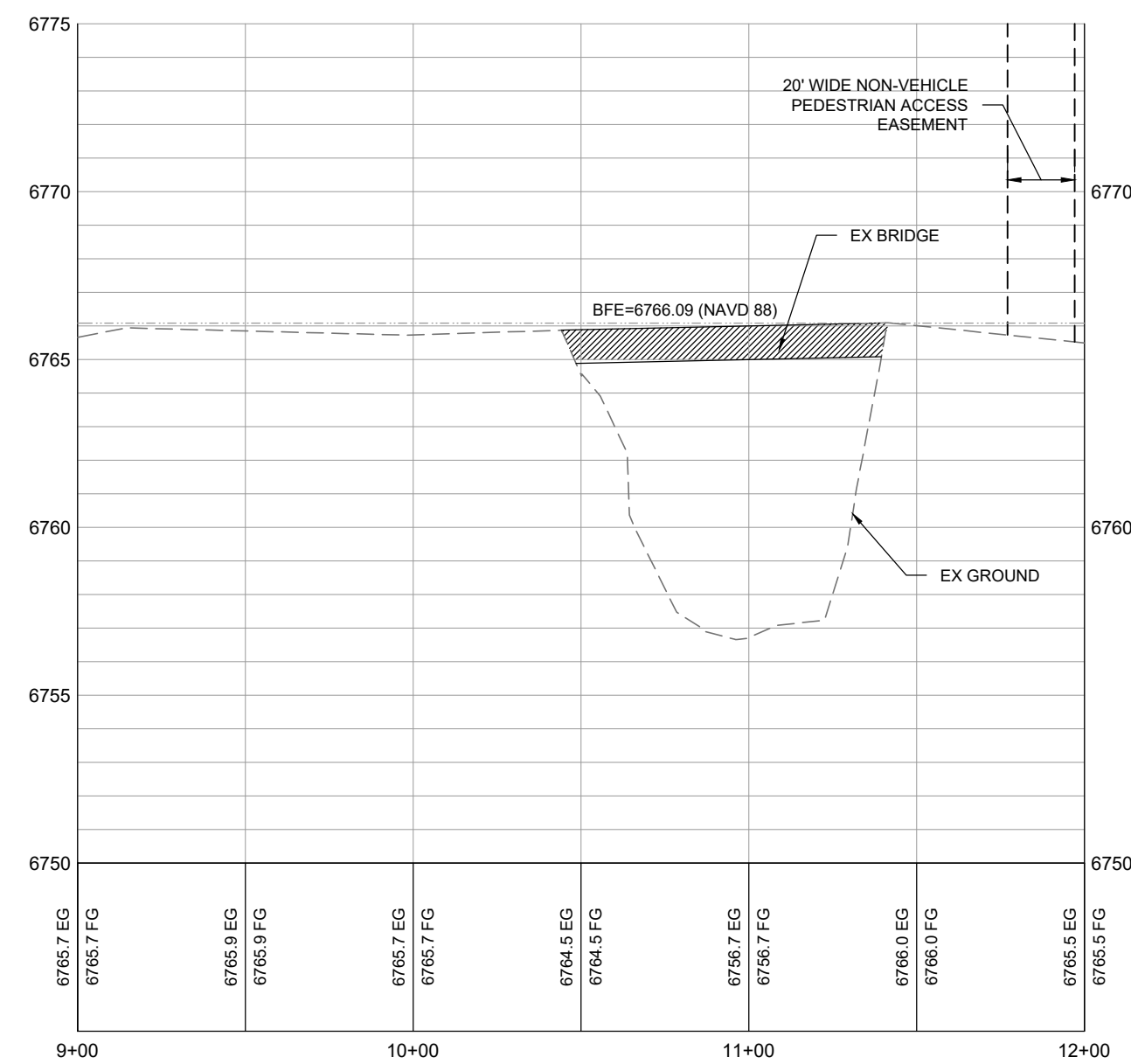

LEGEND:

BANKFULL WSEL
LOW FLOW WSEL
BASE FLOOD ELEVATION (NAVD 88)
EXISTING GROUND
PROPOSED GROUND

ROCK TOE

WILLOW PLANTING

NOTES:

1. ALL PROJECT DATA IS ON VERTICAL DATUM; NAVD 88. SEE NOTES SHEET FOR BENCHMARK REFERENCES.
2. DESIGN SUBJECT TO CHANGE BASED ON USACE AND ROUTT COUNTY FLOODPLAIN DEVELOPMENT PERMITTING .

LANDMARK
CONSULTANTS, INC.
CIVIL ENGINEERS | SURVEYORS

1411 9th Street - P.O. Box 774943, Steamboat Springs, CO 80477
(970) 871-9434 - www.LANDMARK-CO.com

These drawings are instruments of service provided by Landmark Consultants, Inc. and are not to be used for any type of construction or contracting unless signed and sealed by a Professional Engineer in the employ of Landmark Consultants, Inc.

[illegible]

PROJECT:	2545-001
DATE:	10/18/2023
CONTACT:	RYAN SPAUSTAT
EMAIL:	ryans@landmark-co.com

Clark Parcels

Yampa River Rehabilitation River Cross-Sections

SHEET

C.110

CALL UTILITY NOTIFICATION CENTER OF
COLORADO



Know what's below.
Call before you dig.

CALL 2 BUSINESS DAYS IN ADVANCE BEFORE YOU
DIG, GRADE, OR EXCAVATE FOR THE MARKING OF
UNDERGROUND MEMBER UTILITIES.



NOT VALID WITHOUT ORIGINAL
SIGNATURE AND DATE

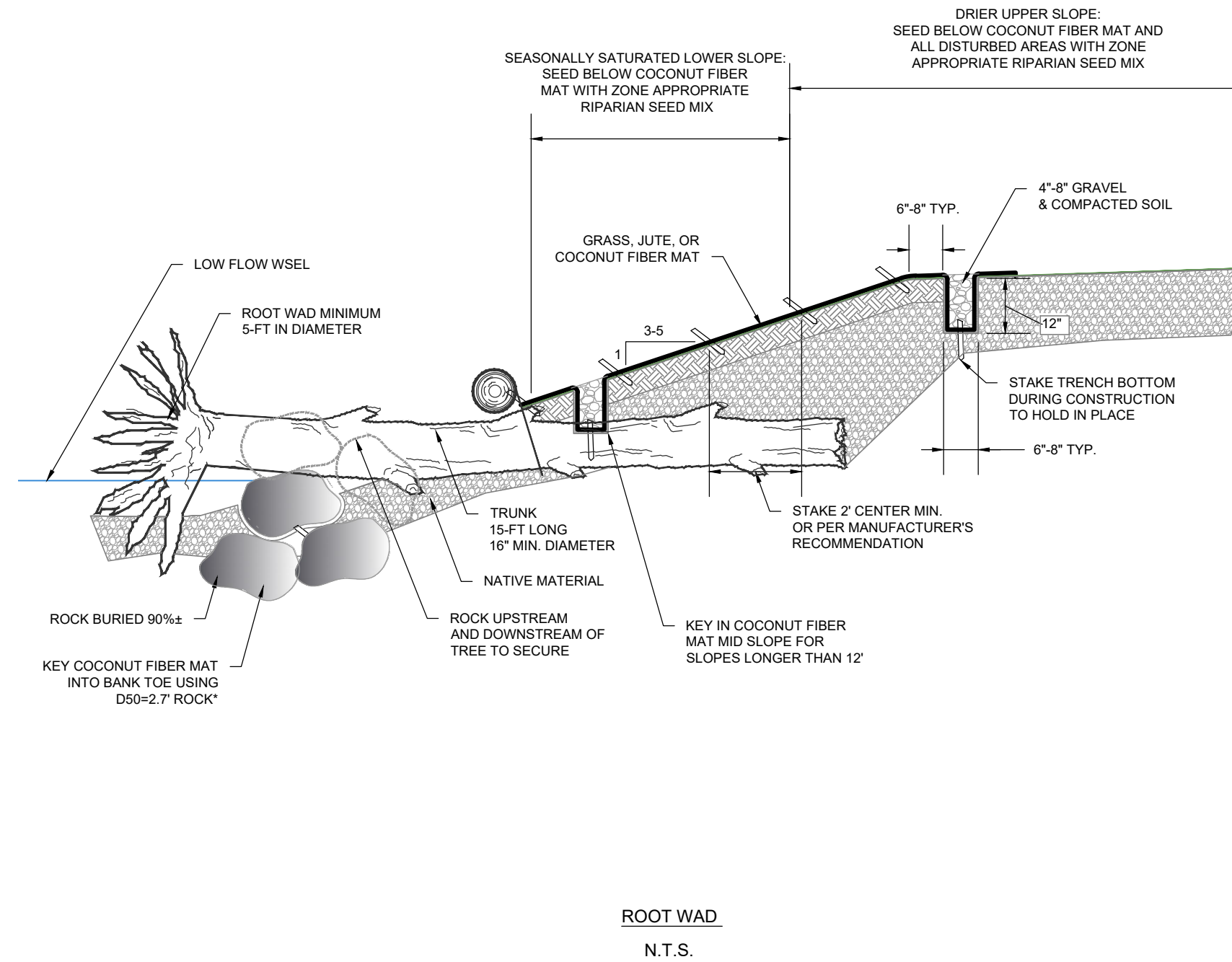
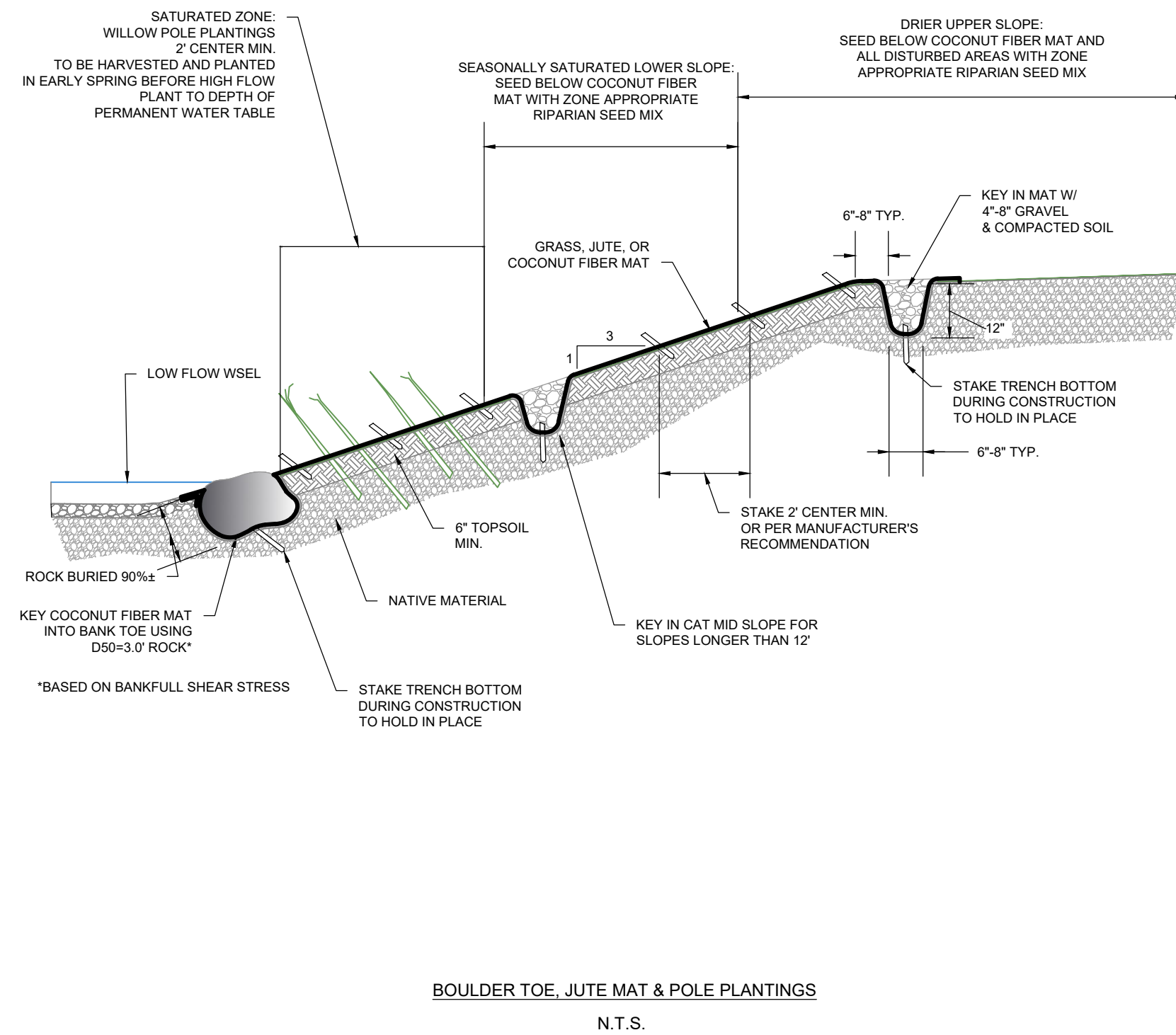

LANDMARK
CONSULTANTS, INC.
CIVIL ENGINEERS | SURVEYORS

141 9th Street - P.O. Box 774943, Steamboat Springs, CO 80477
(970) 871-9494 ~ www.LANDMARK-CO.com

These drawings are instruments of service provided by Landmark Consultants, Inc. and are not to be used for any type of construction or contracting unless signed and sealed by a Professional Engineer in the employ of Landmark Consultants, Inc.

[illegible]

PROJECT:	2545-001
DATE:	10/18/2023
CONTACT:	RYAN SPAUSTAT
EMAIL:	ryans@landmark-co.com

Clark Parcels
Yampa River Rehabilitation
Details

SHEET

C.500