

# 18-SIDED FREEDOM YURT CABIN

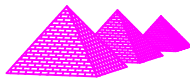

PSE  
Consulting  
Engineers,  
Inc.  
www.structure1.com  
Corporate Office  
250 Main  
Klamath Falls,  
OR 97603  
Phone: (541) 850-6300  
maverick@structure1.com

PROJECT #:  
Freedom Yurt Cabins  
224-001  
Generic  
18-Sided Cabin



FREEDOM YURT CABINS  
3200 CR100  
BUILDING 10  
FREEDOMYURTCABINS@GMAIL.COM  
(719) 362-3333

## SHEET LIST TABLE

Sheet Title	Sheet Description
A0.0	COVER SHEET
A0.1	GENERAL NOTES
A0.2	OVERALL ELEVATIONS
A1.0	FLOOR PLAN
A1.1	FLOOR FRAMING PLAN
A1.2	MOUNT BASE DETAILS
A1.3	FOOTING AND FLOOR FRAMING DETAILS
A1.4	FLOOR SHEATHING LAYOUT
A1.5	BASIC FLOOR SHEATHING TRIANGLES
A2.0	WALL UNIT DETAILS
A2.1	DOOR UNIT DETAILS
A2.2	WINDOW UNIT DETAILS
A3.0	ROOF FRAMING PLAN AND DETAILS
A3.1	ROOF HEIGHT
A3.2	ROOF DETAILS
A3.3	ROOF TRIANGLES
A3.4	RAFTER BRACKET DETAILS
A3.5	ACRYLIC DOME DETAILS

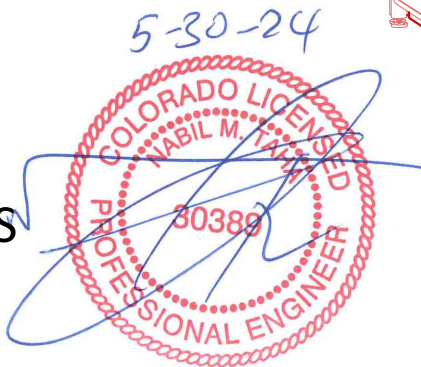

Expires 10/31/2025

Structural members only were included in  
this structural review/design. Non-structural  
members are NOT included.

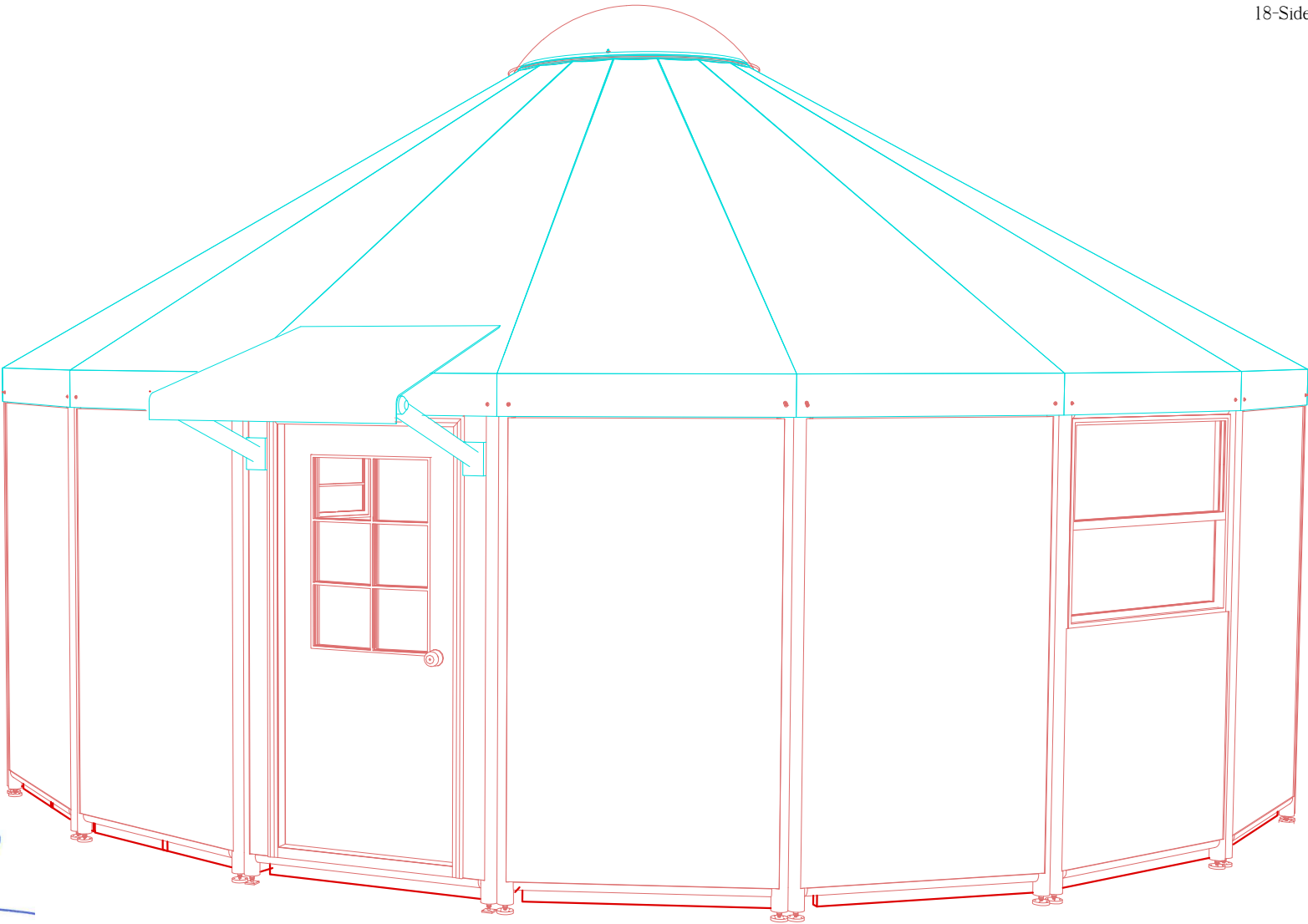

PROJECT NAME  
PROJECT LOCATION

1"  
Note: sheet is printed  
full size at 11"x17". The  
guide scale above will  
print 1" length,  
otherwise scale  
accordingly.

COVER SHEET

SCALE: NONE

A0.0

A. GENERAL NOTES

- 1. Dimensions shall take precedence over scales shown on the drawings. Do not scale drawings.
- 2. Notes and details shall take precedence over general notes and typical details.
- 3. Openings, chases, trenches, holes, notches, etc.. shall not be placed in beams, joists, columns, bearing or shear walls, unless specifically detailed or noted on the drawings.
- 4. The structure shown within this drawing set is a prefabricated system meant to be shown in separate instruction. Any omission or change to the system shown on these drawings shall be done at the risk of the owner.

B. STRUCTURAL NOTES

- 1. Lumber
  - a. Dimensional lumber shall be new Hem-Fir (19% maximum moisture content), "No. 2" grade, with minimum Fb=935 psi, & E=1,300,000 psi
  - b. Dimensional lumber joists shall be pressure treated and kiln dried (KDAT)
  - c. Roof rafters shall be 4" Ø Round Douglas Fir with 19% maximum moisture content, Fb = 2050, E=1,500,000 psi
  - c. Wall Headers shall be 3" Ø Round Lodgepole Pine with 19% maximum moisture content, Fb = 1500, E=1,100,000 psi
  - d. Wall studs shall be 3" Ø Round Lodgepole Pine with 19% maximum moisture content, Fb = 1250, E=1,100,000 psi
- 2. Plywood and Oriented Strand Board
  - a. Sheathing for walls shall be 12/32 inch, LP Smartside Structural Panel, type C-D, rated (ps-1 or equivalent), exposure 1 or equivalent.
  - b. Sheathing for roofs shall be 19/32 inch, APA 24/16, type A-C, rated (ps-1 or equivalent), exposure 1 or equivalent.
  - c. Sheathing for floors shall be 23/32 inch, APA 48/24, type A-C, rated (ps-1 or equivalent), exposure 1 or equivalent.
- 3. Foundation Bearing values
  - a. A code minimum soil bearing value of 1,500 psf has been assumed.
- 4. Site Preparation:
  - a. Scrub all organic material and remove all loose soil from underneath all proposed pads and footings. Sub-grade shall be competent, undisturbed soil.
  - b. All loose sub-grade beneath the bottom of footings shall be removed and replaced with approved fill material, if necessary.
- 5. Compacted Fill
  - a. All fill and backfill shall be placed in uniform lifts of 10" or less and be of suitable thickness for the compaction equipment selected, and moisture conditioned to within 2 percent of optimum.
  - b. Site grading shall be developed and maintained during and after construction to rapidly drain surface and roof runoff away from foundation and sub-grade soils. Downspouts from roof drains shall be discharged at least 10 feet from the building, and landscape irrigation should not be placed within 10 feet of the building.
- 6. Exterior Grade
  - a. New slope paved drive-ways and walk-ways shall have a minimum slope of 1/4:12 away from the building.

C. DESIGN CRITERIA

- 5. All design, material, and construction work for this project shall conform to the 2021 International Building Code (IBC).
- 6. Design parameters.
  - a. Floor Live Load = 40 psf.
  - b. Floor Dead Load = 15 psf.
  - c. Roof Live Load = n/a.
  - d. Roof Dead load = 10 psf.
  - e. Ground Snow Load, Pg = 90 psf.
  - f. Flat Roof Snow load = 63 psf
  - g. Sloped Roof Snow load = 38.5 psf (7:12 pitch)
  - h. Snow Exposure Factor, Ce = 1.0
  - i. Snow Load Importance Factor, I = 1.0
  - j. Thermal Factor, Ct = 1.0
  - k. Basic Wind Speed (3 second gust) = 115 mph
  - l. Wind Importance Factor, Iw = 1.00
  - m. Wind Exposure = C
  - n.Internal Pressure Coefficient = 0.18
  - o. Components and Cladding studs = N.A
  - p. Seismic Importance Factor, Ie = 1.0
  - q. Ss = 1.5
  - r. S1 = 0.75
  - s. Site Class = D
  - t. Seismic Design Category = D
  - u. Response Modification Factor, R = 3.0
  - v. Analysis Procedure Used = Equivalent Lateral Force Procedure

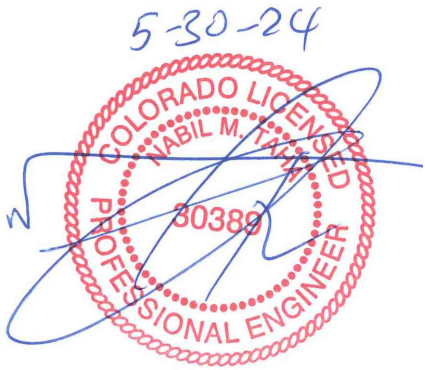

Expires 10/31/2025

Structural members only were included in this structural review/design. Non-structural members are NOT included.



PROJECT NAME  
PROJECT LOCATION

1"  
Note: sheet is printed full size at 11"x17". The guide scale above will print 1" length, otherwise scale accordingly.

GENERAL NOTES

  
PSE  
Consulting  
Engineers,  
Inc.  
www.structure1.com  
Corporate Office  
250 Main  
Klamath Falls,  
OR 97603  
Phone: (541) 850-6300  
maverick@structure1.com  
PROJECT #:  
Freedom Yurt Cabins  
224-001  
Generic  
18-Sided Cabin

SCALE: NONE

A0.1

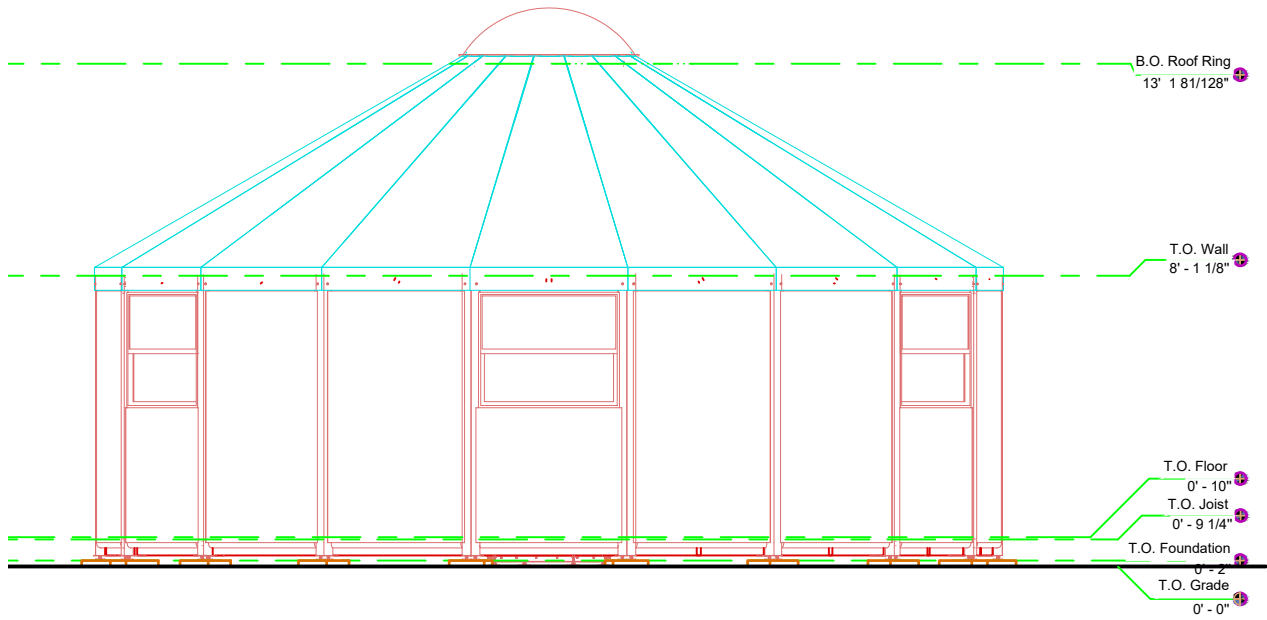

① ELEVATION - WINDOW WALL  
1/4" = 1'-0"

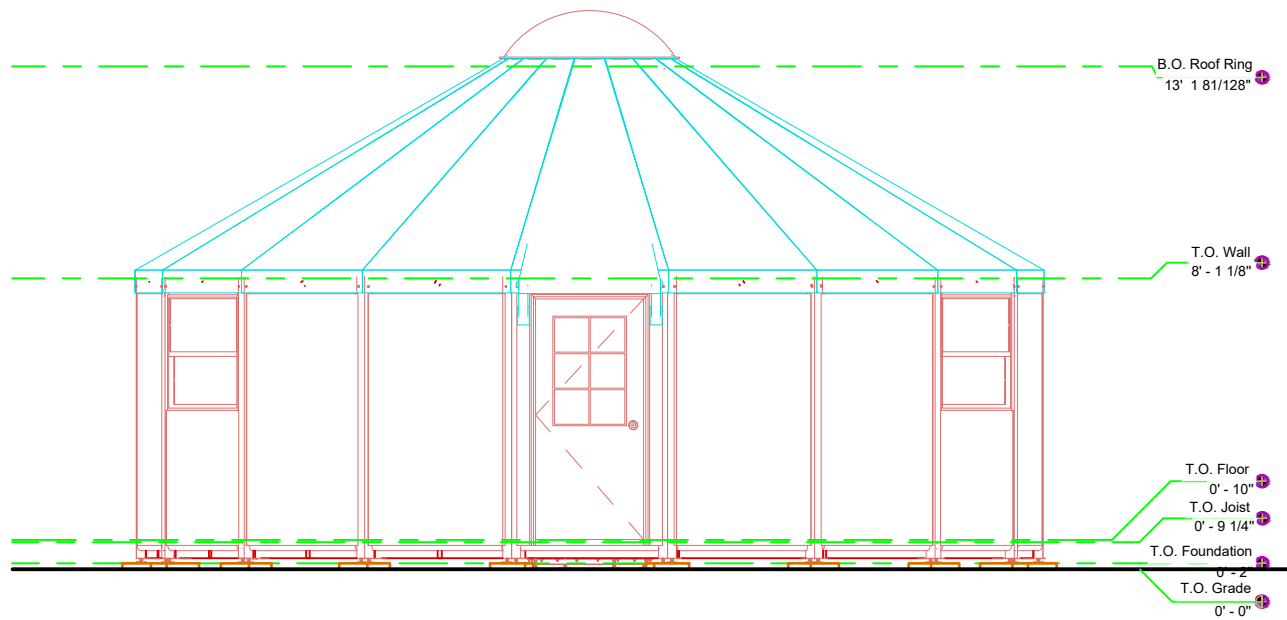

② ELEVATION - DOOR WALL  
1/4" = 1'-0"

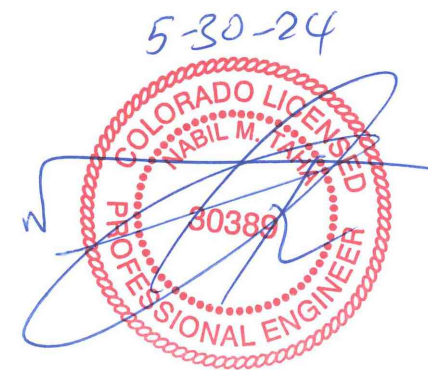

Expires 10/31/2025

Structural members only were included in this structural review/design. Non-structural members are NOT included.

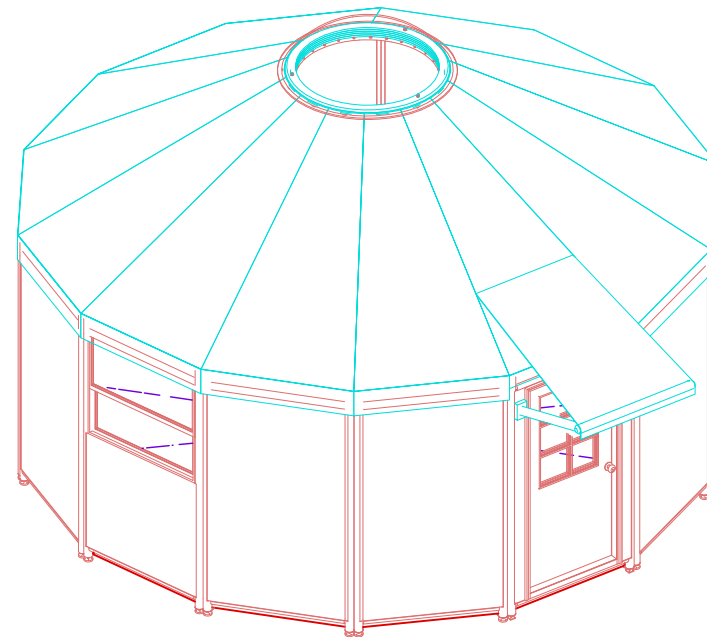

③ AXONOMETRIC VIEW

PROJECT NAME  
PROJECT LOCATION

1"  
Note: sheet is printed full size at 11"x17". The guide scale above will print 1" length, otherwise scale accordingly.

OVERALL ELEVATIONS

SCALE: AS SHOWN

A0.2

PSE  
Consulting Engineers, Inc.  
www.structure1.com  
Corporate Office  
250 Main  
Klamath Falls, OR 97603  
Phone: (541) 850-6300  
maverick@structure1.com  
PROJECT #:  
Freedom Yurt Cabins  
224-001  
Generic  
18-Sided Cabin

FREEDOM YURT CABINS  
3200 CR100  
BUILDING 10  
FREEDOMYURTCABINS@GMAIL.COM  
(719) 362-3333

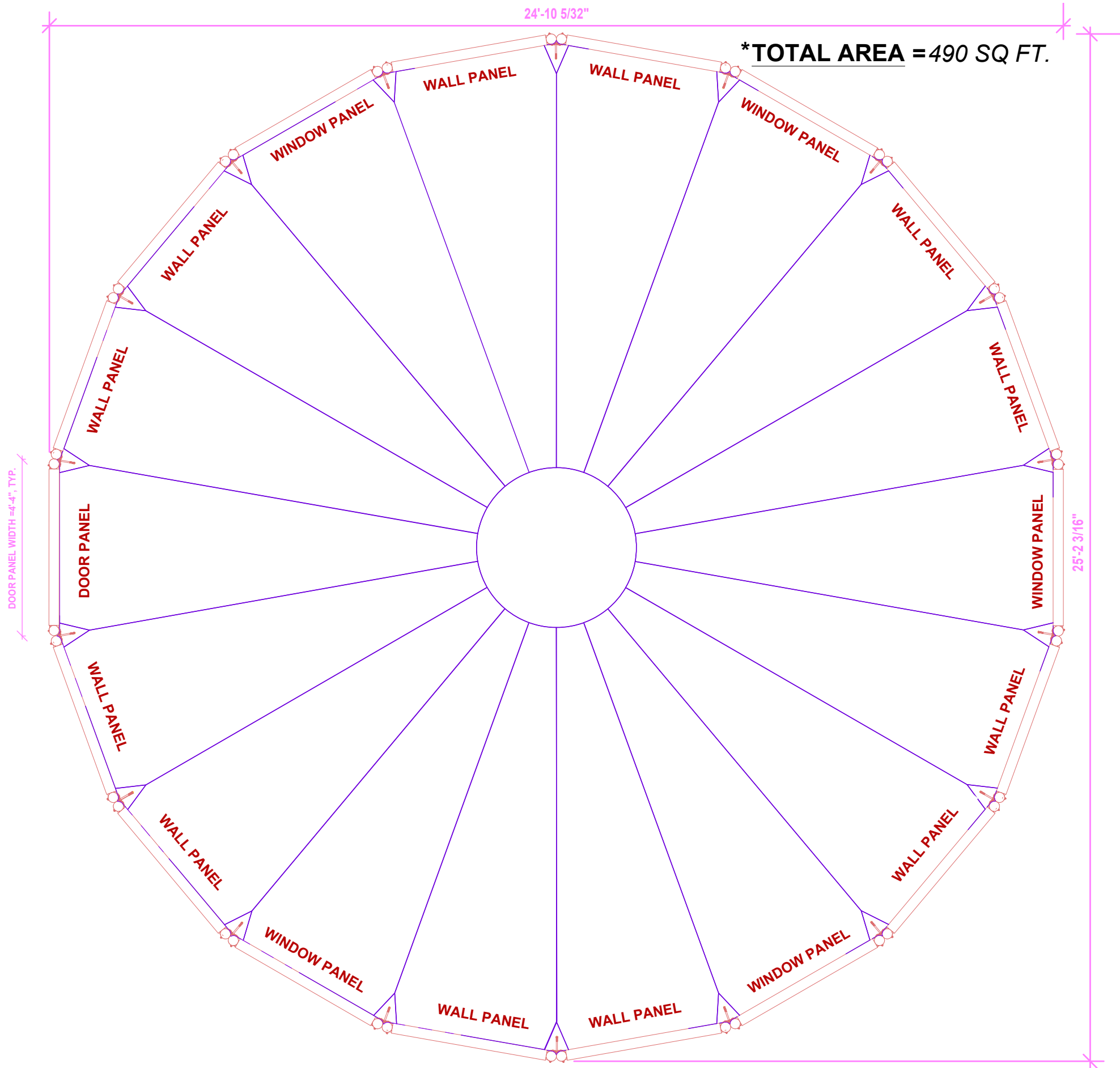

③ FLOOR PLAN  
3/8" = 1'-0"

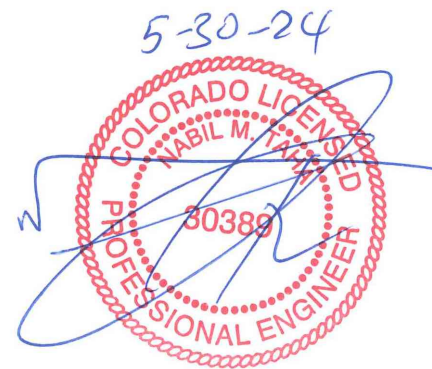

Expires 10/31/2025

Structural members only were included in  
this structural review/design. Non-structural  
members are NOT included.



PSE  
Consulting  
Engineers,  
Inc.

www.structure1.com  
Corporate Office  
250 Main  
Klamath Falls,  
OR 97603  
Phone: (541) 850-6300  
maverick@structure1.com

PROJECT #:  
Freedom Yurt Cabins  
224-001  
Generic  
18-Sided Cabin



FREEDOM YURT CABINS  
3200 CR100  
BUILDING 10  
FREEDOMYURTCABINS@GMAIL.COM  
(719) 362-3333

PROJECT NAME  
PROJECT LOCATION

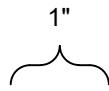

Note: sheet is printed  
full size at 11"x17". The  
guide scale above will  
print 1" length,  
otherwise scale  
accordingly.

FLOOR PLAN

SCALE: 3/8" = 1'-0"

A1.0



FACE-TYPE LUS26-2 SIMPSON  
JOISTS HANGERS @  
MID SPAN, TYP.

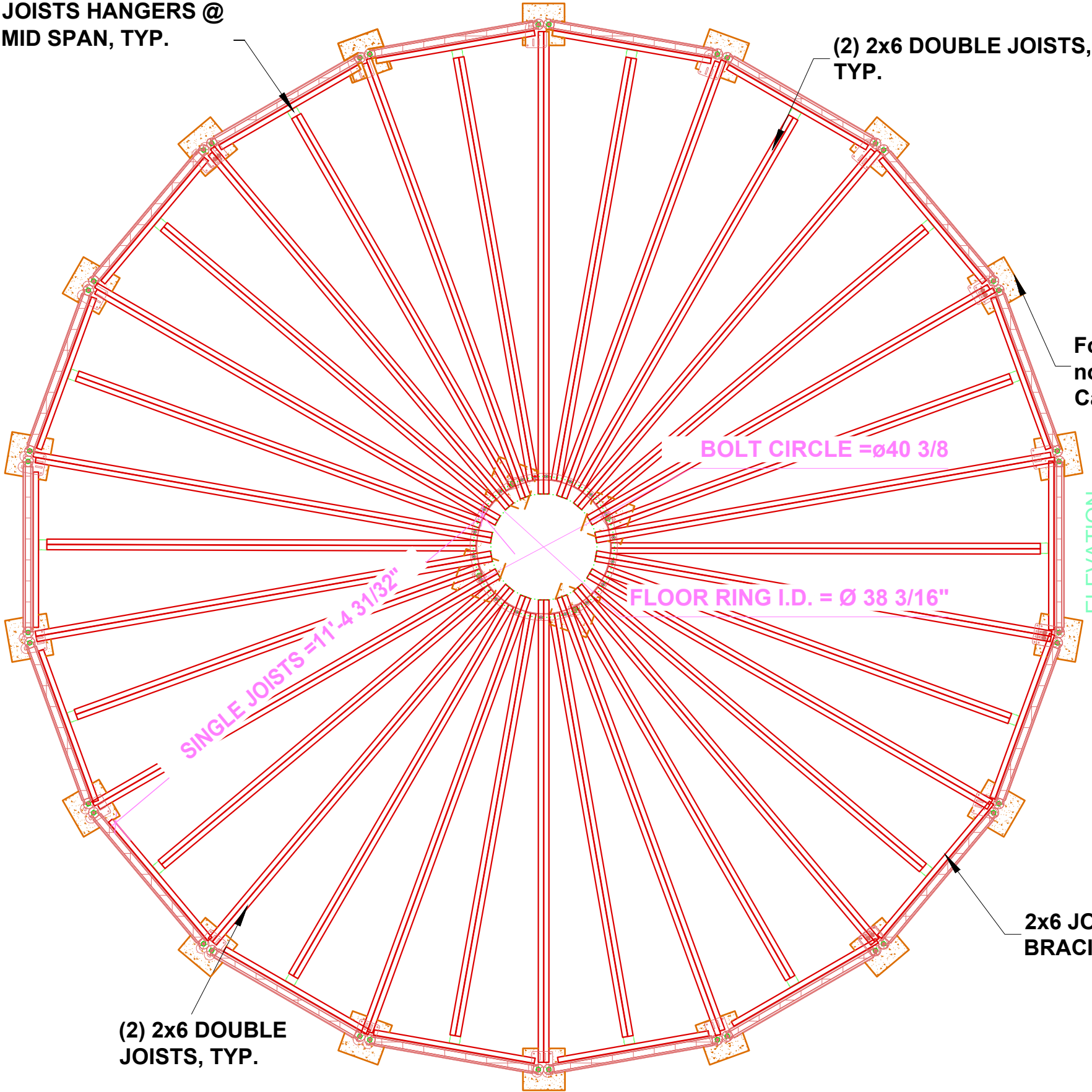

Center Floor Ring (Inside Diameter) = 38 3/16"

Bolt Ring Diameter (28 Holes) = 40 3/8"

Double Joists (Total Length) = 11' - 0

Distance from the Center Support Ring Hole to the middle of  
the Joist Bracket Slot = 10' - 5

(2) 2x6 DOUBLE JOISTS,  
TYP.

Foundation by others  
not by Freedom Yurt  
Cabins or PSE

BOLT CIRCLE = Ø40 3/8

FLOOR RING I.D. = Ø 38 3/16"

SINGLE JOISTS = 11' - 4 31/32"

ELEVATION -  
WINDOW  
WALL

1 A2.0  
/2.1

5-30-24



Expires 10/31/2025

Structural members only were included in  
this structural review/design. Non-structural  
members are NOT included.

PSE  
Consulting  
Engineers,  
Inc.  
www.structure1.com  
Corporate Office  
250 Main  
Klamath Falls,  
OR 97603  
Phone: (541) 850-6300  
maverick@structure1.com  
PROJECT #:  
Freedom Yurt Cabins  
224-001  
Generic  
18-Sided Cabin

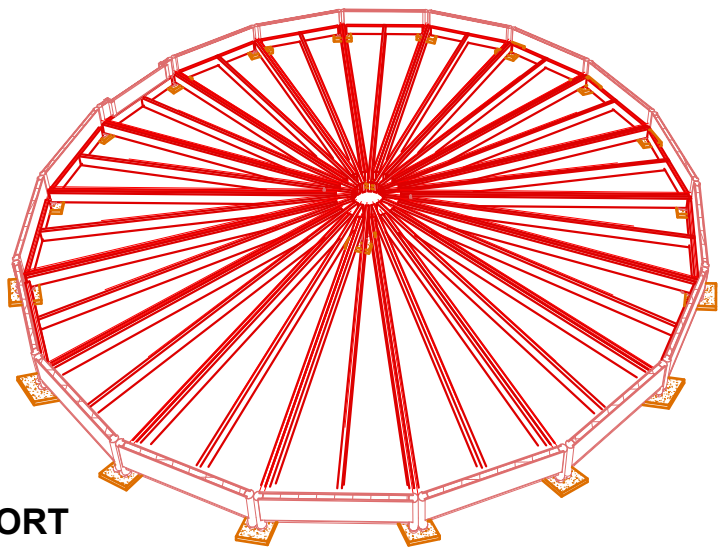

2 FLOOR FRAMING ASIONOMETRIC VIEW

1 FLOOR FRAMING PLAN  
3/8" = 1'-0"

SCALE: AS SHOWN

PROJECT NAME  
PROJECT LOCATION

1"  
Note: sheet is printed  
full size at 11"x17". The  
guide scale above will  
print 1" length,  
otherwise scale  
accordingly.

FLOOR FRAMING  
PLAN

A1.1

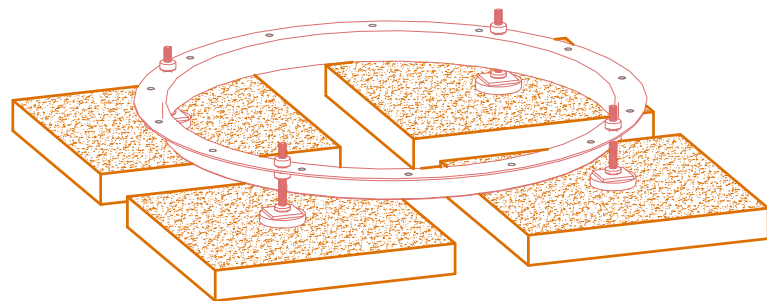

1 CENTER RING AXONOMETRIC (WITHOUT JOISTS)

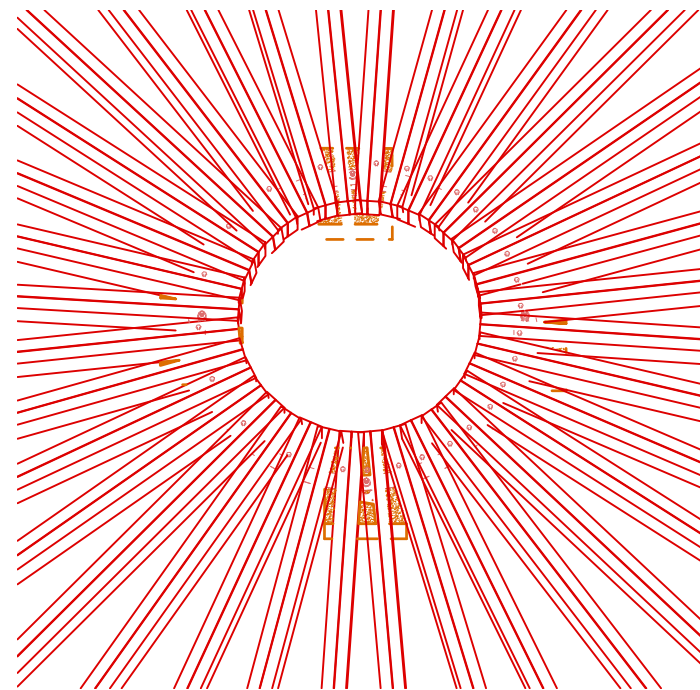

2 CENTER RING AXONOMETRIC



Expires 10/31/2025

Structural members only were included in this structural review/design. Non-structural members are NOT included.

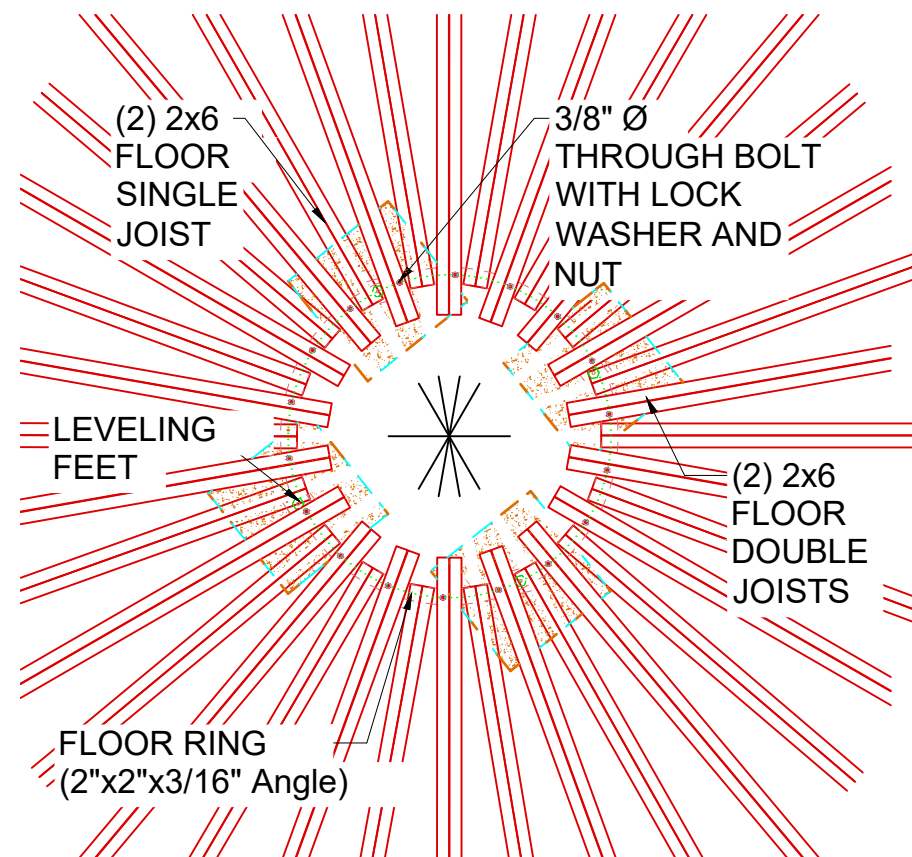

3 CENTER RING (PLAN VIEW)

PSE  
Consulting  
Engineers,  
Inc.  
www.structure1.com  
Corporate Office  
250 Main  
Klamath Falls,  
OR 97603  
Phone: (541) 850-6300  
naverick@structure1.com  
PROJECT #:  
Freedom Yurt  
Cabins 224-001  
Generic  
18-Sided Cabin



PROJECT NAME  
PROJECT LOCATION

1"  
Note: sheet is printed  
full size at 11"x17". The  
guide scale above will  
print 1" length,  
otherwise scale  
accordingly.

MOUNT BASE  
DETAILS

SCALE: AS SHOWN

A1.2



1 JOIST BRACKETS (PLAN VIEW)  
3" = 1'-0"

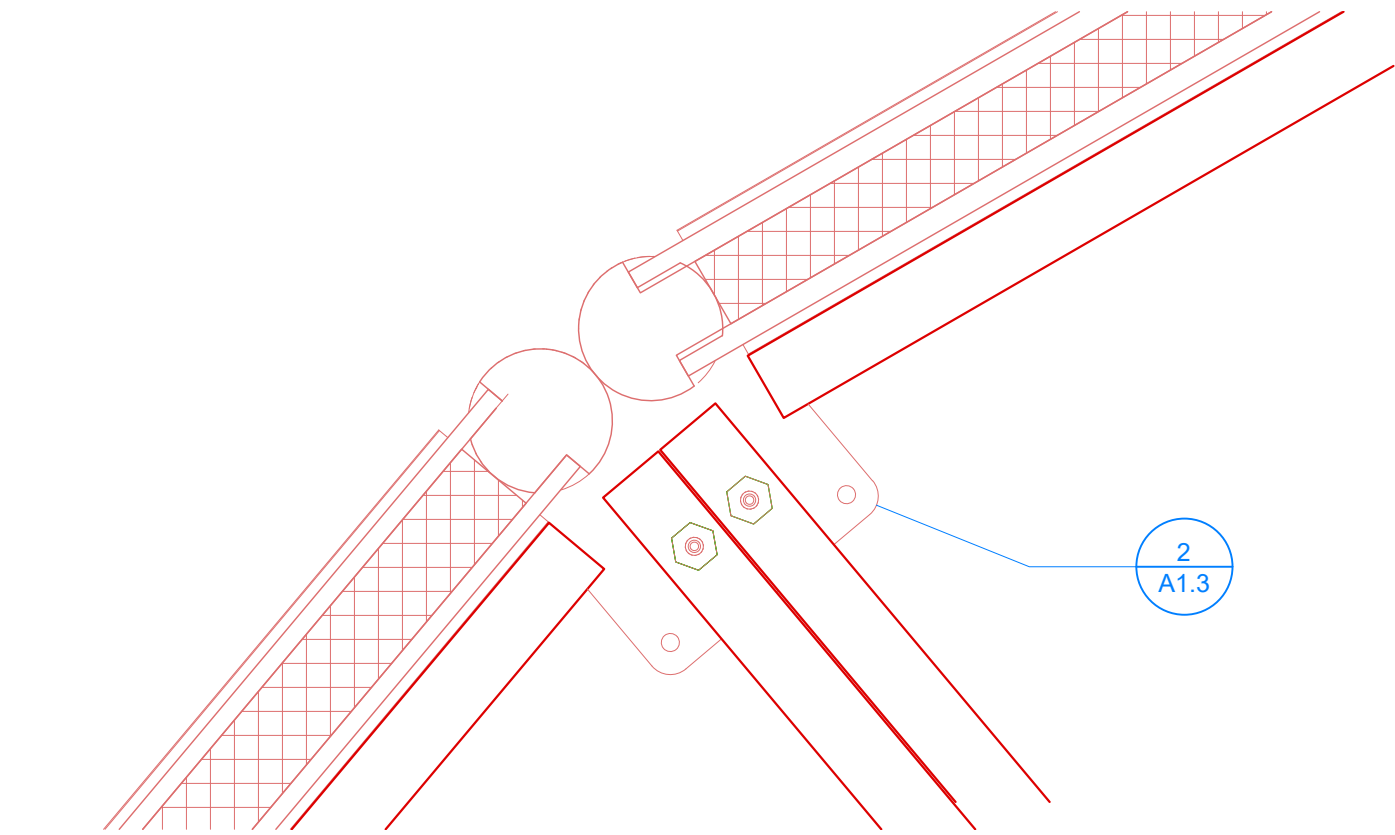

2 FLOOR JOIST BRACKETS

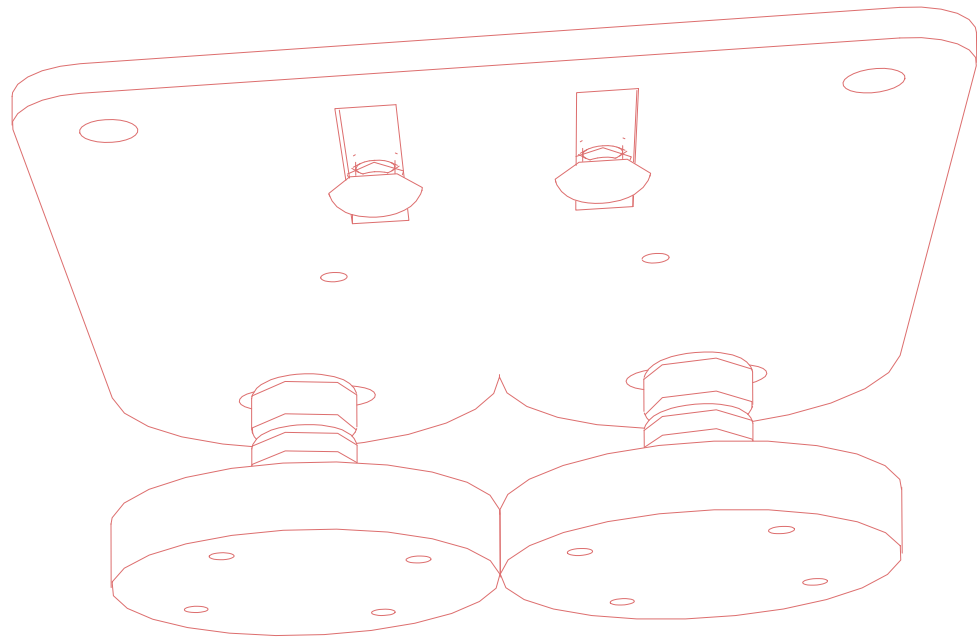

3 FLOOR SECTION  
1/16" = 1'-0"

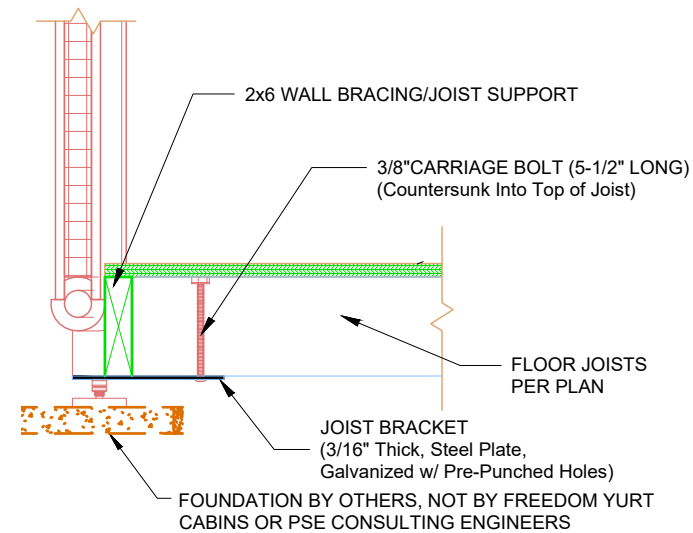
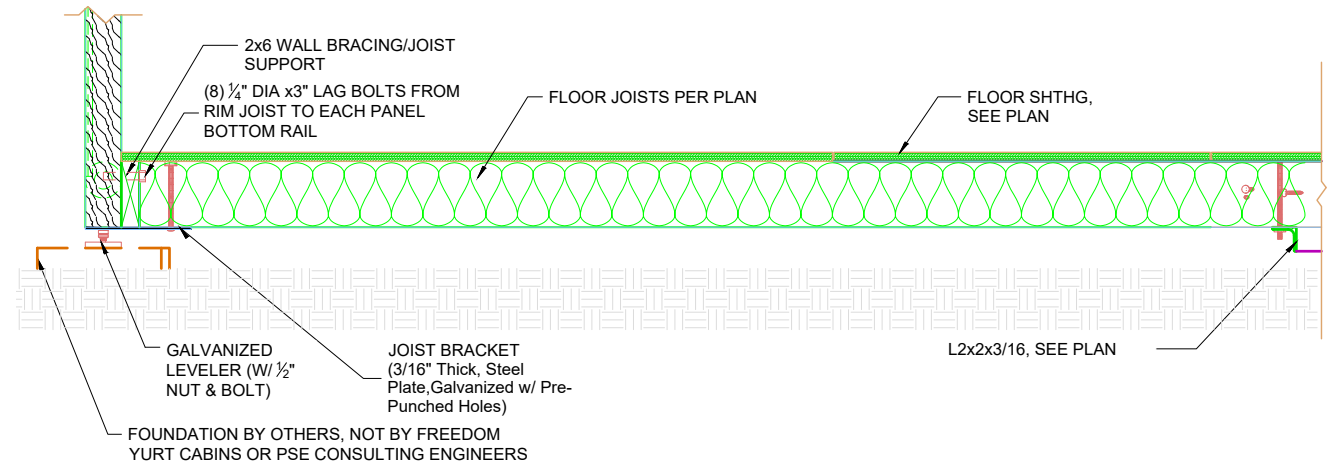

4 LEVEL/ FRAMING SUPPORT - ELEVATION  
1/32" = 1'-0"

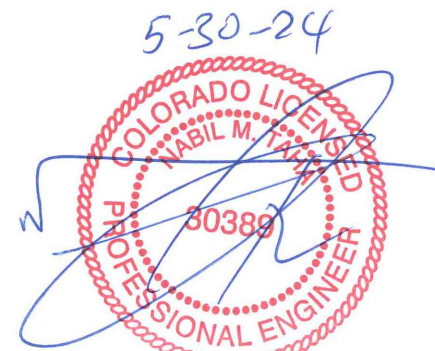

Expires 10/31/2025  
Structural members only were included in this structural review/design. Non-structural members are NOT included.

  
**PSE Consulting Engineers, Inc.**  
www.structure1.com  
Corporate Office  
250 Main  
Klamath Falls, OR 97603  
Phone: (541) 850-6300  
maverick@structure1.com  
PROJECT #:  
Freedom Yurt Cabins 224-001  
Generic  
18-Sided Cabin

SCALE:AS SHOWN

PROJECT NAME  
PROJECT LOCATION

1"  
Note: sheet is printed full size at 11"x17". The guide scale above will print 1" length, otherwise scale accordingly.

FOOTING AND FLOOR FRAMING DETAILS

A1.3

  
FREEDOM YURT CABINS  
3200 CR100  
BUILDING 10  
FREEDOMYURTCABINS@GMAIL.COM  
(719) 362-3333

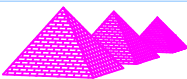

PSE  
Consulting  
Engineers,  
Inc.

www.structure1.com  
Corporate Office  
250 Main  
Klamath Falls,  
OR 97603  
Phone: (541) 850-6300  
maverick@structure1.com

PROJECT #:  
Freedom Yurt  
Cabins 224-001  
Generic  
18-Sided Cabin



FREEDOM YURT CABINS  
3200 CR100  
BUILDING 10  
FREEDOMYURTCABINS@GMAIL.COM  
(719) 362-3333

**\*3/4" FLOOR SHEATHING, TYP.**

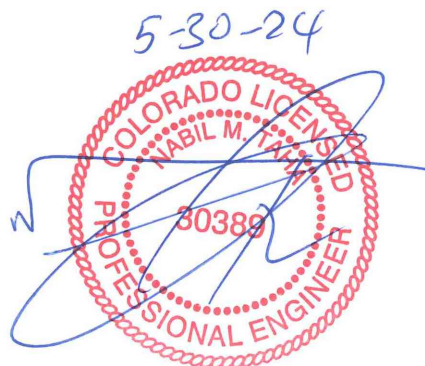

Expires 10/31/2025

Structural members only were included in  
this structural review/design. Non-structural  
members are NOT included.

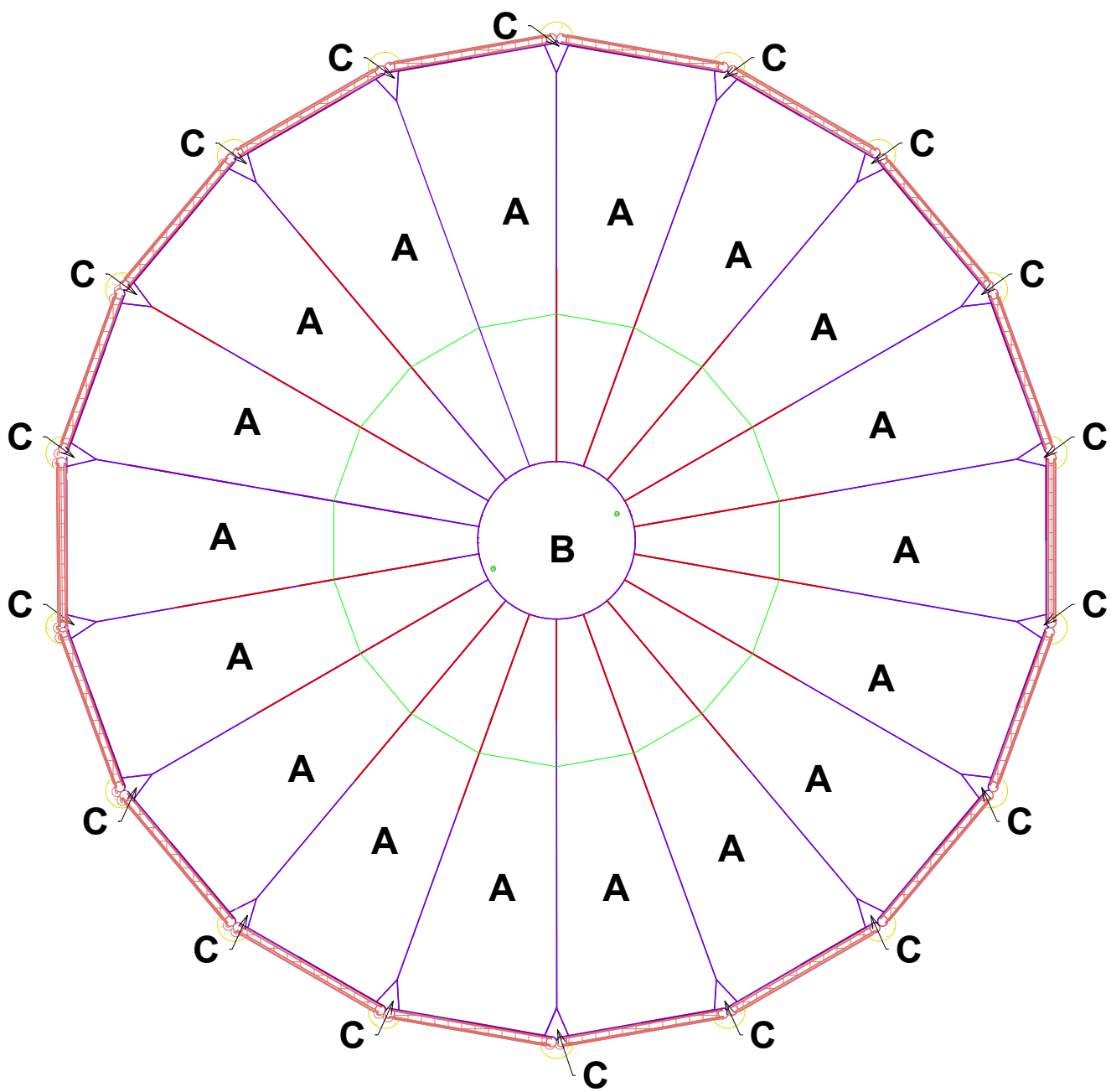

① FLOOR SHEATHING PLAN  
1/4" = 1'-0"

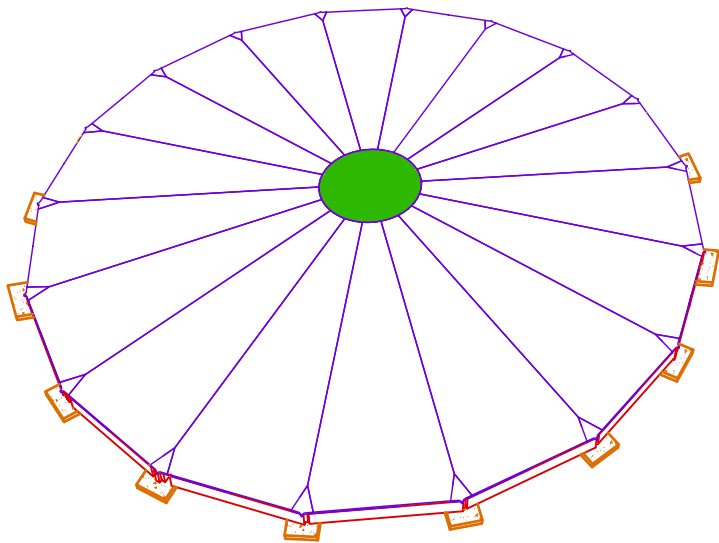

② FLOOR SHEATHING ASIONOMETRIC VIEW

SCALE:AS SHOWN

PROJECT NAME  
PROJECT LOCATION

1"  
Note: sheet is printed  
full size at 11"x17". The  
guide scale above will  
print 1" length,  
otherwise scale  
accordingly.

FLOOR SHEATHING  
PLAN

A1.4

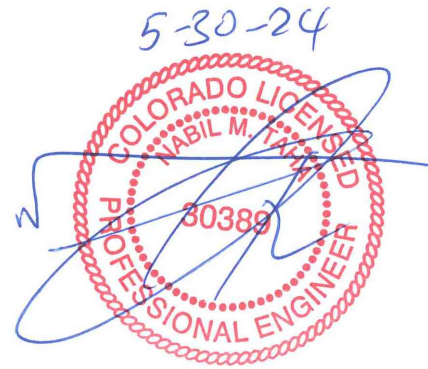
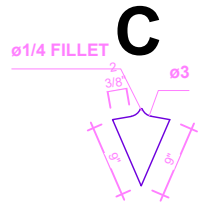
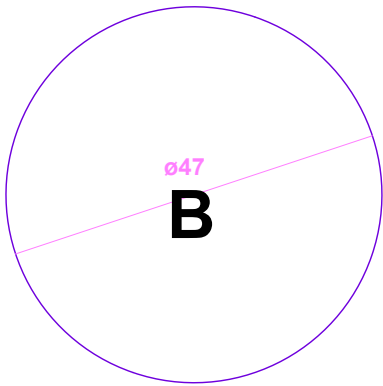
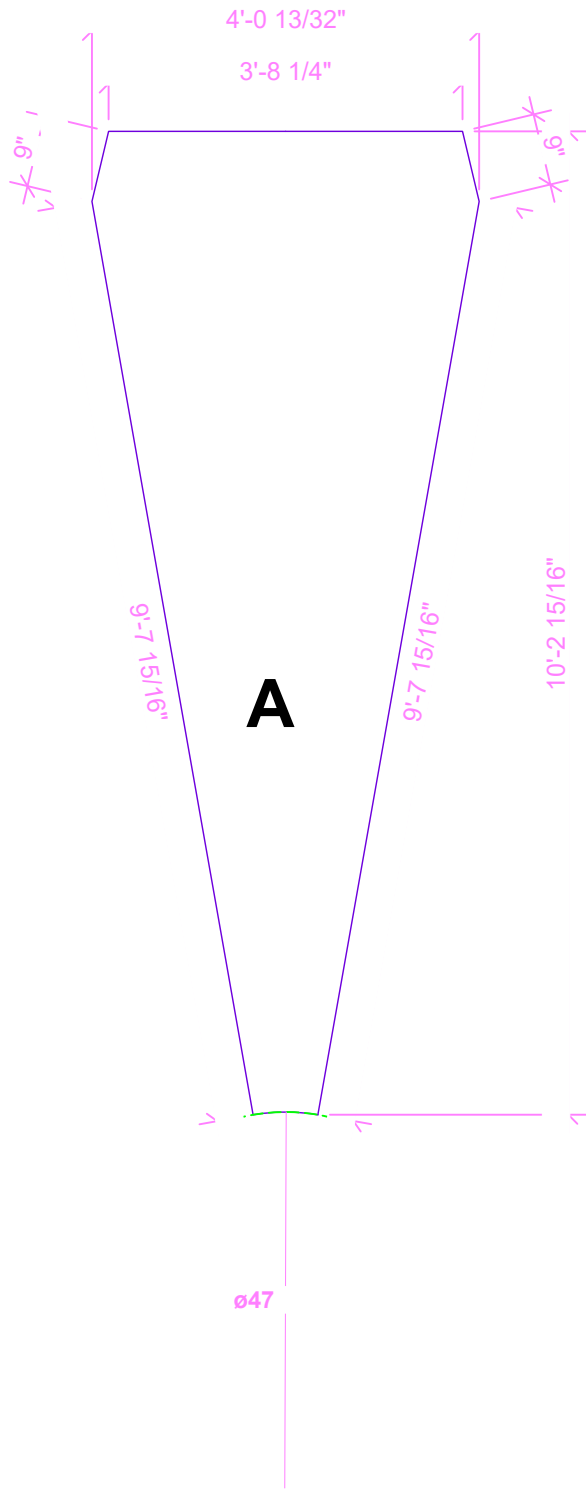
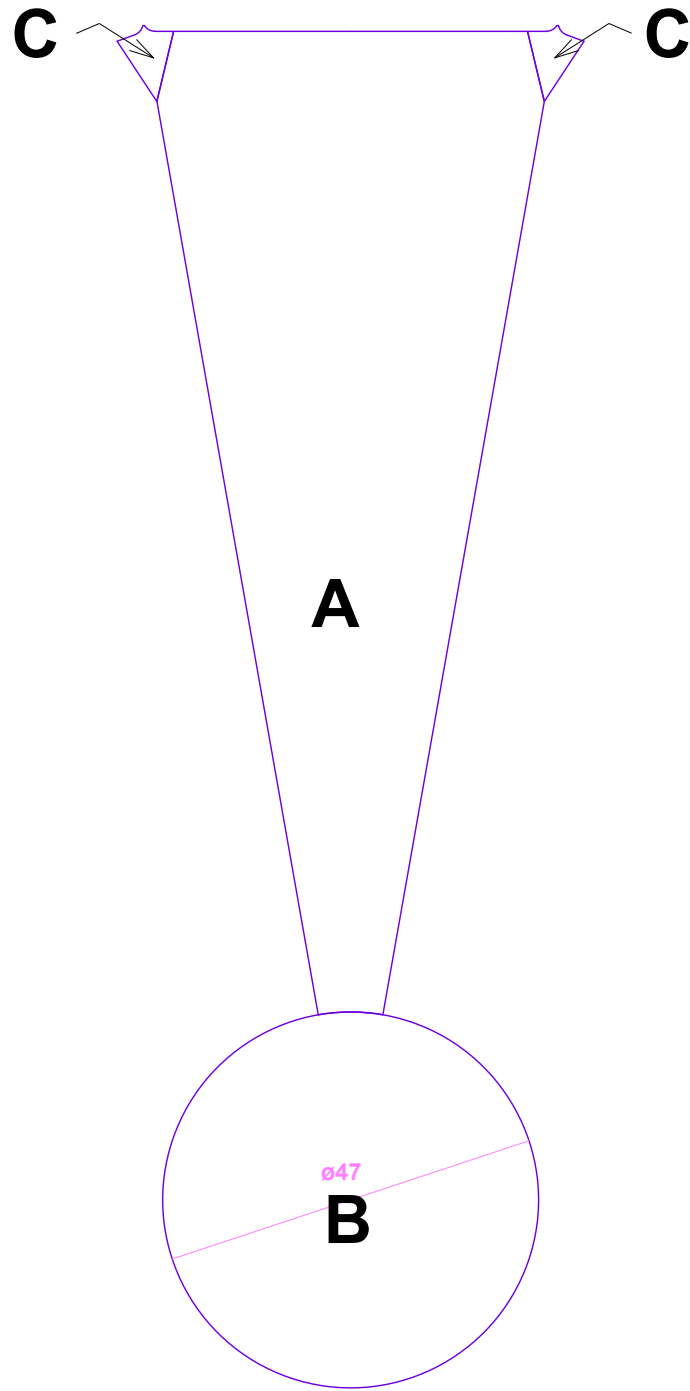

**Expires 10/31/2025**  
Structural members only were included in this structural review/design. Non-structural members are NOT included.

**PSE**  
Consulting Engineers, Inc.  
www.structure1.com  
Corporate Office  
250 Main  
Klamath Falls, OR 97603  
Phone: (541) 850-6300  
navorick@structure1.com  
**PROJECT #:**  
Freedom Yurt  
Cabins 224-001  
Generic  
18-Sided Cabin



**PROJECT NAME**  
**PROJECT LOCATION**

**1"**  
Note: sheet is printed full size at 11"x17". The guide scale above will print 1" length, otherwise scale accordingly.

**BASIC FLOOR SHEATHING TRIANGLES**

**SCALE: 1/2" = 1'-0"**

**A1.5**

**1 FLOOR SHEATHING BASIC CUTS**  
1/2" = 1'-0"



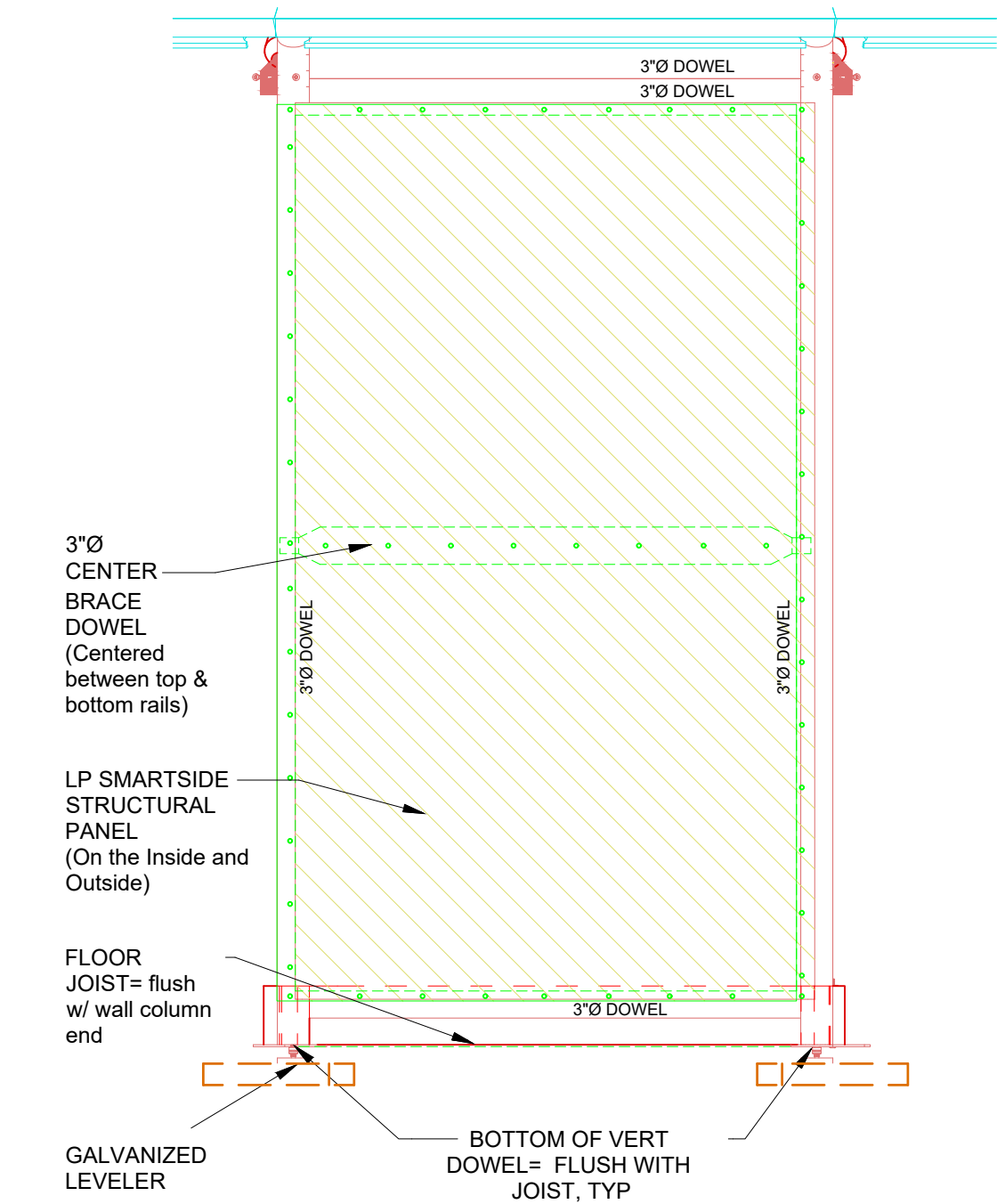

① ELEVATION - WALL  
1/4" = 1'-0"

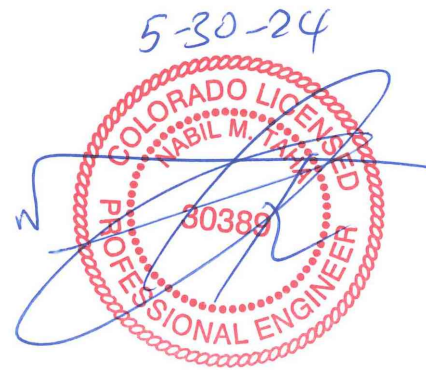

Expires 10/31/2025

Structural members only were included in this structural review/design. Non-structural members are NOT included.

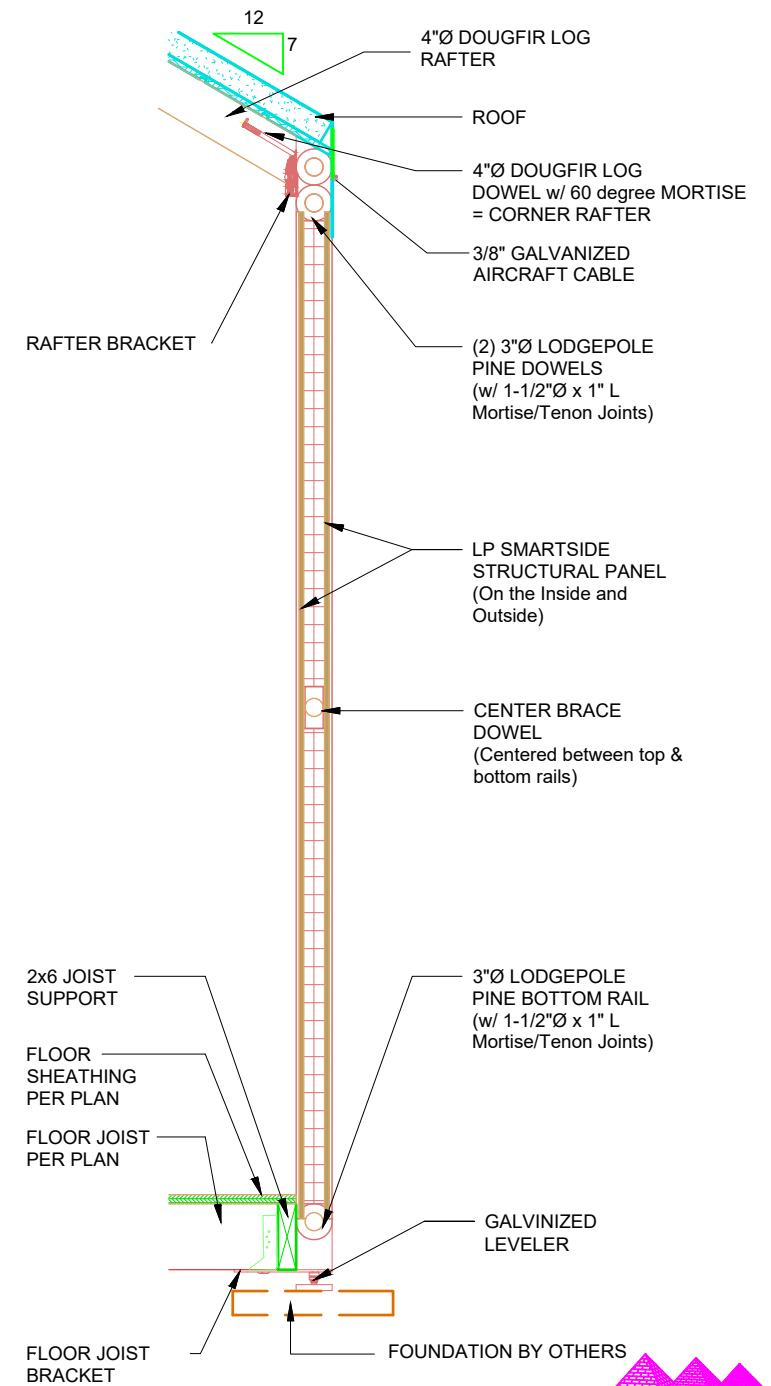

② ELEVATION - WALL  
1/4" = 1'-0"

PSE  
Consulting  
Engineers,  
Inc.  
www.structure1.com  
Corporate Office  
250 Main  
Klamath Falls,  
OR 97603  
Phone: (541) 850-6300  
maverick@structure1.com  
PROJECT #:  
Freedom Yurt  
Cabins 224-001  
Generic  
18-Sided Cabin

SCALE:AS SHOWN



PROJECT NAME  
PROJECT LOCATION

1"  
Note: sheet is printed full size at 11"x17". The guide scale above will print 1" length, otherwise scale accordingly.

WALL UNIT DETAILS

A2.0

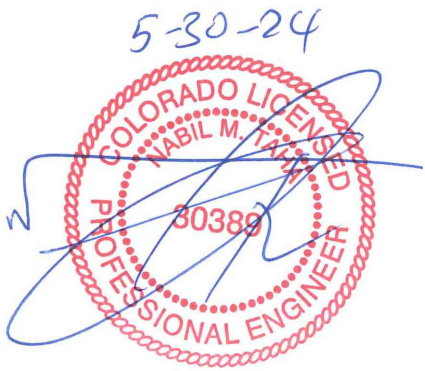

Structural members only were included in this structural review/design. Non-structural members are NOT included.

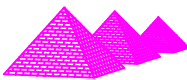

PSE Consulting Engineers, Inc.

www.structure1.com  
Corporate Office  
250 Main  
Klamath Falls, OR 97603  
Phone: (541) 850-6300  
maverick@structure1.com

PROJECT #:  
Freedom Yurt  
Cabins 224-001  
Generic  
18-Sided Cabin



FREEDOM YURT CABINS  
3200 CR100  
BUILDING 10  
FREEDOMYURTCABINS@GMAIL.COM  
(719) 362-3333

PROJECT NAME  
PROJECT LOCATION

1"

Note: sheet is printed full size at 11"x17". The guide scale above will print 1" length, otherwise scale accordingly.

DOOR UNIT DETAILS

A2.1

SCALE:AS SHOWN

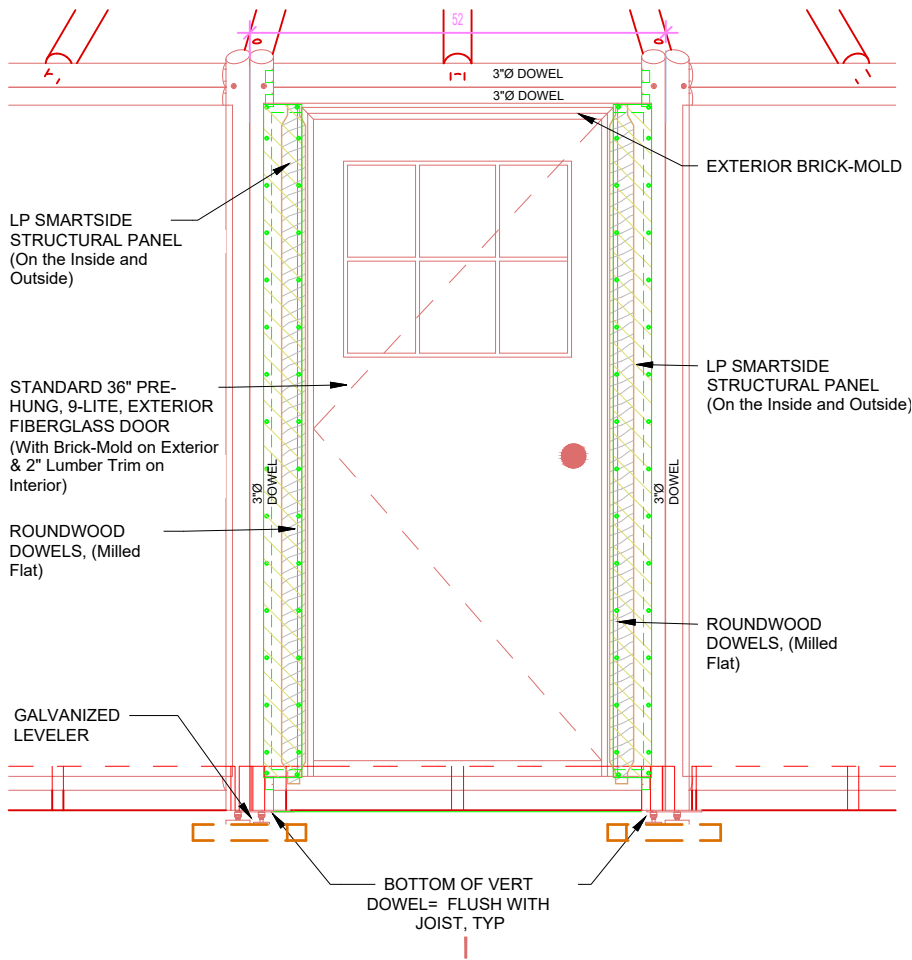

1 ELEVATION - DOOR UNIT  
1/2" = 1'-0"

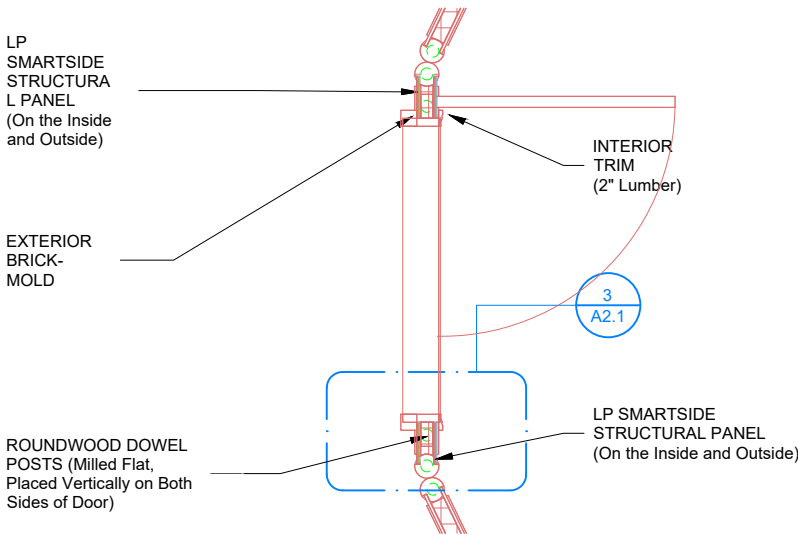

2 DOOR - PLAN VIEW  
1/2" = 1'-0"

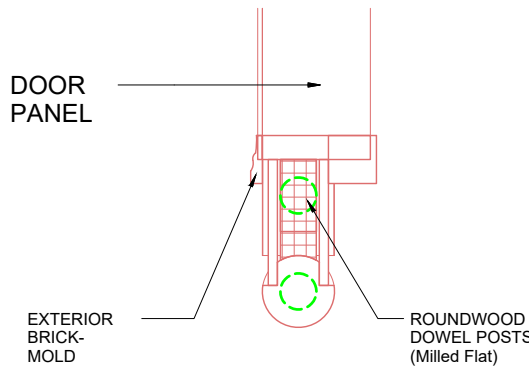

3 DOOR JAMB  
1" = 1'-0"

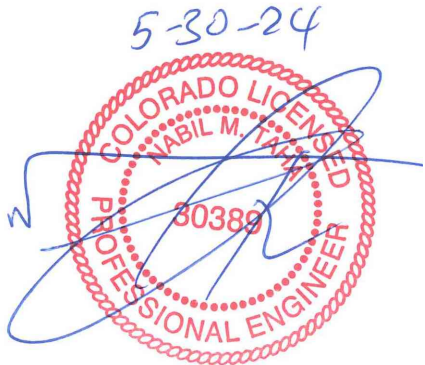

  
PSE  
Consulting  
Engineers,  
Inc.  
www.structure1.com  
Corporate Office  
250 Main  
Klamath Falls,  
OR 97603  
Phone: (541) 850-6300  
maverick@structure1.com  
PROJECT #:  
Freedom Yurt  
Cabins 224-001  
Generic  
18-Sided Cabin

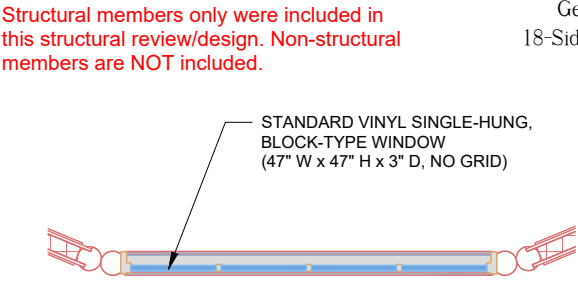

③ WINDOW UNIT (PLAN VIEW)  
1/2" = 1'-0"

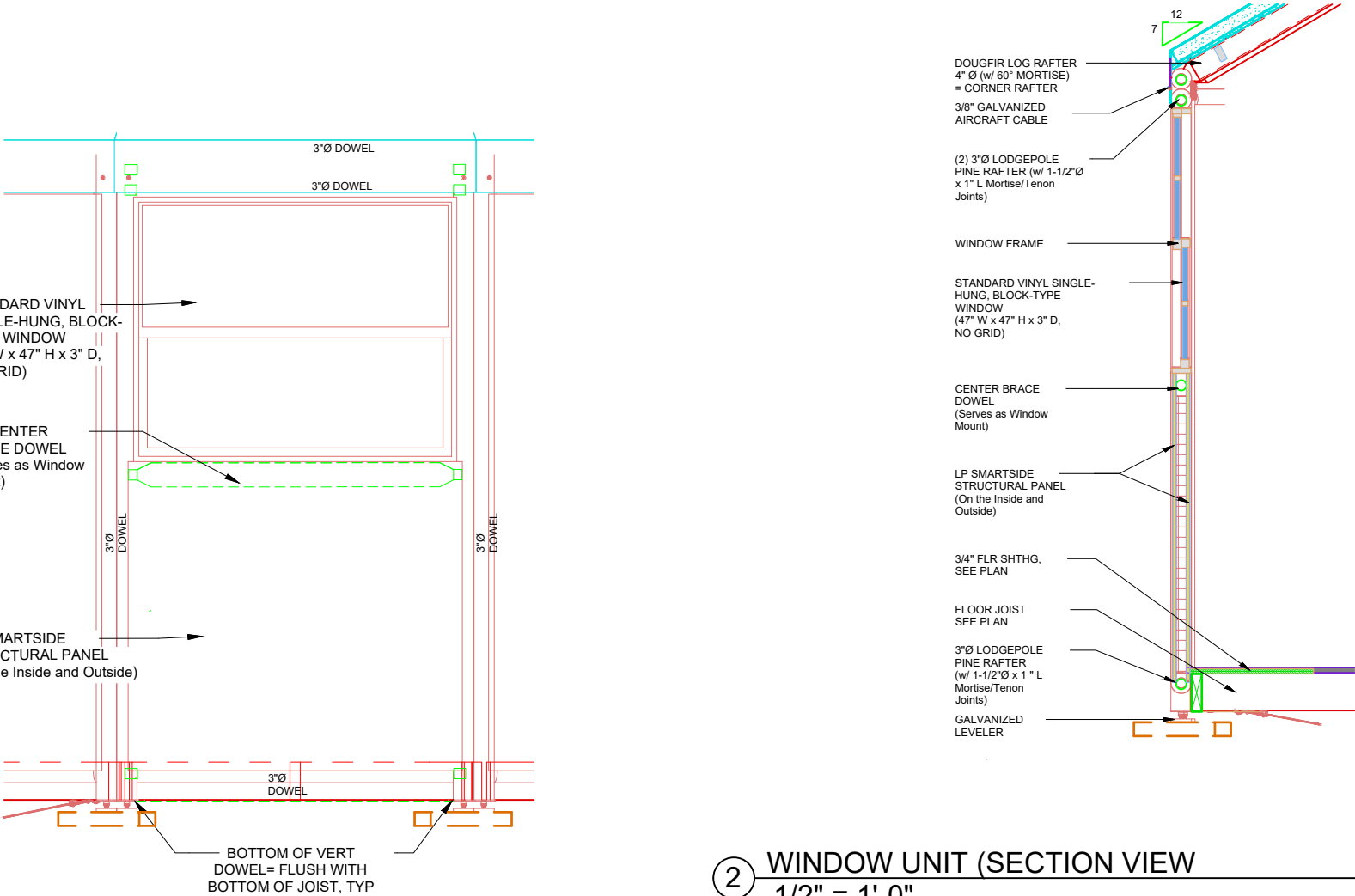

② WINDOW UNIT (SECTION VIEW)  
1/2" = 1'-0"

① WINDOW UNITS (ELEVATION VIEW)  
1/2" = 1'-0"

PROJECT NAME  
PROJECT LOCATION

1"  
Note: sheet is printed full size at 11"x17". The guide scale above will print 1" length, otherwise scale accordingly.

WINDOW UNIT  
DETAILS

SCALE:AS SHOWN

A2.2

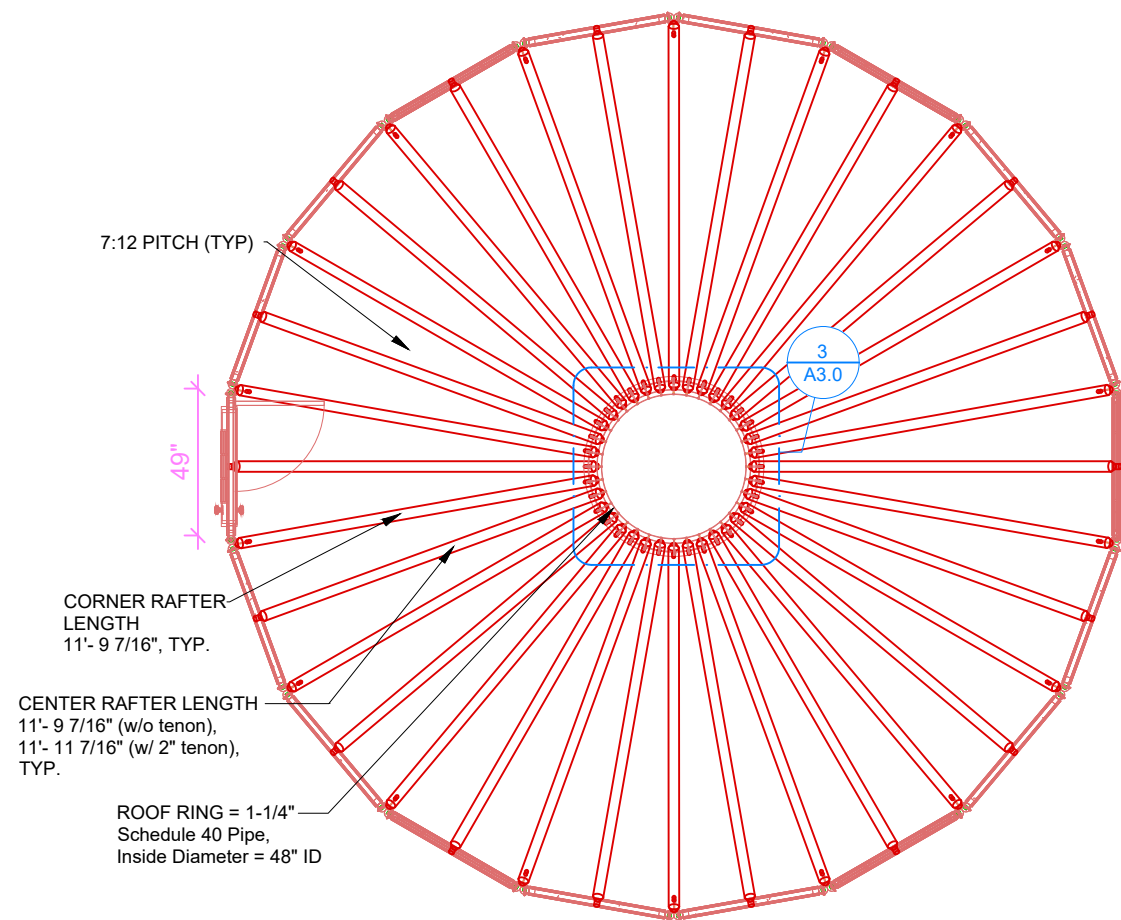

① ROOF FRAMING PLAN  
3/16" = 1'-0"

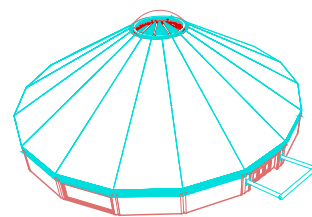

② ROOF FRAMING ISOMETRIC VIEW

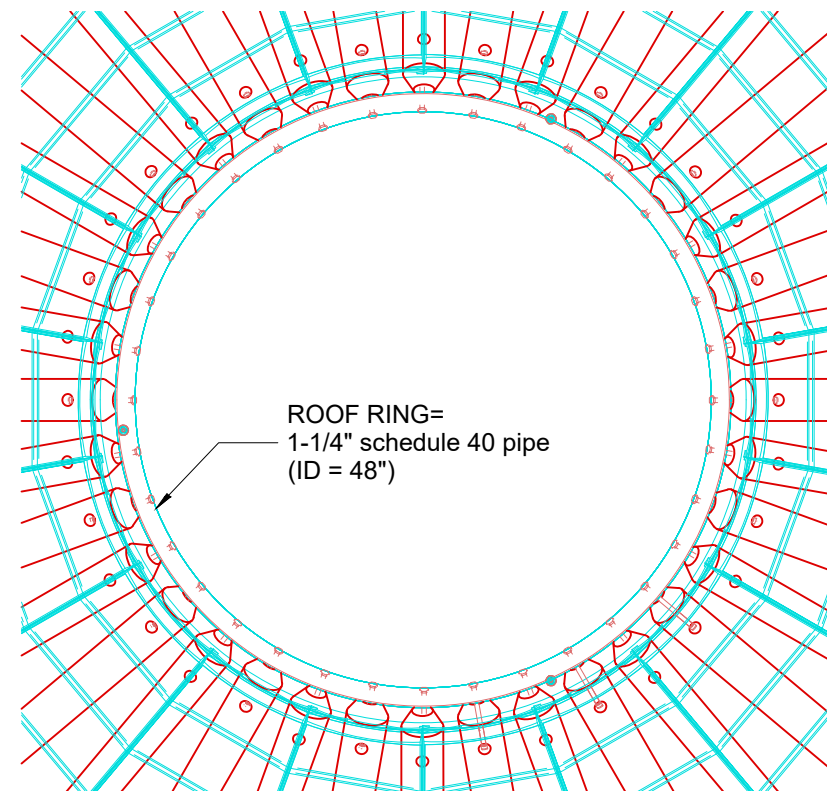

③ ROOF RING DETAIL  
3/4" = 1'-0"

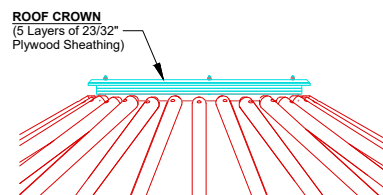

④ ROOF CROWN DETAIL



Expires 10/31/2025

Structural members only were included in this structural review/design. Non-structural members are NOT included.



PSE  
Consulting  
Engineers,  
Inc.  
www.structure1.com  
Corporate Office  
250 Main  
Klamath Falls,  
OR 97603  
Phone: (541) 850-6300  
maverick@structure1.com  
PROJECT #:  
Freedom Yurt  
Cabins 224-001  
Generic  
18-Sided Cabin

SCALE:AS SHOWN

**FREEDOM**  
**YURT-CABINS**  
FREEDOM YURT CABINS  
3200 CR100  
BUILDING 10  
FREEDOMYURTCABINS@GMAIL.COM  
(719) 362-3333

PROJECT NAME  
PROJECT LOCATION

1"  
Note: sheet is printed  
full size at 11"x17". The  
guide scale above will  
print 1" length,  
otherwise scale  
accordingly.

ROOF FRAMING  
PLAN AND DETAILS

A3.0

Distance from T.O. Floor Sheathing to B.O. Roof Ring= 13' 1 81/128"

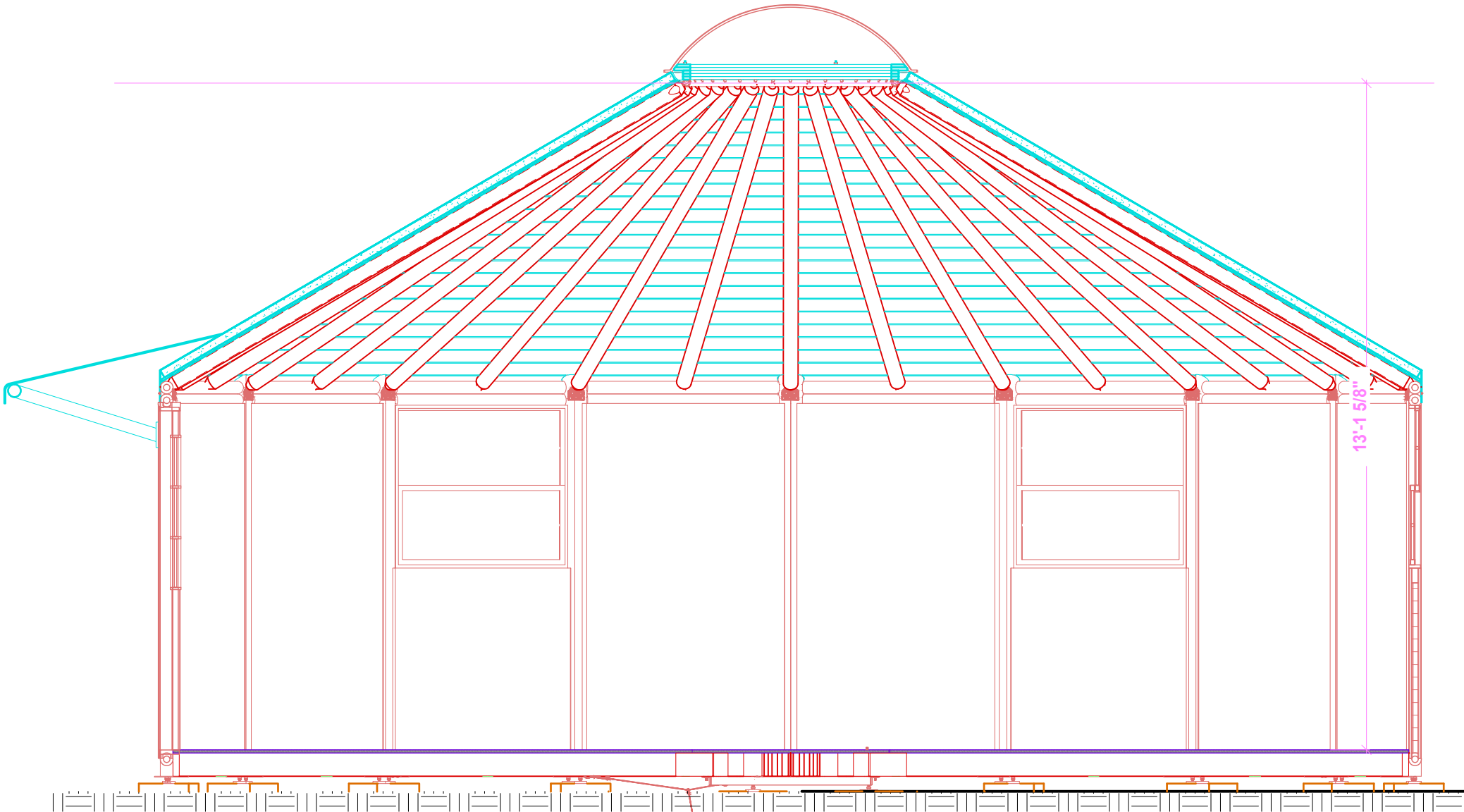

① ROOF HEIGHT  
3/8" = 1'-0"

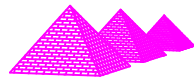

PSE  
Consulting  
Engineers,  
Inc.

www.structure1.com  
Corporate Office  
250 Main  
Klamath Falls,  
OR 97603  
Phone: (541) 850-6300  
maverick@structure1.com

PROJECT #:

Freedom Yurt  
Cabins 224-001  
Generic  
18-Sided Cabin



FREEDOM YURT CABINS  
3200 CR100  
BUILDING 10  
FREEDOMYURTCABINS@GMAIL.COM  
(719) 362-3333

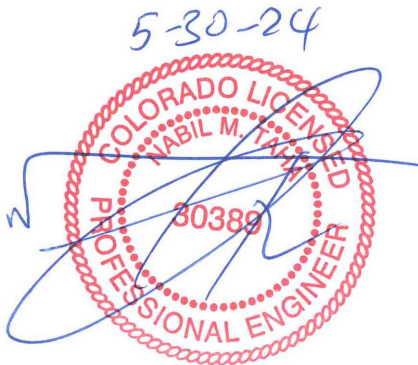

Expires 10/31/2025

Structural members only were included in  
this structural review/design. Non-structural  
members are NOT included.

PROJECT NAME  
PROJECT LOCATION

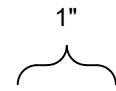

Note: sheet is printed  
full size at 11"x17". The  
guide scale above will  
print 1" length,  
otherwise scale  
accordingly.

ROOF HEIGHT

SCALE:3/8" = 1'-0"

A3.1



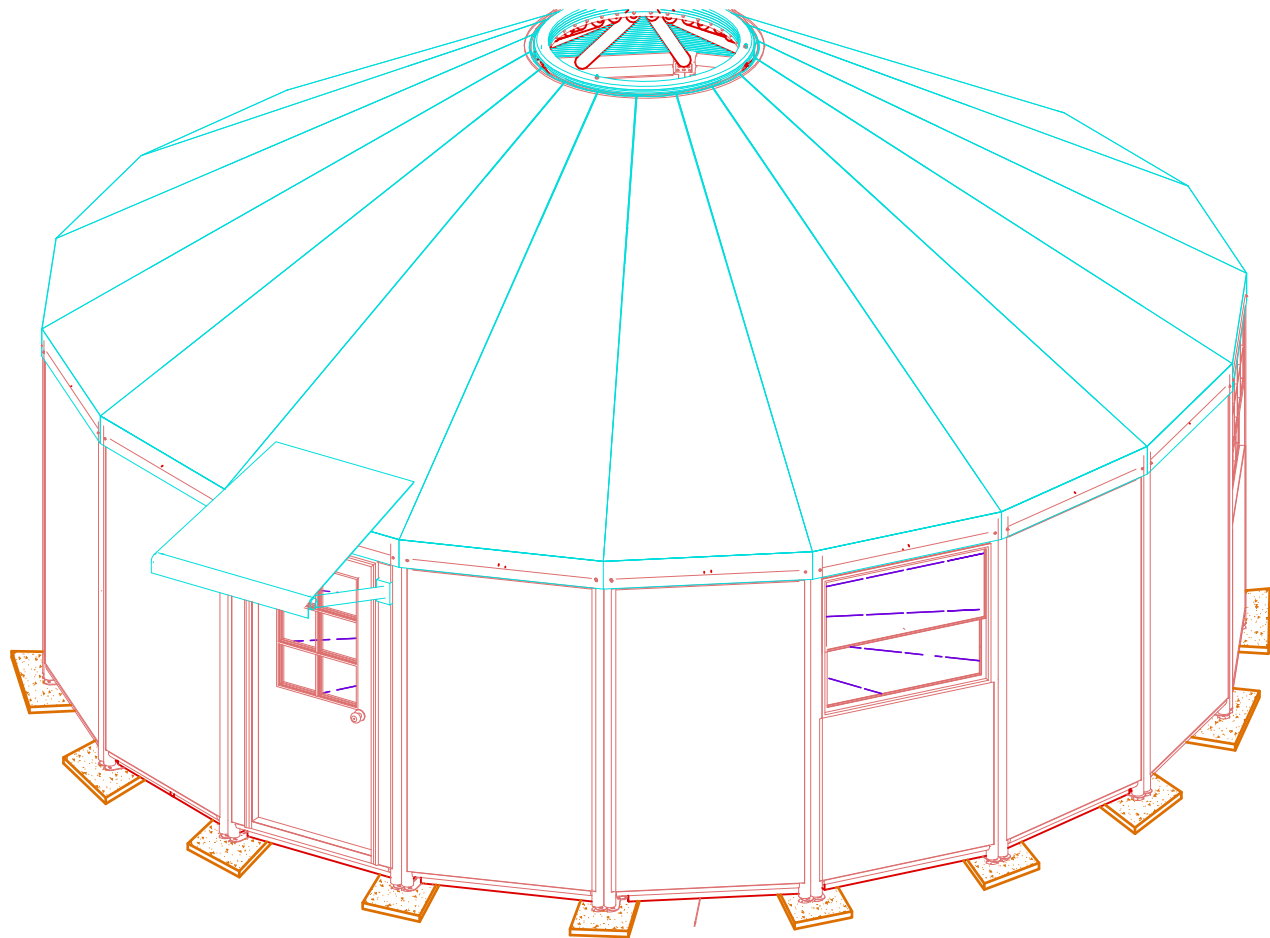

1 ROOF 3D VIEW  
1/4" = 1'-0"

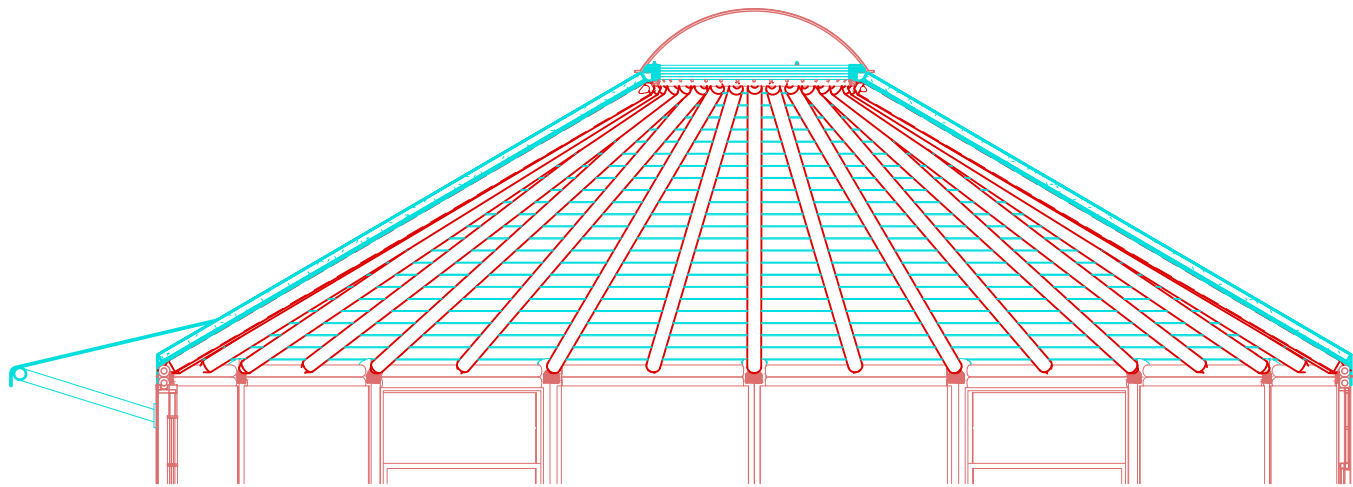

2 ROOF SECTION  
1/4" = 1'-0"

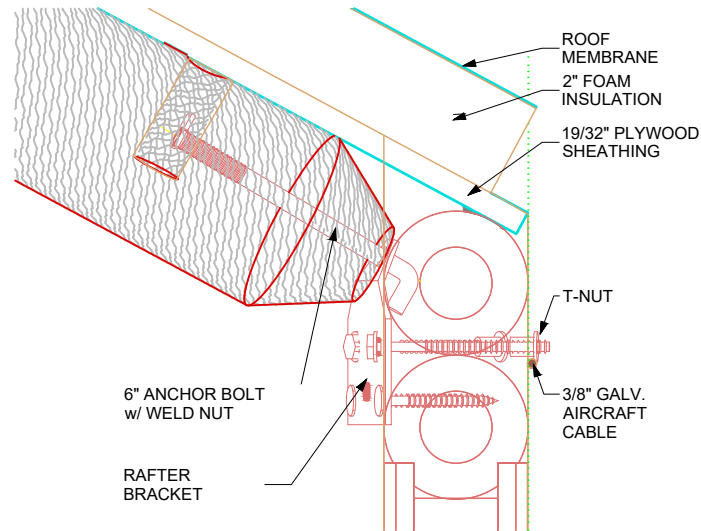

3 ROOF TO WALL DETAIL

**FREEDOM**  
YURT-CABINS  
FREEDOM YURT CABINS  
3200 CR100  
BUILDING 10  
FREEDOMYURTCABINS@GMAIL.COM  
(719) 362-3333

PROJECT NAME  
PROJECT LOCATION

1"  
Note: sheet is printed  
full size at 11"x17". The  
guide scale above will  
print 1" length,  
otherwise scale  
accordingly.

ROOF DETAILS

A3.2



Expires 10/31/2025  
Structural members only were included in  
this structural review/design. Non-structural  
members are NOT included.

**PSE**  
Consulting  
Engineers,  
Inc.  
www.structure1.com  
Corporate Office  
250 Main  
Klamath Falls,  
OR 97603  
Phone: (541) 850-6300  
maverick@structure1.com  
PROJECT #:  
Freedom Yurt  
Cabins 224-001  
Generic  
18-Sided Cabin

SCALE:AS SHOWN

  
PSE  
Consulting  
Engineers,  
Inc.  
www.structure1.com  
Corporate Office  
250 Main  
Klamath Falls,  
OR 97603  
Phone: (541) 850-6300  
maverick@structure1.com

PROJECT #:  
Freedom Yurt  
Cabins 224-001  
Generic  
18-Sided Cabin

  
FREEDOM YURT CABINS  
3200 CR100  
BUILDING 10  
FREEDOMYURTCABINS@GMAIL.COM  
(719) 362-3333



**Expires 10/31/2025**  
Structural members only were included in  
this structural review/design. Non-structural  
members are NOT included.

PROJECT NAME  
PROJECT LOCATION

1"  
Note: sheet is printed  
full size at 11"x17". The  
guide scale above will  
print 1" length,  
otherwise scale  
accordingly.

ROOF TRIANGLES

SCALE:3/8" = 1'-0"

A3.3

19/32" PLYWOOD SHEATHING

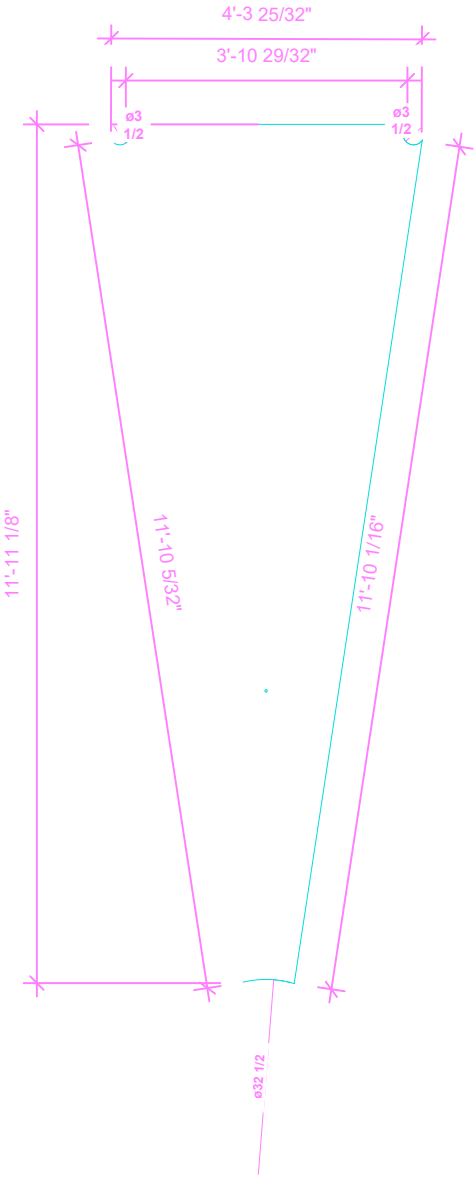

2" FOAM  
POLYISOCYANURATE  
INSULATION

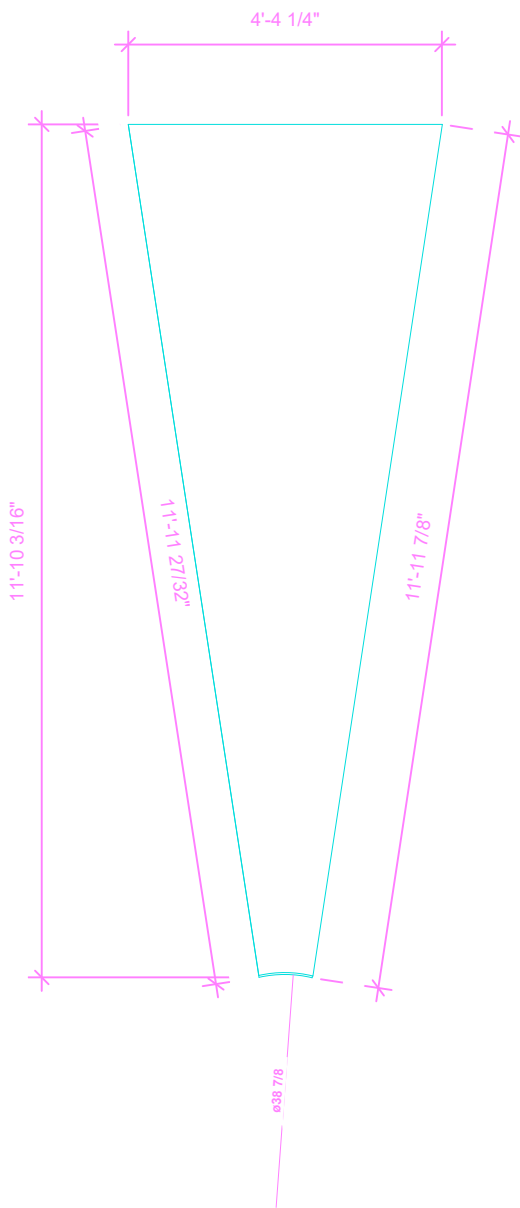

MEMBRANE

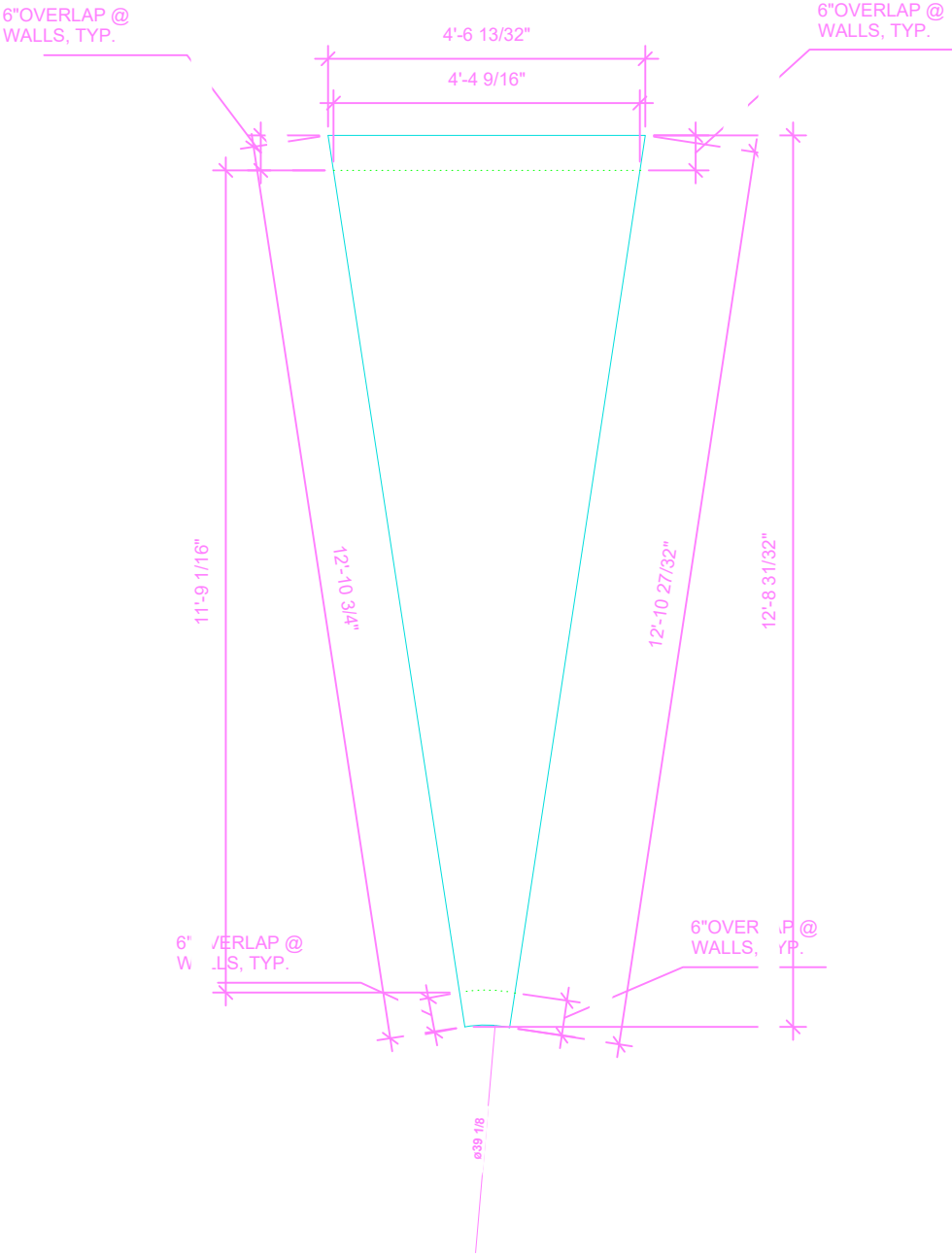

1 ROOF PANEL BASIC CUTS  
3/8" = 1'-0"

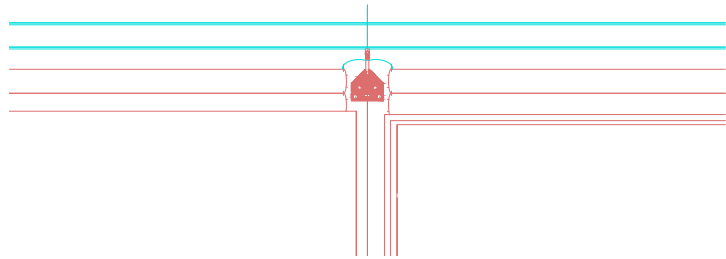

① CENTER ROOF RAFTER SECTION  
1/2" = 1'-0"

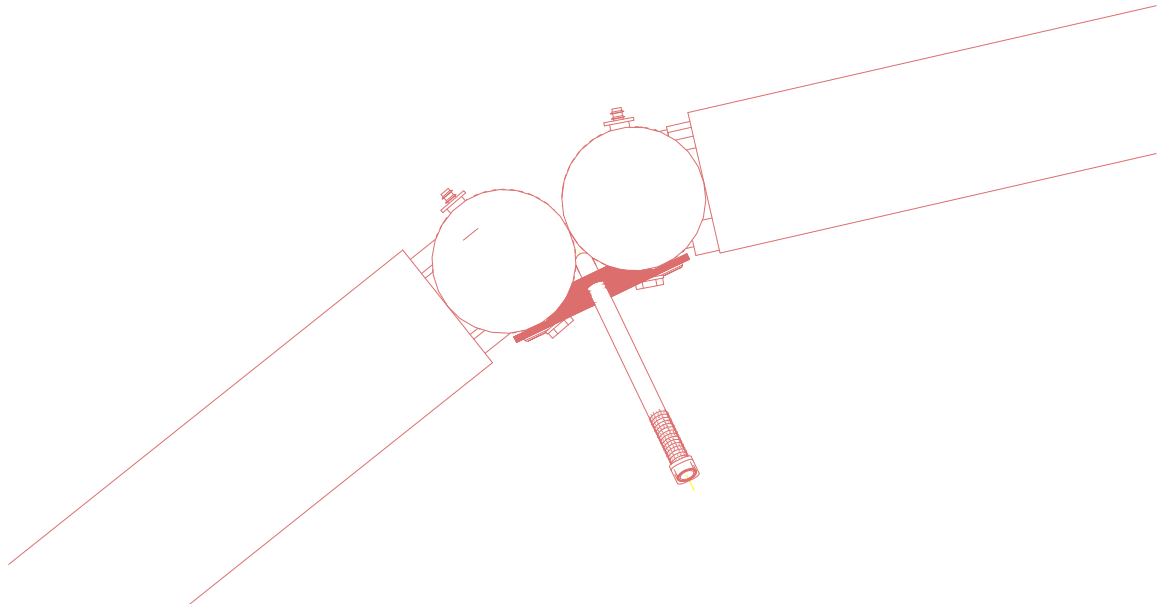

② CORNER ROOF RAFTER SECTION  
3" = 1'-0"

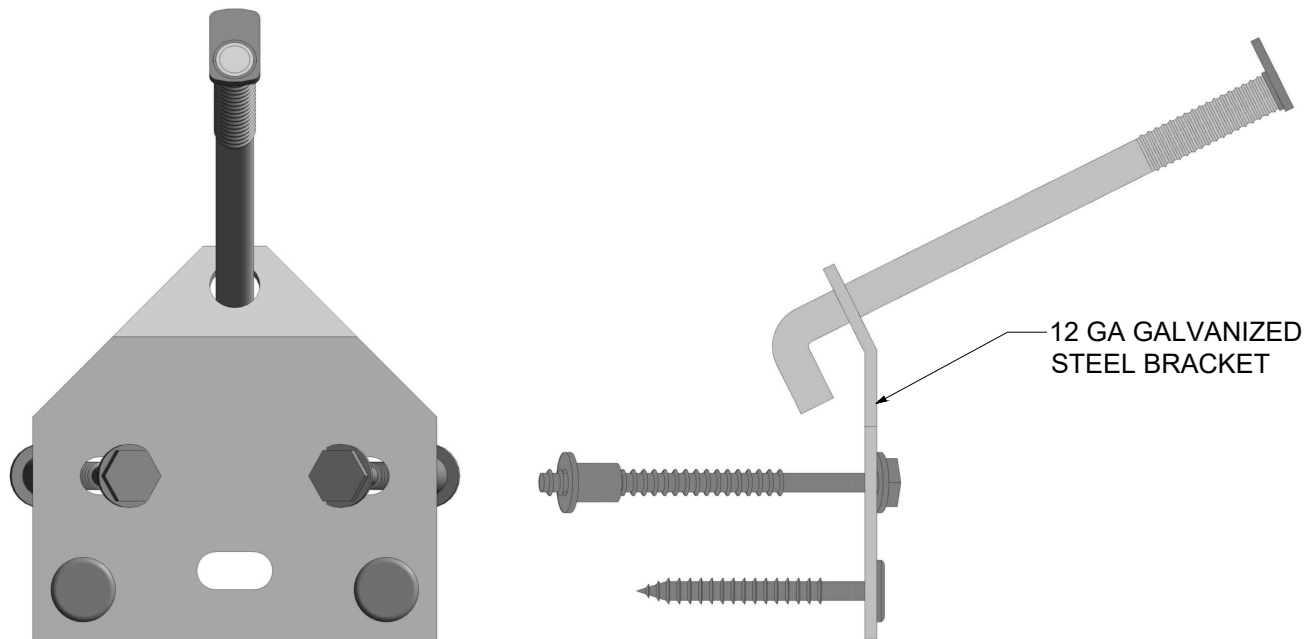

③ RAFTER BRACKET

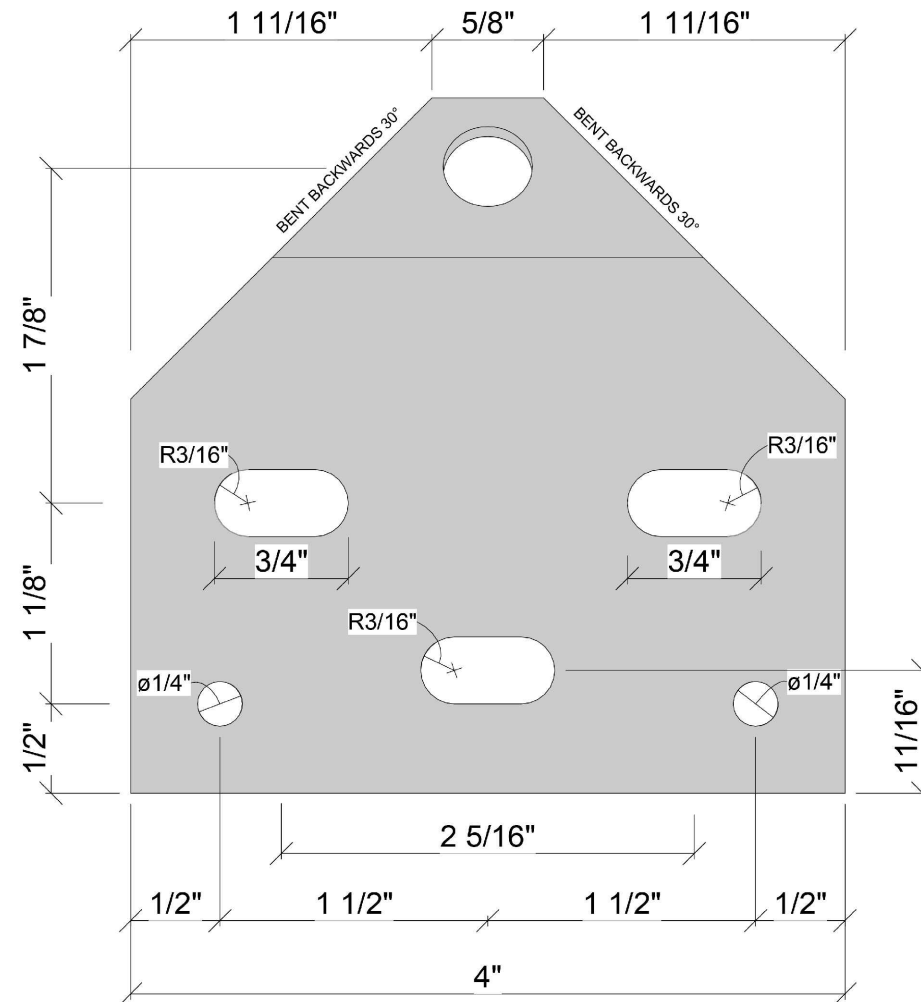

④ RAFTER BRACKET

PSE  
Consulting  
Engineers,  
Inc.  
www.structure1.com  
Corporate Office  
250 Main  
Klamath Falls,  
OR 97603  
Phone: (541) 850-6300  
maverick@structure1.com  
PROJECT #:  
Freedom Yurt  
Cabins 224-001  
Generic  
18-Sided Cabin



PROJECT NAME  
PROJECT LOCATION

1"  
Note: sheet is printed  
full size at 11"x17". The  
guide scale above will  
print 1" length,  
otherwise scale  
accordingly.

RAFTER BRACKET  
DETAILS

A3.4

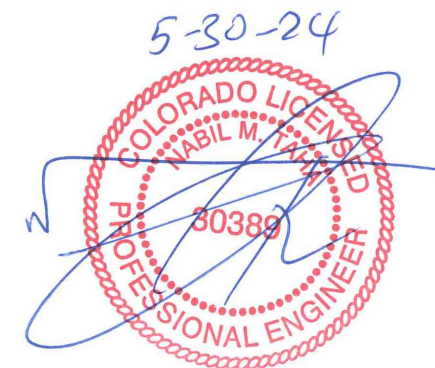

Expires 10/31/2025

Structural members only were included in  
this structural review/design. Non-structural  
members are NOT included.

SCALE:AS SHOWN



PSE  
Consulting  
Engineers,  
Inc.  
www.structure1.com  
Corporate Office  
250 Main  
Klamath Falls,  
OR 97603  
Phone: (541) 850-6300  
maverick@structure1.com

PROJECT #:  
Freedom Yurt  
Cabins 224-001  
Generic  
18-Sided Cabin

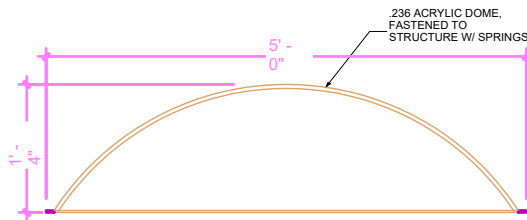

① CABIN DOME SECTION VIEW  
3/8" = 1'-0"

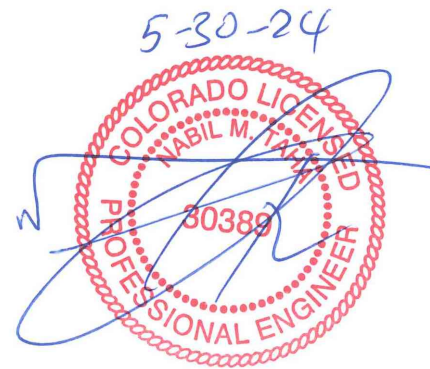

Expires 10/31/2025

Structural members only were included in  
this structural review/design. Non-structural  
members are NOT included.

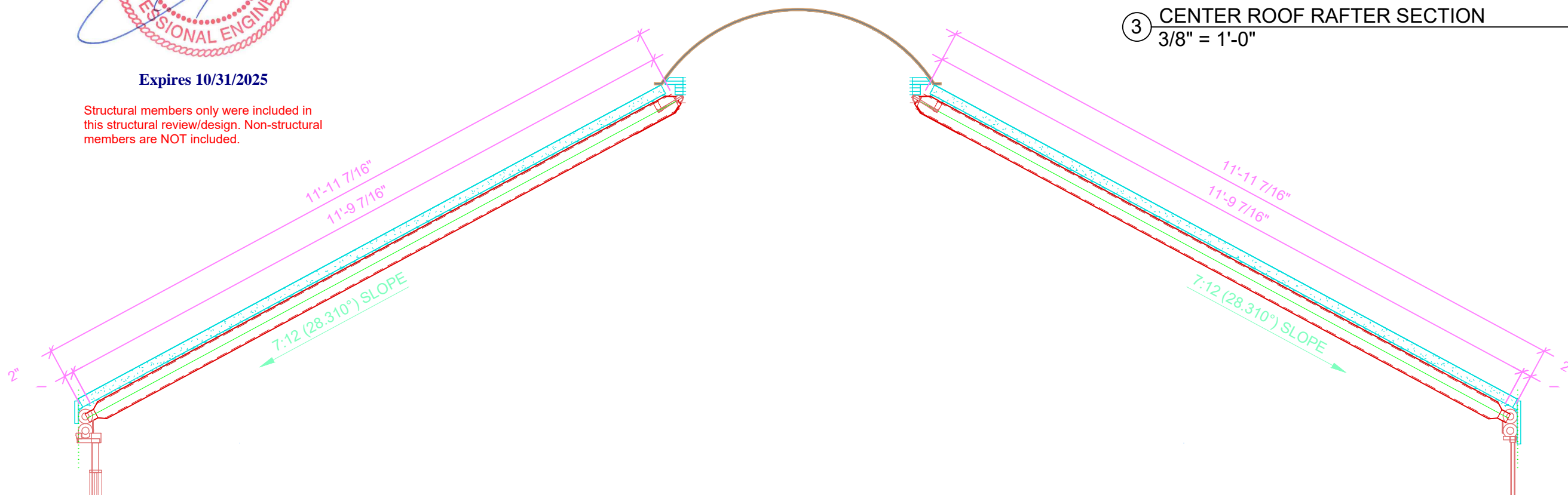

② CENTER ROOF SECTION  
3/8" = 1'-0"

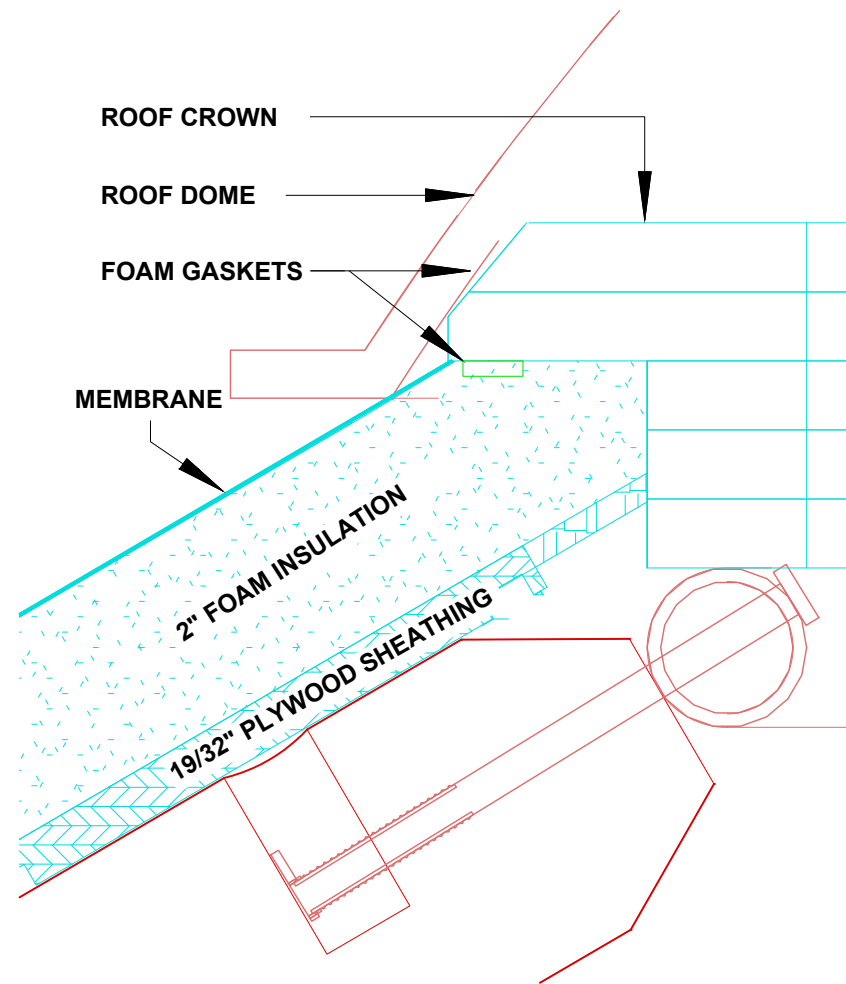

③ CENTER ROOF RAFTER SECTION  
3/8" = 1'-0"



PROJECT NAME  
PROJECT LOCATION

1"  
Note: sheet is printed  
full size at 11"x17". The  
guide scale above will  
print 1" length,  
otherwise scale  
accordingly.

ACRYLIC DOME  
DETAILS

SCALE:AS SHOWN

A3.5