

TB-16-345 merged.pdf Markup Summary

Page 5 (1)

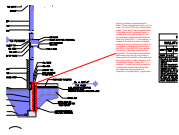

Subject: Cloud+
Page: Page 5
Status:
Author: tallen
Date: 09/22/2016 2:05:27 PM
Color: ■
Layer:
Space:

Specify insulation requirements for slabs. These requirements apply only to slabs 12 inches (305 mm) or less below grade. The listed R-value requirements in the table are for unheated slabs. A heated slab must add another R-5 to the required insulation levels based on Note d of Table 402.1.1. Accordingly, a heated slab shall also have insulating materials having a minimum R-value of 5 installed in accordance with Section M2103.2 of the 2009 IRC plus another R-5 for the slab edge component as applicable. The insulation must extend downward from the top of the slab or downward to the bottom of the slab and then horizontally in either direction until the distance listed in Table 402.1.1 is reached. Correct the building sections to reflect this requirement along with any additional requirements for insulation of heated slabs, if applicable.

Page 6 (2)



Subject: Cloud+
Page: Page 6
Status:
Author: tallen
Date: 09/22/2016 1:56:10 PM
Color: ■
Layer:
Space:

Provide electronic copy of Soils Report

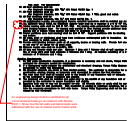

Subject: Cloud+
Page: Page 6
Status:
Author: tallen
Date: 09/22/2016 2:14:24 PM
Color: ■
Layer:
Space:

An engineering design shall be submitted for all unconventional framing in accordance with Section R301.1. Show how the tall walls and lateral loads were addressed with the use of exterior and/or interior walls.