

Permit Application

Type of permit applied for:

Grading and Excavating ☒

Cattle Guard Installation ☐

Adopt A Highway ☐

other ☐

Thickener
Underflow
Borehole ☐

Driveway ☐

Special Event ☐

Plow ☐

Utility Installation ☐

Oversize/Overweight ☐

Work in Right-of Way ☐

Property Information

Project physical address: 29515 Routt County Road #27

Parcel Number: 945321001, 944362001, Section(s): Sec 36 (R87)

Area to be disturbed: & 944364001 Sec 31 (R86)
2 Acres Max

City: Oak Creek

Township: T5N

Owner/Applicant Information

Applicant/ Contractor: Twentymile Coal, LLC

Mailing Address: 29515 RCR #27

City: Oak Creek

State: CO

Zip: 80467

Phone number: 970-879-3800

Email: jnettleton@peabodyenergy.com

Property Owner: Twentymile Coal, LLC (address same as above), 20 Mile Sheep, LLC

Mailing Address: 35513 North Hwy 13

City: Craig

State: CO

Zip: 81625

Phone Number: 970-824-6349

Email:

Contractor Name: Bower Brothers Const.

Phone number:

970-326-8562

Project Description:

Construction of a 250' x 170' borehole pad and the rehabilitation of an existing access road. The pad and access road will be used for the drilling of a single Thickener Underflow borehole into Twentymile Mine's old workings.

GRADING PLAN REVIEW FEES

<input type="checkbox"/> 50 cubic yards.....	No Fee
<input type="checkbox"/> 50 to 100 cubic yards.....	\$26.50
<input type="checkbox"/> 100 to 1,000 cubic yards.....	\$42.00
<input checked="" type="checkbox"/> 1,000 to 10,000 cubic yards.....	\$55.00
<input type="checkbox"/> 10,000 to 100,000 cubic yards – \$55.00 for the first 10,000 cubic yards, plus \$27.50 for each additional 10,000 cubic yards or fraction thereof.	
<input type="checkbox"/> 100,000 to 200,000 cubic yards - \$302.50 for the first 100,000 cubic yards, plus \$14.85 for each additional 10,000 cubic yards or fraction thereof.	
<input type="checkbox"/> 200,000 cubic yards or more - \$451.00 for the first 200,000 yards, plus \$8.15 for each additional 10,000 cubic yards or fraction thereof.	

GRADING PERMIT FEES

<input type="checkbox"/> 0 to 100 cubic yards.....	\$50.00
<input type="checkbox"/> 100 to 1,000 cubic yards - \$50.00 for the first 100 cubic yards, plus \$20.00 for each additional 100 cubic yards or fraction thereof.	
<input checked="" type="checkbox"/> 1,000 to 10,000 cubic yards - \$230.00 for the first 1,000 cubic yards, plus \$16.50 for each additional 1,000 cubic yards or fraction thereof. \$230.00 + \$16.50 = \$246.50	
<input type="checkbox"/> 10,000 to 100,000 cubic yards - \$378.50 for the first 10,000 cubic yards, plus \$75.00 for each additional 10,000 cubic yards or fraction thereof.	
<input type="checkbox"/> 100,000 cubic yards or more - \$1,053.50 for the first 100,000 cubic yards plus \$42.00 for each additional 10,000 cubic yards or fraction thereof.	

OTHER FEES

1. Inspections outside of normal business hours (minimum charge – 4 hours).....	\$50.00 per hour
2. Reinspection fees (work not ready for inspection or called for corrections not made)	\$50.00
3. Inspections for which no fee is specifically indicated (minimum charge – 2 hours).....	\$50.00 per hour
4. Additional plan review required by changes, additions or revisions to or revisions to the approved plans (minimum charge – one half hour).....	\$50.00 per hour

Questions regarding details should be directed to the Road & Bridge Grading and Excavating inspector's office at (970) 870-5344.

Total: \$55.00 + \$246.50 = \$301.50

Storm Water Management Plan

Project Name:

SITE DESCRIPTION			
Project Name and Location (PARCEL #, Section, Township, & Range, and Address)	Thickener Underflow borehole pad construction and access road rehabilitation, Parcels: 945321001 (Twentymile Coal), 944362001 (20 Mile Sheep), 944364001 (20 Mile Sheep), Sec 31 R8E T5N & Sec 36 R8E T5N 29515 RCR #27 Oak Creek, CO 80467	OWNER Name, Address, and Phone #:	Parcel 944362001 & 944364001, owned by 20 Mile Sheep, LLC, 35513 North Hwy 13, Craig, CO 81625, 970-824-6349. Parcel 945321001, owned by Twentymile Coal, LLC, 29515 RCR #27 Oak Creek, CO 80467, 970-879-3800.
Description: (Purpose and Types of Soil Disturbing Activities)	Rehabilitation of a 340' x 20' wide finished top width access road and construction of a 250' x 170' finished drill pad for 1 thickener underflow borehole into the Twentymile Mine's old workings.	CONTACT Name, Address, & Phone #:	Michael Bortline Twentymile Coal, LLC 29515 Routt County Road #27 Oak Creek, CO 80467 970-879-2782, 970-846-6686 mbortline@peabodyenergy.com
# Cubic Yards of soil cut/fill and/or amount of surface area moved:	250' x 170' drill pad - ~1585 YD3 balanced cut and fill, refer to the attached .txt pad report document About 2.0 acres will be disturbed.		
Site Area:	The site is approximately <u>6</u> acres of which <u>2</u> acres will be disturbed by construction activities.		
Sequence of Major Activities			
The order of activities will be as follows:			
1 Please refer to the attached Scope of work for the access road and drill pad dated	5 Access Road - Rehabilitation of 340' of access road with sub-base pit run & finished with compact road base.		
2 Establishment of temporary drainage and sediment control measures.	6 Construction of a 750' long perimeter ditch with four rock check dams on the north, west and south sides of borehole pad.		
3 Drill Pad - Removal of 275' x 195' (1.25 acres) of borehole pad brush and placement	7		
4 Construction of a 250' x 170' finished drill pad.	8		
	9		
Name of Receiving Waters:	Foldel Creek		
CONTROLS			
Erosion and Sediment Practices			
Stabilization Practices			
Temporary Stabilization -	Refer to the attached Exhibit 49S-F2. Temporary stabilization includes wattles or equivalent devices at all soil stockpiles and along the west and east sides of the access road.		
Permanent Stabilization -	Refer to the attached Exhibit 49S-F2. A run-off diversion ditch will be constructed on the northeast, southwest, and southeast sides of the drill pad.		
Weed Control -	Refer to the attached Weed Management Plan dated October 2011.		
Structural Practices			
Refer to the attached application to the Routt County Planning Dept. for an administrative use permit.			
Storm Water Management			
Drainage and sediment from disturbed areas will be controlled by an integrated system, using grading and berms to limit and control surface runoff, mud pits excavated within the footprint of the pad to contain all drilling fluids, and either rock check-dams, silt fence, or straw bales/wattles installed at the low point of the drill- pad to contain sediment and control any discharge.			
Maintenance:	The access road and drill pad surfaces will have approximately 8" of compacted pit run and 3" of compacted road base or screened rock applied. The access road and pad will be maintained and/or plowed as needed by a road blade.		

Storm Water Management Plan

INVENTORY FOR POLLUTION PREVENTION PLAN

The materials or substances listed below are expected to be present onsite during construction:

- Straw or equivalent wattles
- 8-12" fractured limestone for the 2 rock checks.
- Pit run, road base and 3/4" screened rock.
- Wooden stakes or equivalent for the stabilization of the wattles.
- Steel pipe for the borehole surface casings and borehole casing and misc. pipe fittings.
- Small telephone cable attached to the borehole casing, grouted in place with a flowable cement mortar.

Spill Control Practices

In addition to the good housekeeping and material management practices discussed in the previous sections of this plan, the following practices will be followed for spill prevention and cleanup:

- Please refer to the attached Twentymile SPCC plan.
-
-
-

STORM WATER MANAGEMENT PLAN CERTIFICATION

I certify under penalty of law that this document and all attachments were prepared under my direction or supervision in accordance with a system designed to assure that qualified personnel properly gathered and evaluated the information submitted. Based on my inquiry of the person or persons who manage the system, or of those persons directly responsible for gathering the information, the information submitted is, to the best of my knowledge and belief, true accurate, and complete. I am aware that there are significant penalties for submitting false information, including the possibility of fine and imprisonment for knowing violations.

Signed:

Michael A. Berdino

Date:

11-21-16

Pad Report

Mon Sep 05 08:16:34 2016

Top of pad elevation range:: 6924.7682 to 6927.6433

Pad slope percent: 1.000%

Pad slope azimuth: 174°21'36"

Pad slope North component: -0.995%

Pad slope East component : 0.098%

Cut slope: 50.00% 2.00:1 26.57°

Fill slope: 50.00% 2.00:1 26.57°

Existing Surface: I:\Engineering\2016 Thickener Underflow Boreholes\TUF Design\

Grid position: 11716.75,33842.62 to 12266.82,34421.82

Grid resolution X: 50, Y: 50

Grid cell size X: 11.00, Y: 11.58

Balance Tolerance (C.Y.): 10.00

Cut Swell Factor: 1.00

Fill Shrink Factor: 1.00

Pad Earthwork Volumes

Total cut : 42,762.6 C.F., 1,583.80 C.Y.

Total fill: 42,568.1 C.F., 1,576.60 C.Y.

Balance Export: 194.5 C.F., 7.20 C.Y.

Area: 48426.6 Sq.Ft., 1.112 Acres

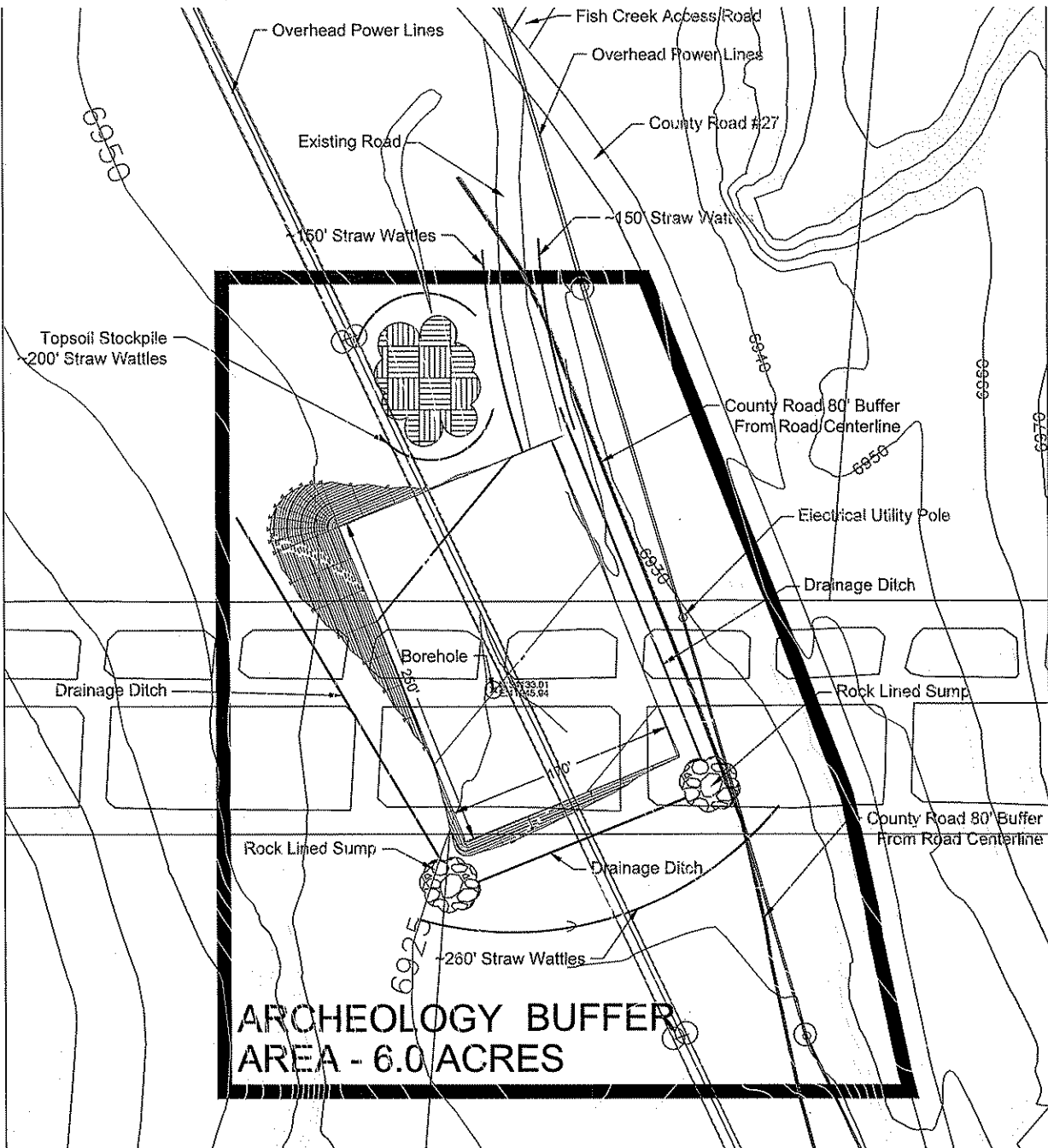

Borehole Information

- Surface Elevation: 6,929'
- Top of Coal Elevation: 6,178'
- Total BH Depth: ~751'
- Surface Casing Size: 18"
- Surface Casing Depth: 60'
- Borehole Diameter: 12"

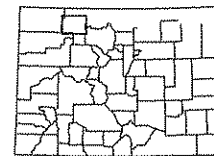

REVISION	REV'D BY	DATE

Ditch Design

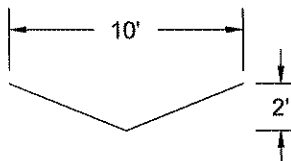

TWENTYMILE COAL, LLC
Peabody
 20515 RCR #27
 OAK CREEK, CO 80487

THICKENER UNDERFLOW BOREHOLE
 SURFACE PAD AND ACCESS ROAD
 MR#-0208 TR16-86
 Exhibit EX49S-F2

DESIGNED BY: Technical Services	COUNTRY: USA
DRAWN BY: Technical Services	STATE/PROVINCE: COLORADO
APPROVED BY:	SECTION: SECTION 17 TEN ROW
DATE: 2010-09-03	DRAWING SHEET: 1 of 1
SCALE: 1" = 10'	C.C.:

T:\Engineering\2010 Thickener Underflow Borehole\2010 Design\2010 EX49S-F2.dwg 09/03/10