

Anchor Way

Ruler

Line

Path

Polygon

Circle

3D path

3D polygon

Measure the distance between multiple points on the ground

Length:

505.77

Feet

☐ Show Elevation Profile

☒ Mouse Navigation

Save

Clear

YAMPA VALLEY ELECTRIC ASSN, INC.

If service is needed from YVEA an
on-site visit will be required to determine
type of service and location of service.

Approved: Nathan Frentress - YVEA 12/10/18

**RCRBD
Record Set**

PJ3390-1
Fire Prevention
In: 12/12/2018
Out: 12/14/2018

Brandon Cir

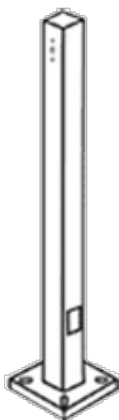

Square steel poles drilled for 2 Area Lights at 180°. Designed for ground mounting. Poles are stocked nationwide for quick shipment. Protective packaging ensures poles arrive at the job site good as new.

Color: Bronze

Weight: 136.7 lbs

Project:

Type:

Prepared By:

Date:

RCRBD Record Set

Technical Specifications

Listings

CSA Listed:

Suitable for wet locations

Construction

Shaft:

46,000 p.s.i. minimum yield.

Hand Holes:

Reinforced with grounding lug and removable cover

Base Plates:

Slotted base plates 36,000 p.s.i.

Shipping Protection:

All poles are shipped in individual corrugated cartons to prevent finish damage

Color:

Bronze powder coating

Height:

20 FT

Weight:

137 lbs

Gauge:

11

Wall Thickness:

1/8"

Shaft Size:

4"

Hand Hole Dimensions:

3" x 5"

Bolt Circle:

8 1/2"

Base Dimension:

8"

Anchor Bolt:

Galvanized anchor bolts and galvanized hardware and anchor bolt template. All bolts have a 3" hook.

Anchor Bolt Templates:

WARNING Template must be printed on 11" x 17" sheet for actual size. CHECK SCALE BEFORE USING. Templates shipped with anchor bolts and available .

Pre-Shipped Anchor Bolts:

Bolts can be pre-shipped upon request for additional freight charge

MaxEPA's/Max Weights:

70MPH 8.3 ft./240 lb
80MPH 5.6 ft./165 lb
90MPH 3.6 ft./110 lb
100MPH 2.2 ft./75 lb
110MPH 1.0 ft./45 lb
120MPH 0.2 ft./20 lb.

Other

Terms of Sale:

Pole Terms of Sale is available .

Buy American Act Compliance:

RAB values USA manufacturing! Upon request, RAB may be able to manufacture this product to be compliant with the Buy American Act (BAA). Please contact customer service to request a quote for the product to be made BAA compliant.

Dimensions

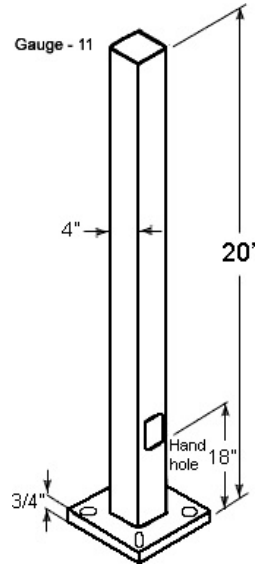

Features

- Designed for ground mounting
- Heavy duty TGIC polyester coating
- Reinforced hand holes with grounding lug and removable cover for easy wiring access
- Anchor Bolt Kit includes pole cap and base cover (sold separately)
- Custom manufactured for each application

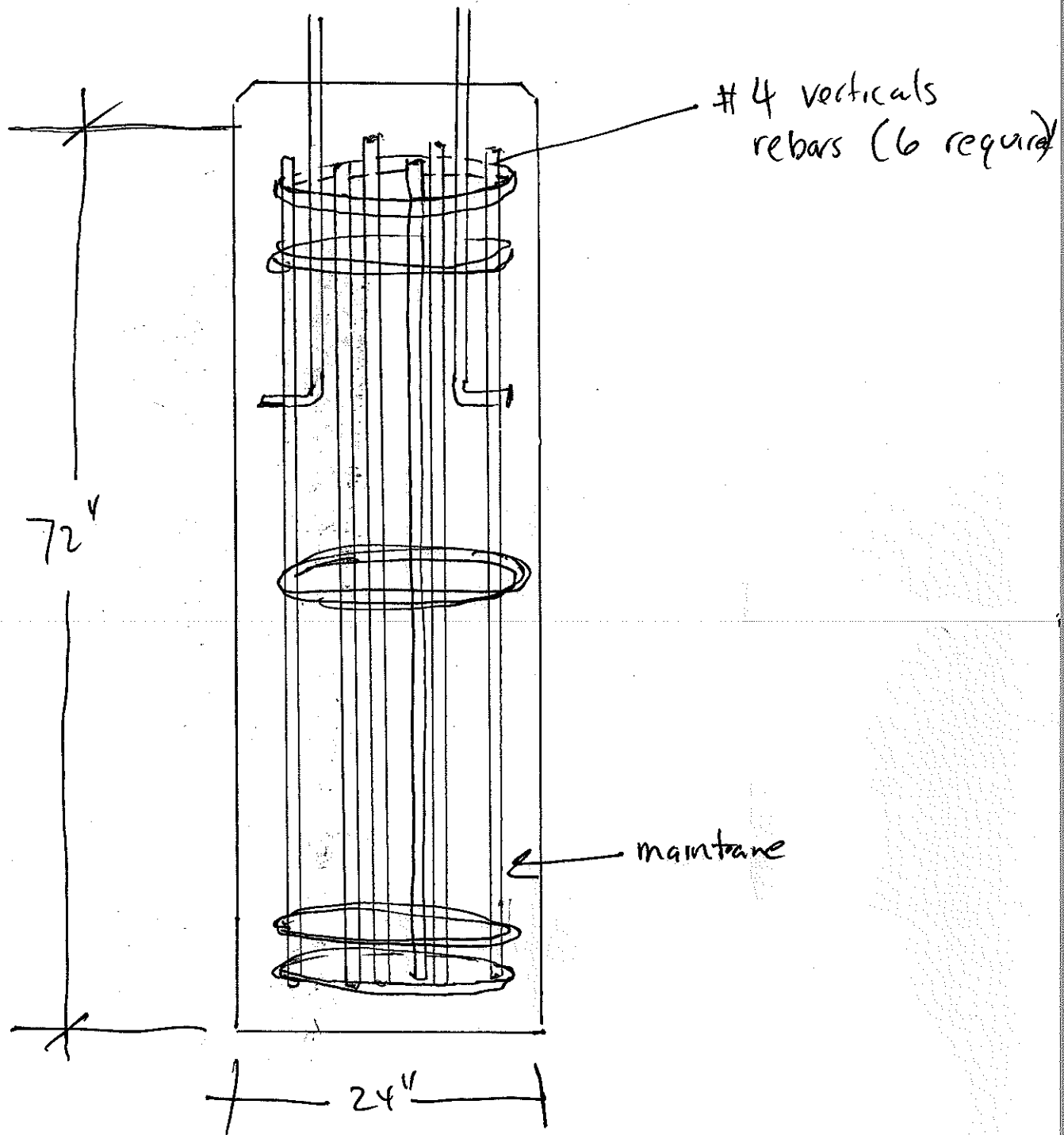

**RCRBD
Record Set**



ALED Area Lights mount to 4" square steel poles at 15'-20'. 1 to 4 fixtures can be mounted to each pole. IES Full Cutoff, Fully Shielded optics. 5-year, no-compromise warranty.

Color: Bronze

Weight: 6.5 lbs

Project:

Type:

Prepared By:

Date:

Driver Info

Type: Constant Current
120V: 0.26A
208V: N/A
240V: N/A
277V: N/A
Input Watts: 29W
Efficiency: 89%

LED Info

Watts: 26W
Color Temp: 3000K
Color Accuracy: 71 CRI
L70 Lifespan: 100000
Lumens: 3296
Efficacy: 112 LPW

Technical Specifications

Electrical

ALED26 with Photocell:

120V Photocell Included. Photocell is only compatible with 120V.

Driver:

Multi-chip 26W high output long life LED Driver Constant Current, 720mA, Class 2, 6kV Surge Protection, 100V-277V, 50-60 Hz, 100-240V.4 Amps.

Listings

DLC Listed:

This product is on the Design Lights Consortium (DLC) Qualified Products List and is eligible for rebates from DLC Member Utilities.
DLC Product Code: P0000175Q

UL Listing:

Suitable for wet locations

IESNA LM-79 & IESNA LM-80 Testing:

RAB LED luminaires have been tested by an independent laboratory in accordance with IESNA LM-79 and 80, and have received the Department of Energy "Lighting Facts" label

Dark Sky Approved:

The International Dark Sky Association has approved this product as a full cutoff, fully shielded luminaire

LED Characteristics

Lifespan:

100,000-hour LED lifespan based on IES LM-80 results and TM-21 calculations

Lumen Maintenance:

The LED will deliver 70% of its initial lumens at 100,000 hours of operation

Color Consistency:

3-step MacAdam Ellipse binning to achieve consistent fixture-to-fixture color

Color Stability:

LED color temperature is warranted to shift no more than 200K in CCT over a 5 year period

Color Uniformity:

RAB's range of CCT (Correlated Color Temperature) follows the guidelines of the American National Standard for Specifications for the Chromaticity of Solid State Lighting (SSL) Products, ANSI C78.377-2017.

Construction

IES Classification:

The Type IV distribution (also known as a Forward Throw) is especially suited for mounting on the sides of buildings and walls, and for illuminating the perimeter of parking areas. It produces a semiCircular distribution with essentially the same candlepower at lateral angles from 90° to 270°.

Housing:

Precision die cast aluminum housing, lens frame

Gaskets:

High temperature silicone

Effective Projected Area:

EPA = 0.27.

Finish:

Formulated for high-durability and long lasting color

Green Technology:

Mercury and UV-free. RoHS compliant components. Polyester powder coat finish formulated without the use of VOCs or toxic heavy metals.

Ambient Temperature:

Suitable for use in 40°C (104°F) ambient temperatures

Cold Weather Starting:

Minimum starting temperature is -40°C (-40°F)

Other

Patents:

The ALED design is protected by U.S. PATENT D608,040 and patents pending in the U.S., Canada, China, Taiwan and Mexico.

Equivalency:

Equivalent to 70W Metal Halide

Warranty:

RAB warrants that our LED products will be free from defects in materials and workmanship for a period of five (5) years from the date of delivery to the end user, including coverage of light output, color stability, driver performance and fixture finish.

Buy American Act Compliance:

RAB values USA manufacturing! Upon request, RAB may be able to manufacture this product to be compliant with the Buy American Act (BAA). Please contact customer service to request a quote for the product to be made BAA compliant.

Optical

BUG Rating:

B1 U0 G0

RCRBD
Record Set

Dimensions

Technical drawings of the ALED26Y/PC light fixture showing front, side, and detail views with dimensions in inches and millimeters.

Features

- High output LED light engine
- Maintains 70% of initial lumens at 100,000 hours
- Weatherproof high temperature silicone gaskets
- Superior heat sinking with die cast aluminum housing and external fins

RCRBD
Record Set

Family	Wattage	Color Temp	Finish	Photocell	Dimming
ALED	26 = 26W	Blank = 5000K (Cool) Y = 3000K (Warm) N = 4000K (Neutral)	Blank = Bronze W = White	Blank = No Photocell /PC = 120V Button /PC2 = 277V Button	Blank = No Dimming /D10 = Dimmable