

ROUTT COUNTY
ROAD & BRIDGE
 P. O. Box 773598
 Steamboat Springs, CO 80477
 Phone: 970-879-0831
 Fax: 970-879-3992

Permit Application

Type of permit applied for:

Grading and Excavating ☐
 Cattle Guard Installation ☐
 Adopt A Highway ☐
 other ☐

Driveway ☐
 Special Event ☐
 Plow ☐

Utility Installation ☐
 Oversize/Overweight ☐
 Work in Right-of Way ☒

Property Information

Project physical address: 40.076185, -106.9373396
 Parcel Number: _____ City: Nearest town Toponas
 Section(s): _____ Township: _____
 Area to be disturbed: 10 x 10 square

Owner/Applicant Information

Applicant/contractor: Jake Haskins - X Field Services
 Mailing Address: PO Box 1313 City: Craig State: CO Zip: 81626
 Phone number: 970-629-2233 Email: jake@xfieldservice.com
 Property Owner: Upper Yampa Water Conservancy District
 Mailing Address: PO Box 775529 City: Steamboat Springs State: CO Zip: 80477
 Phone Number: 970-871-1035 Email: arossi@upperyampawater.com
 Contractor Name: X Field Services, LLC Phone number: 970-629-2233

Project Description:

Replacing a failing culvert for the Upper Yampa Water, on RCR 3B it will be a 10x10 square in the road. Please see the specs for the project as well as the map of location.

Work in right-of-way

(Acctg # 03.00.06.000.5670)

Permit Needed: For work in right-of-way or within public roads that does not meet criteria for grading and excavating or utility permit. Includes driveway permits.

Permit Application shall include:

- ☒ Site Plan/design (either CAD drawings or hand drawn to scale)
- ☐ Approximate length of boring/cutting; approximate length of road cut or ROW occupancy, volume of disturbance calculations
- ☐ Location, Parcel ID number, address

Permit Process:

1. Submit complete permit application to the County Road & Bridge Department offices at 136 6th Street, between the hours of 7:30 am and 4:30 pm.
2. R & B reviews application and inspects site.
3. Revisions are made by applicant if needed.
4. R & B re-reviews and re-inspects if needed.
5. If acceptable application is approved
6. Applicant pays fee and permit issued.
7. Applicant conducts work in accordance with plans, maintains erosion control, and updates SWMP as needed.
8. R & B inspects completed work
9. If erosion, re-vegetation and structural measures are met, permit is closed

Fee Calculation:

Standard ROW work or utilization\$65.00

May be subject to grading and excavating and utility installation fees.

UPPER YAMPA WATER CONSERVANCY DISTRICT 2020 STILLWATER DITCH IMPROVEMENTS

Construction Drawings 26 JUNE 2020

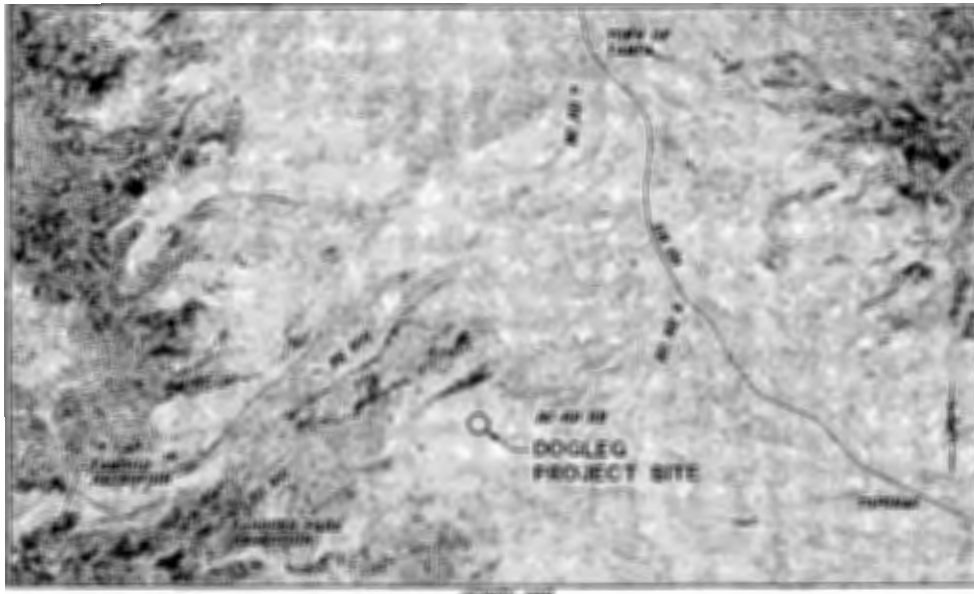

NOT TO SCALE

DRAWING INDEX

C-000	COVER
C-001	GENERAL NOTES & LEGEND
C-101	DOGLEG BIFURCATION EXISTING CONDITIONS & DEMOLITION PLAN
C-102	DOGLEG BIFURCATION SITE PLAN
C-201	DOGLEG BIFURCATION STRUCTURE PLAN AND ELEVATIONS
C-301	STILLWATER DITCH CROSS SECTIONS
C-501	EROSION CONTROL DETAILS
C-502	GENERAL DETAILS

OWNER:
Upper Yampa Water Conservancy District
P.O. Box 775529
Steamboat Springs, CO 80477
(970) 871-1035

SURVEYOR:
Four Points Surveying & Engineering
P.O. Box 775966
Steamboat Springs, CO 80477
(970) 871-6772

HORIZONTAL DATUM: NAD 83, CO-N
VERTICAL DATUM: NAVD 88

Copyright © CIVIL DESIGN CONSULTANTS, INC. 2020

Civil Design Consultants, Inc.
Civil and Environmental Engineers
2130 River Drive, Suite 200
Steamboat Springs, CO 80487
Tel (970) 879-3022

PROJECT: 2020 STILLWATER DITCH IMPROVEMENTS
SHEET: 001 OF 10
DATE: 6/26/20
DRAWN BY: J. H. HARRIS
CHECKED BY: J. H. HARRIS
NOT FOR CONSTRUCTION SET

1. BASE MAP PLANNIMETRICS AND TOPOGRAPHY PROVIDED BY FOUR POINTS SURVEYING AND ENGINEERING INC., STEAMBOAT SPRINGS, CO.
2. THESE DRAWINGS DO NOT INCLUDE PROVISIONS FOR JOBSITE SAFETY. JOBSITE SAFETY IS THE RESPONSIBILITY OF THE CONTRACTOR.
3. ALL TRAFFIC CONTROL DEVICES SHALL BE PER "MANUAL OF UNIFORM TRAFFIC CONTROL DEVICES", LATEST EDITION.
4. WHERE REFERENCED, "DOT STANDARDS" SHALL BE THE LATEST EDITIONS OF:
 - A. CDOT STANDARD PLANS, WAS STANDARDS, AND/OR
 - B. CDOT STANDARD SPECIFICATIONS FOR ROAD AND BRIDGE CONSTRUCTION

1. CONTRACTOR SHALL OBTAIN A GRADING AND EXCAVATION PERMIT AS APPLICABLE.
2. CULVERT LOCATIONS AND INVERTS ARE APPROXIMATE. CONTRACTOR SHALL CONFIRM THAT CULVERTS MATCH FIELD CONDITIONS AND THAT A MINIMUM 12" COVER IS PROVIDED TO DESIGN FINISH GRADE. CONSTRUCT GRADUAL TRANSITION DITCHES IN AND OUT OF CULVERTS AS REQUIRED.

1. STAKING OF THE WORK SHALL BE PROVIDED BY THE CONTRACTOR, UNLESS INDICATED OTHERWISE. THE ENGINEER WILL PROVIDE AN APPROVED STAKING PLAN. THE CONTRACTOR SHALL BE RESPONSIBLE IN ADDITION TO THE HARD COPY DOCUMENTS, SUCH AS THE CONTRACT MAY NOT SHOW ALL ITEMS REQUIRED TO BE STAKED.
2. IN THE EVENT OF A CONFLICT BETWEEN THE ELECTRICAL (CABLE) FILE AND THE CIVIL FILE, THE ELECTRICAL FILE SHALL TAKE PRECEDENCE. DRAWINGS AND SPECIFICATIONS SHALL GOVERN THE AVAILABILITY AND SEQUENCE OF WORK. THE CONTRACTOR SHALL BE RESPONSIBLE FOR THE PROPER CHECKING AND COORDINATION OF DIFFERENT DISCIPLINES. THE CONTRACTOR SHALL BE RESPONSIBLE FOR COMPLETE AND ACCURATE COMPLETION OF THE WORK.
3. DO NOT STATE USING CONTOUR LINES, GRADES SHOULD BE DETERMINED FROM SPOT ELEVATIONS AND NOTED ELEVATIONS ON CONSTRUCTION DETAILS.
4. FOR STAKING OF CATCH BASINS AND LINTS; CONTRACTOR AND/OR SURVEYOR IS RESPONSIBLE FOR DETERMINING STRUCTURE LOCATION AND ELEVATION. THE ENGINEER WILL PROVIDE THE REQUIRED DATA.
5. DIMENSIONS LISTED ON DRAWINGS AND NOTED DIMENSIONS OR WORKING TOLERANCE PRECEDENCE OVER SCALED DIMENSIONS.

THE REQUIRED MAINTAIN PERMANENT STORMWATER MANAGEMENT PRACTICES ARE SHOWN AND NOTED ON THE DRAWINGS. SOME TEMPORARY MEASURES MAY BE REQUIRED TO MAINTAIN THE PERMANENT MEASURES AND SUPPLEMENTARY MEASURES SHOWN ARE NECESSARY TO SATISFY STORMWATER PLAN AND PERMITTING REQUIREMENTS.

2. CONTRACTOR SHALL OBTAIN A STORMWATER DISCHARGE PERMIT FROM THE STATE OF CALIFORNIA PRIOR TO ANY CONSTRUCTION. THE CONTRACTOR MAY SUPPLEMENT THE INFORMATION PROVIDED ON THESE DRAWINGS AND SPECIFICATIONS AS NECESSARY FOR PREPARATION OF A PERMIT. THE CONTRACTOR SHALL BE RESPONSIBLE TO OBTAIN THE PERMIT. THE CONTRACTOR SHALL HAVE NO DUTY OR RESPONSIBILITY WITH RESPECT TO PREPARATION OF THE PERMIT.

3. ALL DRAINAGE SWALES SHALL BE GRASS-LINED EXCEPT RIPPAP OR GEOTEXTILE CHANNEL LINING SHALL BE PROVIDED WHERE INDICATED.

4. ALL DISTURBED AREAS NOT RECEIVING FINISH GRADE OR LANDSCAPE TREATMENT SHALL RECEIVE TOPSOIL, REPLACEMENT AND NATIVE GRASS SEEDING WITHIN A MINIMUM OF 90 DAYS AFTER CONSTRUCTION IS NOTED OTHERWISE. REVEGETATION SHALL OCCUR AS SOON AS FEASIBLE.

5. CONTRACTOR SHALL MAINTAIN EROSION AND SEDIMENT CONTROL MEASURES UNTIL ESTABLISHMENT OF REVEGETATION TO THE SATISFACTION OF THE LOCAL JURISDICTION. CONTRACTOR SHALL MAINTAIN RECORDS OF CONTROL MEASURES WHICH HAVE OUTLIVED THEIR USEFULNESS AT FINAL ACCEPTANCE.

6. ALL CONTROLS SHALL BE INSTALLED AS EARLY AS PRACTICAL. DO NOT ALLOW PERIMETER CONTROLS SHALL BE INSTALLED PRIOR TO STRIPPING AND STOCKPILING. ALL CONTROLS SHALL BE MONITORED DURING CONSTRUCTION AND MAINTAINED THROUGHOUT CONSTRUCTION TO THE ONSET OF WINTER, NO LATER THAN OCTOBER 31ST OF ANY YEAR.

[illegible][illegible]

Date: 4/27/20	Copyright CIVIL DESIGN CONSULTANTS, INC. 2020 UPPER YAMPA WATER CONSERVANCY DISTRICT 2020 STILLWATER DITCH IMPROVEMENTS GENERAL NOTES & LEGEND Civil Design Consultants, Inc. Civil and Environmental Engineers 2118 Sunset Drive, Suite 100 Steamboat Springs, CO 80413 Tel: 970-676-5252
Drawn: MM	
Designed: MM	
Scale: As Noted	
Sheet No. 329.010F Sheet No. C-001	

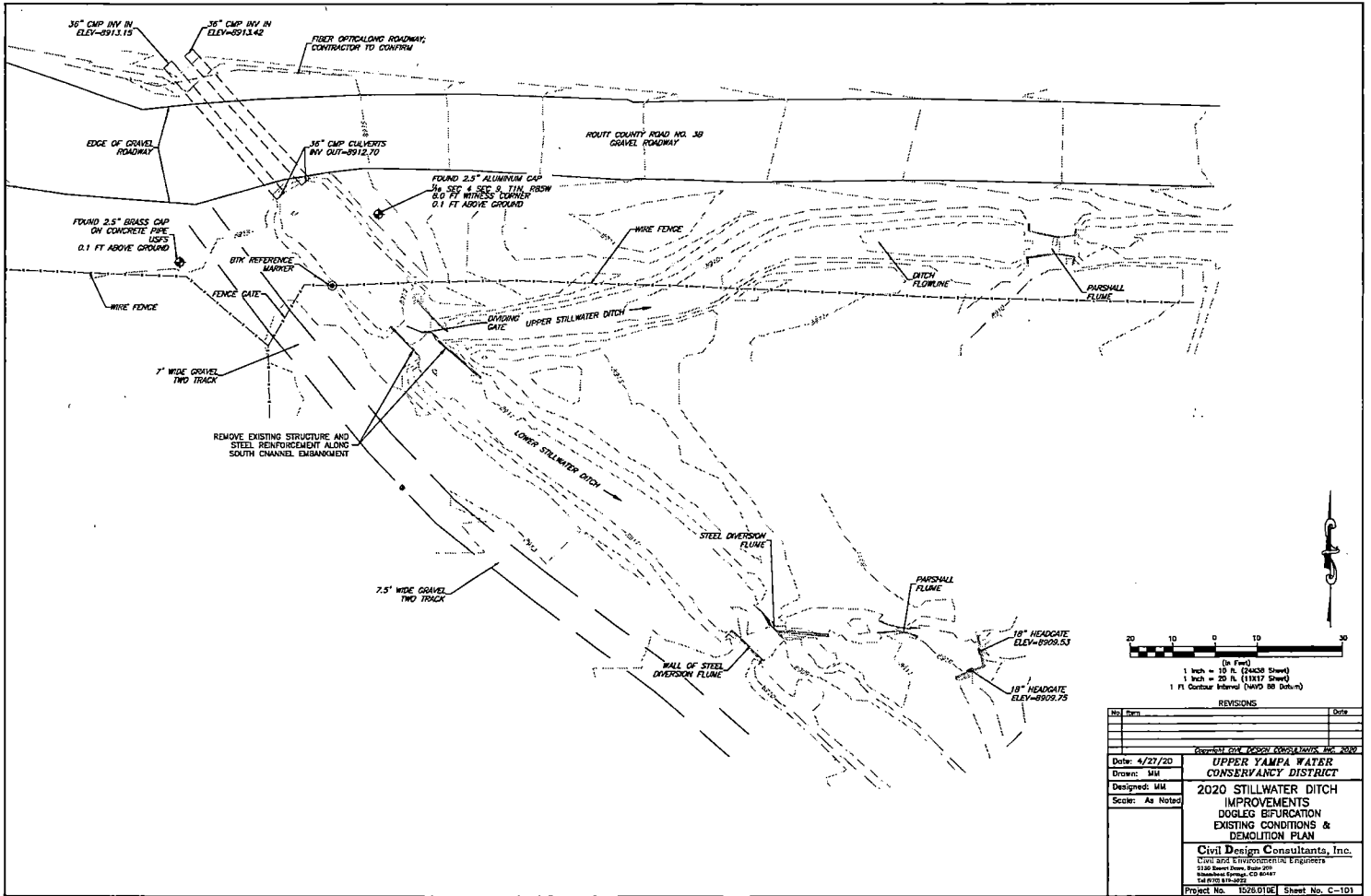

REVISIONS	
No.	Date

Date: 4/27/20 Drawn: MHL Designed: MHL Scale: As Noted		Approved: M. H. L. M. H. L. & ASSOCIATES, INC. 2120 River Drive, Suite 200 Bend, Oregon 97701 Phone: 503/325-4444 Fax: 503/325-4445
Project No. 1028.0106 Sheet No. C-101		UPPER YAMPA WATER CONSERVANCY DISTRICT 2020 STILLWATER DITCH IMPROVEMENTS DOGLEG BIFURCATION EXISTING CONDITIONS & DEMOLITION PLAN

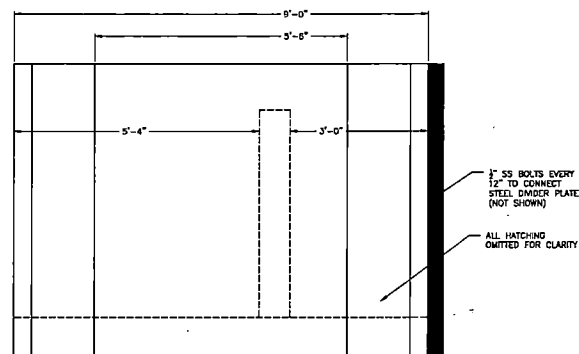

SIDE ELEVATION
SCALE: 1" = 1' (24X38)
1" = 3' (11X17)

12" OF COMPACTED 1½"
GRAVEL BENEATH STRUCTURE

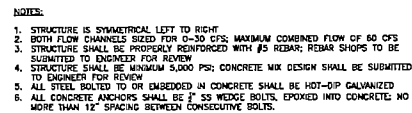

PLAN VIEW
SCALE: 1" = 1' (24X36)
1" = 2' (11X17)

No. _____		Date _____	
<p align="center">REVISIONS</p>			
<p align="center"><i>Copyright © 2004 CIVIL CONSULTANTS, INC. 2004</i></p>			
5/25/2020		UPPER YAMPA WATER CONSERVANCY DISTRICT	
Drawn: MM		2020 STILL WATER DITCH IMPROVEMENTS	
Designed: MM		DOGLE BIFURCATION STRUCTURE PLAN AND ELEVATION	
Scaled: As Noted		Civil Design Consultants, Inc. Civil and Environmental Engineers 3139 South First, Suite 200 Steamboat Springs, CO 80487 Tel: 970-879-0223	
Project No.		157510101	Sheet No. C-201

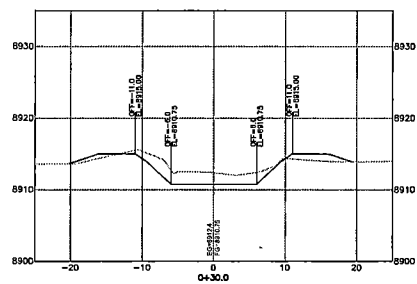
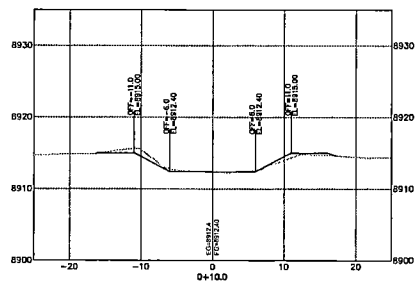
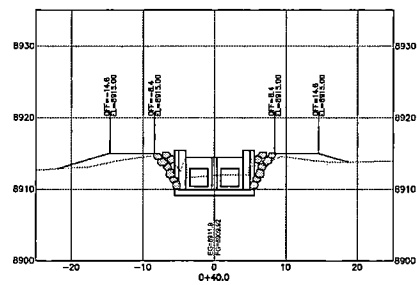
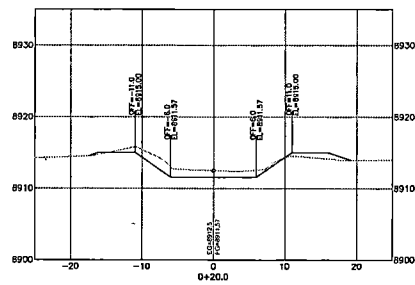

STILLWATER DITCH SECTIONS AT DOOLEY

REVISIONS	
No.	Date

Date: 5/25/20	UPPER YAMPA WATER CONSERVANCY DISTRICT
Drawn: LM	2020 STILLWATER DITCH IMPROVEMENTS
Designed: MM	STILLWATER DITCH CROSS SECTIONS
Scale: As Noted	Civil Design Consultants, Inc.
	Civil and Environmental Engineers
	2148 South 17th, Suite 200
	Flagstaff, AZ 86001
	Phone: (928) 779-1000
	Project No. 1526-0106 Sheet No. C-301

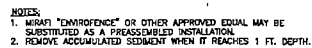
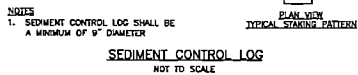

SILT FENCE
NOT TO SCALE

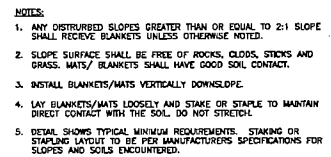

EROSION BLANKETS / TURF REINFORCEMENT MATS
SLOPE INSTALLATION
NOT TO SCALE

REVISIONS		
No.	Item	Date

Date: 4/27/20	Upper Yampa Water Conservancy District
Drawn: MM	2020 STILLWATER DITCH IMPROVEMENTS
Designed: MM	EROSION CONTROL DETAILS
Scale: As Noted	Civil Design Consultants, Inc. Civil and Environmental Engineers 2100 South Durango Blvd. Durango, CO 81301 Tel: 970.257.5077
	Project No. 1529 0101 Sheet No. C-501

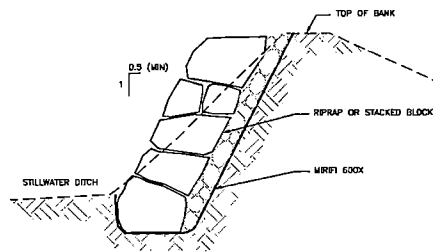

TYPICAL BANK STABILIZATION SECTION
NOT TO SCALE

REVISIONS		
No.	Rev.	Date

6/25/2020	Consolidated 020201.02504/2020, 02020
Drawn: MM	UPPER YAMPA WATER CONSERVANCY DISTRICT
Designed: MM	2020 STILLWATER DITCH IMPROVEMENTS
Scale: As Noted	GENERAL DETAILS
Civil Design Consultants, Inc. Civil and Environmental Engineers 2120 South Main, Suite 200 Steamboat Springs, CO 80413 Tel: 970.676.2922	
Project No. 1525.0101 Sheet No. C-502	

Still water project

Write a description for your map.

Legend

43.078135, -106.937396

