



Elk Stone Farms Yoga Deck
Strawberry Park
Steamboat Springs, CO

GENERAL STRUCTURAL NOTES

DESIGN LIVE & SNOW LOADS

- a. UNCOVERED DECK.....100 psf (Gymnasium)
- b. WIND.....110 mph Exp B
- c. SEISMIC..... $S_s=0.26g$ $S_1=0.068g$ Group I Category II

GOVERNING SPECIFICATION

International Building Code (IBC) 2018 Edition

FOUNDATION DESIGN

- a. The foundation design is based on a max bearing pressure of 25000 psf. This value is assumed, to be verified by the soils engineer at excavation.
- b. The owner should consult the soils engineer for limitations and risks.
All soils issues should be addressed to the soils engineer. The owner or his representative are responsible for following the soils report, contacting the soils engineer, and following their recommendations.
- c. The structural design drawings are for the internal structure and permanent foundation only. Detached retaining walls including rock retaining walls are by others. The structural engineer is not responsible for non-structural issues such as insulation, frost protection, drainage, moisture, condensation, mold, water issues, soils issues, or construction methods.
The structural engineer is responsible for structural design only and does not include non-structural work such as water or weather proofing, insulation, drainage, frost, snow or ice buildup, plumbing, soils issues, or construction methods. The structural engineer's duties are limited to design only and is not a project engineer.

STRUCTURAL WOOD FRAMING

- a. Except where noted otherwise all lumber shall be Douglas Fir-Larch No. 2 or better.
- b. Except as noted otherwise minimum nailing shall be provided as specified in Table 2304.10.1 Fastener Schedule of the IBC 2018 edition.
- d. Where light gage framing anchors are shown or required they shall be Simpson "Strong Tie" or equal ICBO approved connectors and shall be installed with the number and type of nails recommended by the manufacturer to develop the rated capacity.
- e. Glue laminated timber shall be of such stress grade to provide glue laminated beams with combination symbol 24F-V4. Beams in cantilevered or reverse bending shall be 24F-V8.

CONCRETE

- a. Concrete to have a minimum compressive strength of 3000 psi and be reinforced with Grade 60 bar except as noted on drawing.
- b. All bars continuous unless noted. Additional lap splices permitted with written approval only. All splices to be a minimum of 38 bar diameters.

STRUCTURAL STEEL

- a. All bolts, including anchor bolts, shall conform to ASTM Specification A307.
- b. Structural steel rolled shapes, including plates and angles shall be ASTM A36. Tube shapes shall conform to ASTM A500 Grade B, 46 ksi yield. Pipe shapes shall conform to ASTM A53 Grade B.
- c. Except as noted, epoxy bolts shall be Type SET or equal with the following minimum embedments: 5/8" dia: 3", 3/4" dia: 4", UNO.
- c. Except as noted, all tiedowns to concrete shall be secured with 5/8" epoxy bolt.

GENERAL

The contract structural drawings and specifications represent the finished structure. They do not indicate the method of construction. The contractor shall provide all measures necessary to protect the structure during construction. Such measures shall include, but not be limited to bracing and shoring for loads due to excavation, sliding soil, or construction equipment. Observation visits to the site by the design professionals shall not include inspection of the above items, nor will the design professionals be responsible for the contractor's means, methods, techniques, sequences for procedure of construction, or the safety precautions and the programs incident thereto.

Elk Stone Farms



STRUCTURE ONLY

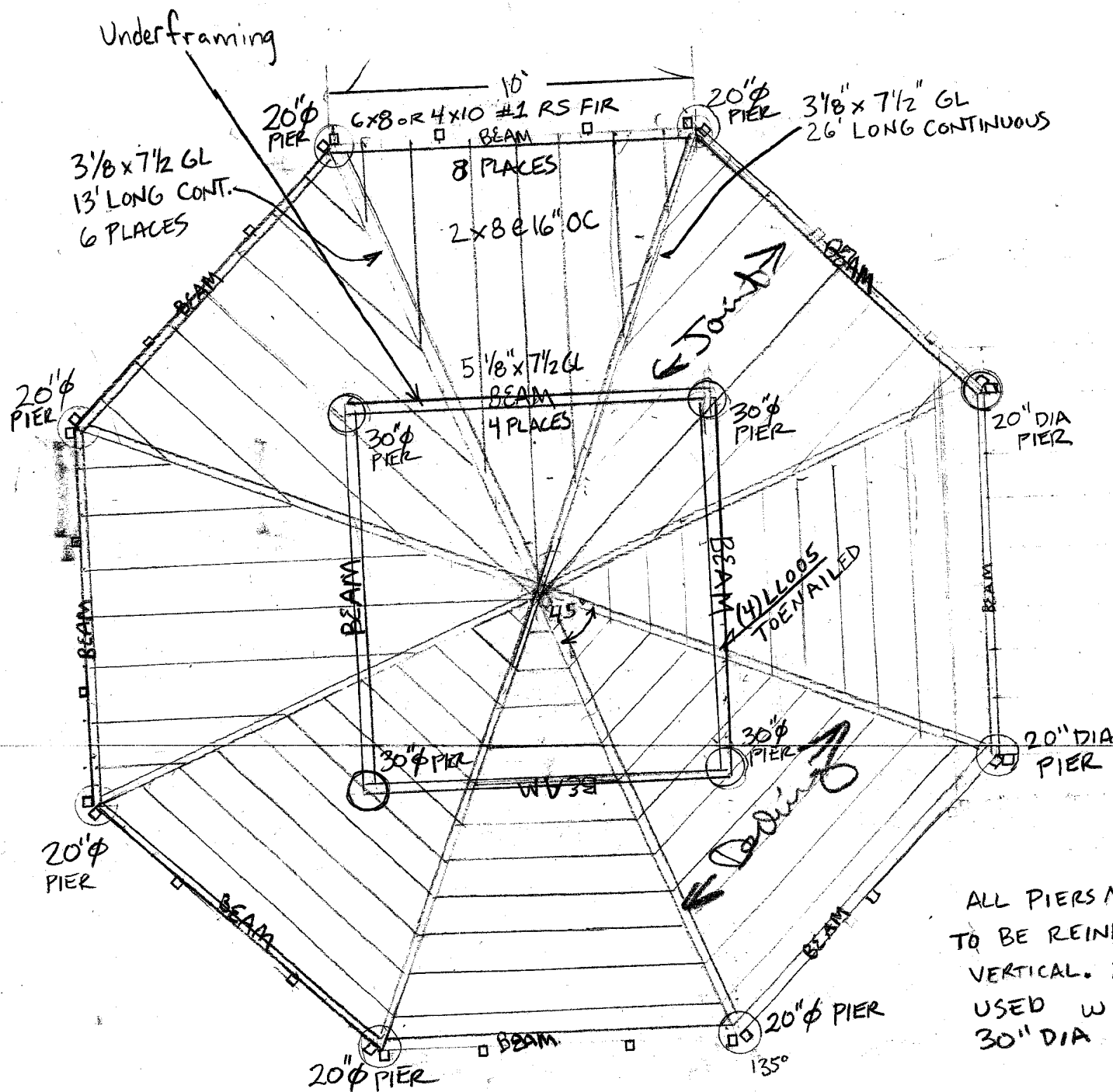

ALL PIERS MAY HAVE 12" DIA CAP AND TO BE REINFORCED WITH (6) #4 BARS VERTICAL. 24" DIA DRILL MAY BE USED WITH HAND DUG BELL TO 30" DIA WHERE REQUIRED.

CENTER BEAM CONNECTION

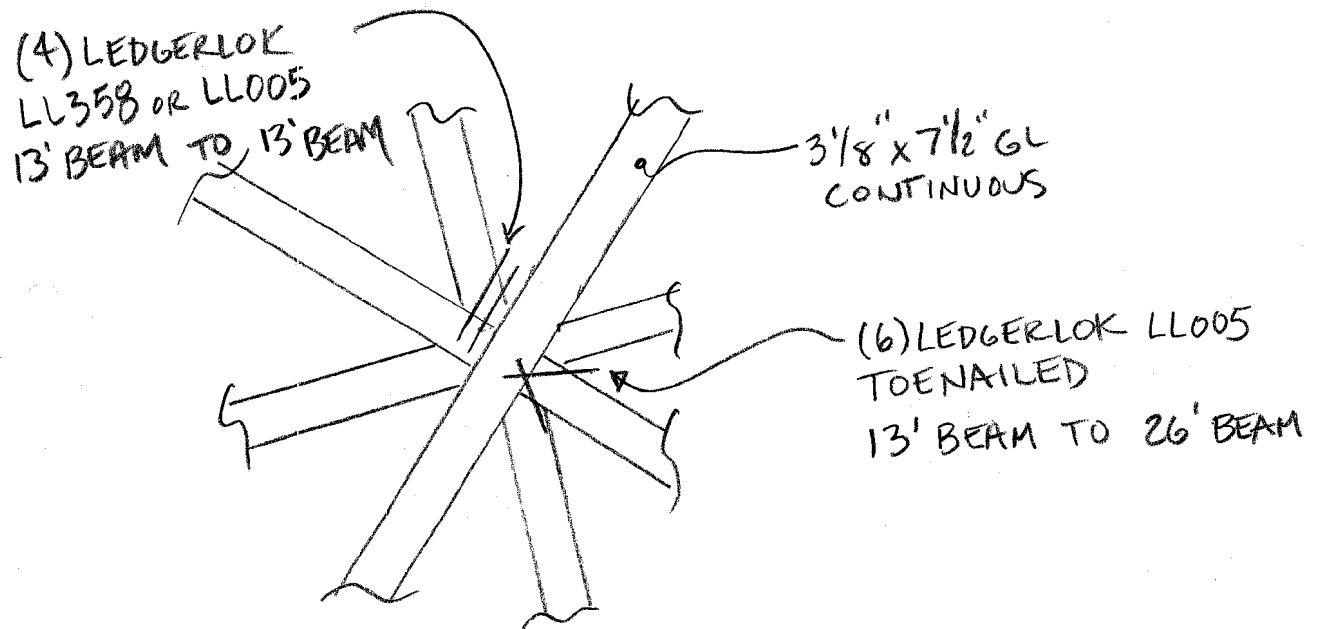

4 CORNERS

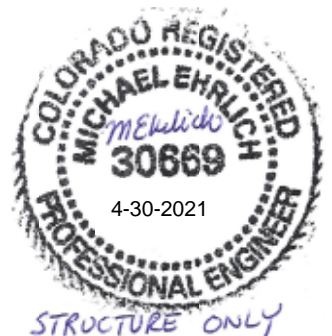
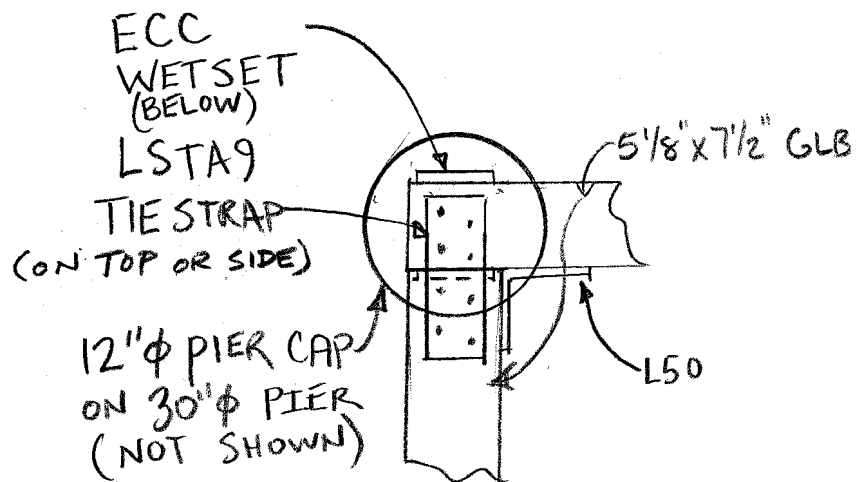

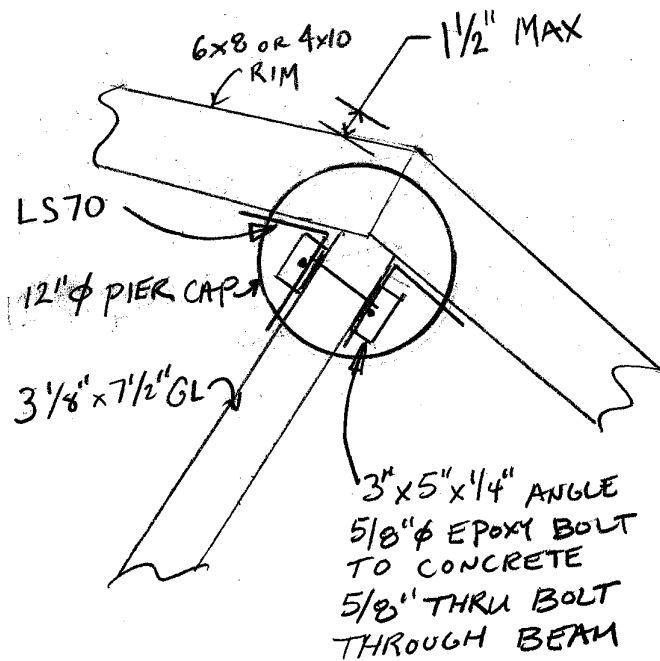

OUTER

