

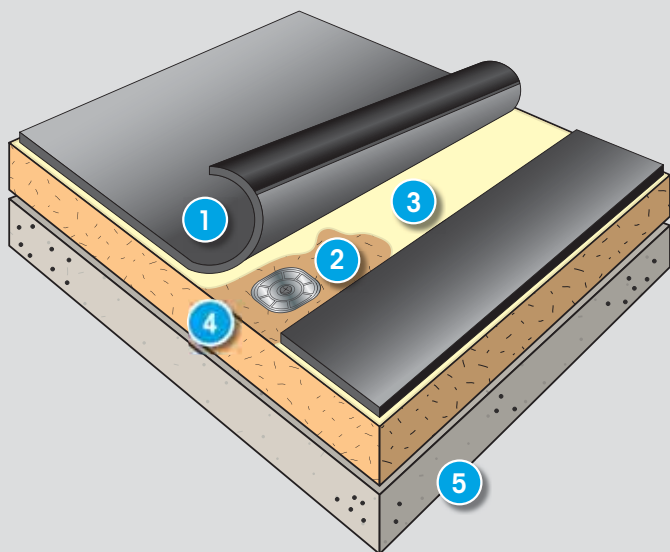

Fully Adhered Roofing System



Typical Application

- 1 VersiGard® EPDM Membrane with QAT
- 2 Versico Fasteners and Plates
- 3 Versico EPDM Bonding Adhesive
- 4 Acceptable Insulation
- 5 Approved Roof Deck

Colors	Black and White
Standard Thicknesses	45-, 60- and 90-mil
Standard Widths	10' - 30'
Standard Lengths	50' - 200'

System Features and Benefits

- 50 years of proven performance
- In colder climates, dark-colored EPDM reduces heating costs
- Industry-leading UV resistance of 41,580 kJ/m²
- Full thickness of weathering material, no internal scrim
- 465% elongation offers superior hail damage resistance
- Lowest global warming potential, acid rain and smog impact according to EPA's TRACI model
- Zero (no growth) rating for fungal growth
- Full line of Quick-Applied accessories
- Lightweight requirements
- No slope restrictions

Installation

Versico's VersiGard fully adhered roofing system utilizes 45-, 60- and 90-mil non-reinforced membranes. Additionally, VersiGard white membranes may also be utilized to meet ENERGY STAR®, Title 24 and CRRC requirements, and contribute toward LEED® credits.

Insulation is either mechanically fastened to the roof deck every 2 square feet, adhered with DASH™ Adhesive or set into hot asphalt. Membrane is adhered to the insulation with Versico Approved Bonding Adhesive. Adjoining sheets of EPDM are spliced together a minimum of 3" using Versico's EPDM Primer and Quick-Applied Seam Tape or VersiGard EPDM with Quick-Applied Tape (QAT) seam technology.

The above information represents a typical Versico Fully Adhered Roofing System. Refer to Versico's published specifications and details for more complete information.





System Codes

- UL Class A, B and Universal Slope ratings are available over most deck types.
- FM uplift ratings up to 1-120 are available.

For code specifics, refer to Versico's Code Approval Guide.

Quality Assurance

Versico Authorized Contractors have been trained to install Fully Adhered Roofing Systems

Inspection

Upon installation completion, and prior to the issuance of a system warranty, an inspection will be conducted by a Versico Field Service Representative.



Warranty

Consult your Authorized Contractor, Versico Independent Sales Representative or Distributor for associated warranty charges.

Provided all materials are manufactured or marketed by Versico, this system properly installed and inspected on a commercial project may receive:

	5-Year	10-Year	15-Year	20-Year	25-Year	30-Year
45-Mil	X	X	X			
60-Mil	X	X	X	X	X	
90-Mil	X	X	X	X	X	X

- 55-mph maximum peak gust wind speed coverage is standard. Additional coverage up to 120-mph is available
- A 1" hail warranty is available with 60-mil EPDM and a 2" hail warranty is available with a 90-mil EPDM
- A 40-year non-prorated membrane material warranty is available with 90-mil black EPDM
- Warranty for systems incorporating Versico's 90-mil membrane can include coverage for damage caused by accidental punctures.

For more specifics on warranty programs, please contact Versico.

Existing or New Deck Type	New Construction						Re-roofing		
	Steel	Plywood or OSB	Lt. Wt. Concrete	Structural Concrete	Wood Planks	Gypsum & Fibrous Cement	Smooth-Surface BUR	Gravel-Surfaced BUR	Existing Single-Ply
Insulation Required	YES	No	*Refer to Specs	No	No	YES	No	YES	YES
Recommended Insulations	Versico Polyiso, OSB, SecurShield HD or SecurShield HD over Polystyrene						← Refer to New Construction		
Insulation Attached By	DASH™ Adhesive (Non-Penetrating) or Versico Fasteners and Plates						← Refer to New Construction		
Membrane Attached By	Versico Approved EPDM Bonding Adhesive						← Refer to New Construction		

FOR TEAR-OFF OPTIONS REFER TO NEW CONSTRUCTION ABOVE.

For current code approvals and warranties, visit Versico's web site or contact a design analyst.

* Refer to Versico's current specifications for requirements.



A SINGLE SOURCE FOR SINGLE-PLY ROOFING

800.992.7663 • www.versico.com