



Routt County Assessor's Office, Property Search

Routt County Assessor's Office, Property Search

R4177365
57640 MINERS DREAM PL

Owner: DOWNER, SUSAN Q. (ETAL)
10710 39TH AVE N.
PLYMOUTH, MN 55441

Actual Value
\$329,070

KEY INFORMATION

Account #	R4177365	Parcel #	160700118
Tax Area	17 - *RE2* STEAMBOAT LAKE-WILLOW PASS AREAS		
Aggregate Mill Levy	69.793		
Neighborhood	335 - WILLOW POINT		
Subdivision	STEAMBOAT LAKE SUBD 1		
Legal Desc	LOT 118 STEAMBOAT LAKE SUBD UNIT NO. 1, TOTAL: 1.03 AC		
Property Use	RESIDENTIAL SINGLE FAMILY		
Total Acres	1.03		
Owner	DOWNER, SUSAN Q. (ETAL)		
Situs Addresses	57640 MINERS DREAM PL		
Total Area SqFt	1,680		
Business Name	-		

ASSESSMENT DETAILS

	Actual	Assessed
Land Value	\$66,950	\$4,530
Improvement Value	\$262,120	\$17,730
Total Value	\$329,070	\$22,260
Exempt Value	-	\$0
Adjusted Taxable Total	-	\$22,260

PUBLIC REMARKS

PUBLIC REMARK	PUBLIC REMARK DATE
SEC 10 & 15-9-85	1900-01-01 00:00:00
SUBD NAME SHOULD BE "STEAMBOAT LAKE SUBD UNIT NO. 1" PER PLAT, NOT FILING 1. ALL SUBSEQUENT PLATS ARE "FILING 2-9", THEREFORE CHANGED LEGALS ON PARCELS FROM THIS PLAT TO READ LOT # STEAMBOAT LAKE UNIT NO. 1. DW	2019-01-10 00:00:00
MAILING ADDRESS UPDATED PER NOTE ON BACK OF 2014 TAX BILL. INCLUDES R4177365, R0217531, R0217179. SH	2015-02-20 00:00:00

LAND DETAILS

LAND OCCURRENCE 1 - RES LAND

Property Code	1112 - SINGLE FAM RESID LAND	Economic Area	OUTLYING AREAS
Super Neighborhood	RURAL NORTH	Neighborhood	335 - WILLOW POINT
Land Code	STEAMBOAT LAKE W&S 1 - 4.99 AC	Land Use	PRIME SITE
Zoning	LDR	Site Access	YEAR-ROUND
Road	GRAVEL	Site View	GOOD
Topography	SLOPING	Slope	MODERATE
Wetness	MODERATE	Water	COMM/PUBLIC
Utilities	ELECTRIC	Sewer	COMM/PUBLIC
Acres	1.03	Description	-

BUILDINGS

RESIDENTIAL BUILDING DETAILS

RESIDENTIAL IMPRV OCCURRENCE 1

Property Code	1212 - SINGLE FAM RESID IMPROVEMENTS	Economic Area	-
Neighborhood	335 - WILLOW POINT	Building Type	2 & 3 STORY
Super Neighborhood	RURAL NORTH	Stories	2.00
Actual Year Built	1973	Remodel Year	-
Effective Year Built	1973	Architectural Style	CONTEMPORARY
Grade / Quality	AVERAGE	Frame	WOOD
Basement Type	NONE/SLAB	Garage Capacity	1
Total Rooms	7	Bedrooms	3
Bath Count	2.00	Kitchen Count	1
Fireplace Count	1	Fireplace Type	ZERO C FP
Roof Style	GABLE	Roof Cover	WOOD SHK
Exterior Condition	NORMAL	Heating Fuel	ELECTRIC
Heating Type	ELEC BSBD	Interior Condition	NORMAL
Total SQFT	1,680	Bldg Permit No.	-
Above Grade Liv. SQFT	1,680	Percent Complete	-
Permit Desc.	-	Functional Obs	-

EXTRA FEATURES / OUTBUILDINGS

FEATURE 1

Description	GAR,1 STORY ATT	Actual Year Built	1973
Quality	AVERAGE	Effective Year Built	1973
Condition	NORMAL	Actual Area	336
Permit No.	-	Percent Complete	-
Permit Desc.	-		

TRANSFER HISTORY

	RECORDING DATE	REC. #	BOOK	PAGE	DEED TYPE	SALE DATE	SALE PRICE
+	12/28/1993	431150	692	2203	QCD	12/28/1993	\$0
	Appraiser Public Remarks	-					
	Grantor	OLSCHNER, PAUL Q & RENA W (JT)					
	Grantee	-					
+	09/26/1991	404876	666	1496	QCD	09/26/1991	\$0
	Appraiser Public Remarks	-					
	Grantor	OLSCHNER, RENA W					
	Grantee	OLSCHNER, RENA W & PAUL Q (JT)					
+	04/10/1987	361934	625	341	QCD	04/03/1987	\$0
	Appraiser Public Remarks	-					
	Grantor	-					
	Grantee	-					
+	03/30/1972	232221	357	721	WD	02/23/1972	\$5,415
	Appraiser Public Remarks	-					
	Grantor	-					
	Grantee	-					
+	02/28/1972	231231	-	-	WD	02/23/1972	\$6,415
	Appraiser Public Remarks	-					
	Grantor	-					
	Grantee	-					

TAX AUTHORITIES

TAX AREA	TAX AUTHORITY ENTITY	AUTHORITY TYPE	2022 LEVY BY ENTITY	2022 TAX AREA LEVY	ENTITY % OF TAX BILLS	ESTIMATED AD VALOREM TAX
17	COLORADO MOUNTAIN COLLEGE	Local District College	4.085	69.793	5.85%	\$91
17	COLORADO RIVER WATER CONSERVATION DISTRICT	Water Conservancy	0.501	69.793	0.72%	\$11
17	EAST ROUTT REGIONAL LIBRARY	Library Districts	3.075	69.793	4.41%	\$68
17	NORTH ROUTT FIRE PROTECTION DISTRICT	Fire Protection Districts	10.937	69.793	15.67%	\$243
17	ROUTT COUNTY GOVERNMENT	County	17.911	69.793	25.66%	\$399
17	STEAMBOAT LAKE WATER & SANITATION DISTRICT	Water and Sanitation Districts	6.661	69.793	9.54%	\$148
17	STEAMBOAT SPRINGS CEMETERY	Cemetery Districts	0.088	69.793	0.13%	\$2
17	STEAMBOAT SPRINGS SCHOOL DISTRICT (RE-2)	School Districts	24.715	69.793	35.41%	\$550
17	UPPER YAMPA WATER CONSERVATION DISTRICT	Water Conservancy	1.82	69.793	2.61%	\$41

PRIOR YEAR ASSESSMENT INFORMATION

YEAR	ACTUAL VALUE	ASSESSED VALUE	MILL LEVY	AD VALOREM TAXES
2022	\$214,470	\$14,900	69.79	\$1,040
2021	\$214,470	\$15,330	69.20	\$1,061
2020	\$192,040	\$13,730	69.22	\$950
2019	\$192,040	\$13,730	68.31	\$938
2018	\$181,920	\$13,100	67.47	\$884
2017	\$181,920	\$13,100	62.83	\$823
2016	\$153,770	\$12,240	59.89	\$733

Contact the Treasurer's Office for current property tax amount due. Do not use the figures above to pay outstanding property taxes.

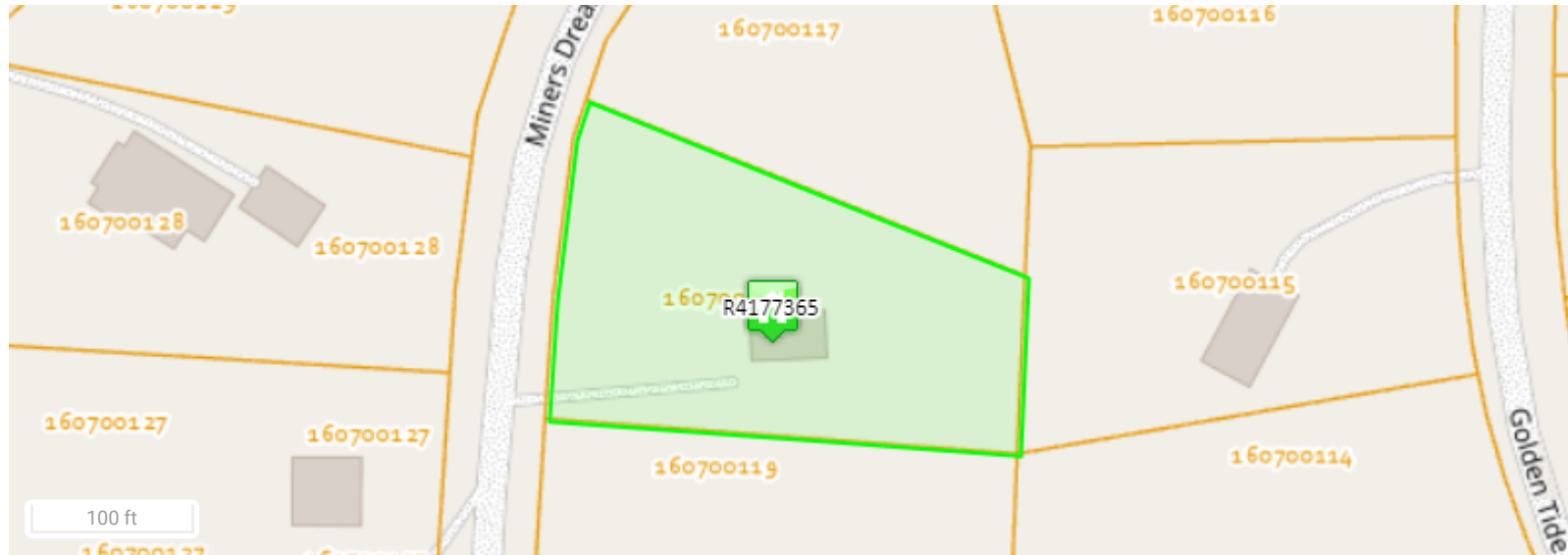

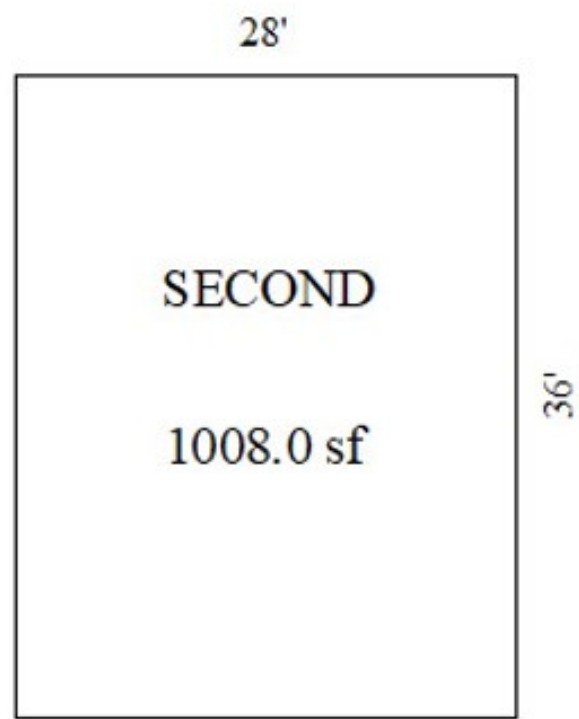
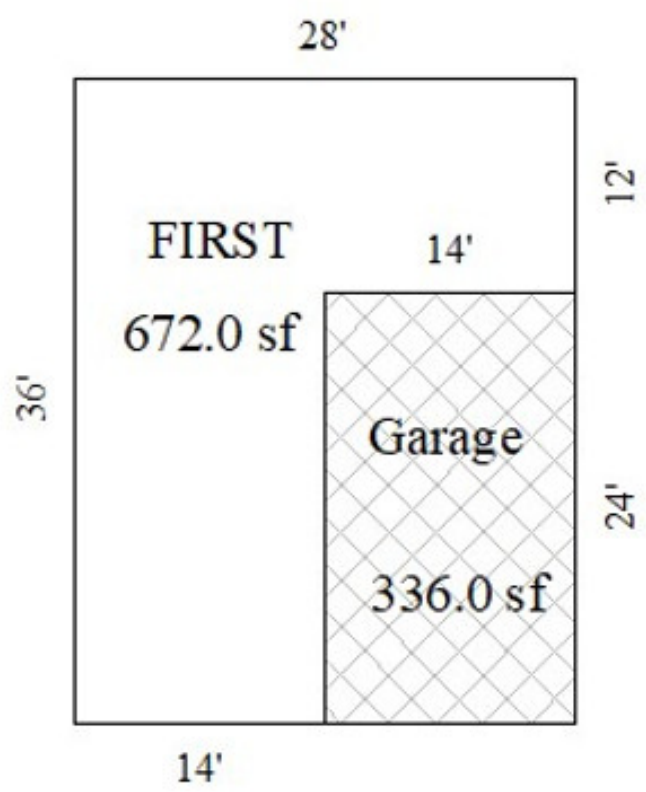

Illustrated by AgaveArchitects, LLC © 2023

Data last updated: 09/21/2023