



Routt County Assessor's Office, Property Search

Routt County Assessor's Office, Property Search

R8171372
34510 GOLDEN EAGLE DR

Owner: IRVINE, DAVID & ETHEL (JT)
PO BOX 451214
GROVE, OK 74345

Actual Value
\$2,142,070

KEY INFORMATION

Account #	R8171372	Parcel #	270400030
Tax Area	20AMR - *RE2* ALPINE MTN. RANCH SUBDV.		
Aggregate Mill Levy	67.622		
Neighborhood	ALPINE MOUNTAIN RANCH		
Subdivision	ALPINE MOUNTAIN RANCH LPSE		
Legal Desc	LOT 30, ALPINE MOUNTAIN RANCH LPSE, 5A		
Property Use	VACANT LAND		
Total Acres	5.00		
Owner	IRVINE, DAVID & ETHEL (JT)		
Situs Addresses	34510 GOLDEN EAGLE DR		
Total Area SqFt	-		
Business Name	-		

ASSESSMENT DETAILS

	Actual	Assessed
Land Value	\$2,142,070	\$597,640
Improvement Value	\$0	\$0
Total Value	\$2,142,070	\$597,640
Exempt Value	-	\$0
Adjusted Taxable Total	-	\$597,640

PUBLIC REMARKS

PUBLIC REMARK	PUBLIC REMARK DATE
3-5-84	2007-04-09 00:00:00
4/5/07 - NEW SUBDIVISION 1216.04AC (1174.18AC + 41.86AC BIA PER PLAT & GIS)FROM MULTIPLE ACCTS R8163109, R8163111,R8163126-30,R8163135, R8163099-101,R8163124,R8163134,R8163114,R8163136,R8163138-40, R8163096,R8163107,R8163125,R8163112,R8163098, R8163122, R	2007-04-09 00:00:00

LAND DETAILS

LAND OCCURRENCE 1 - RES LAND

Property Code	-	Economic Area	10 MILE
Super Neighborhood	E HWY40 FOOTHILLS & RAB-EARS P	Neighborhood	ALPINE MOUNTAIN RANCH
Land Code	ALPINE MTN RANCH - SUPERIOR	Land Use	PRIME SITE
Zoning	LPSE	Site Access	YEAR-ROUND
Road	PAVED	Site View	EXCELLENT
Topography	SLOPING	Slope	SLIGHT
Wetness	NOT AFFECTED	Water	COMM/PUBLIC
Utilities	PROP AND ELEC	Sewer	COMM/PUBLIC
Acres	5.00	Description	-

BUILDINGS

EXTRA FEATURES / OUTBUILDINGS

No data to display

TRANSFER HISTORY

	RECORDING DATE	REC. #	BOOK	PAGE	DEED TYPE	SALE DATE	SALE PRICE
+	10/15/2021	830690	-	-	GWD	10/13/2021	\$2,950,000
Appraiser Public Remarks	-						
Grantor	ALPINE MOUNTAIN RANCH AT STEAMBOAT SPRINGS LLLP						
Grantee	IRVINE, DAVID & ETHEL (JT)						
+	06/08/2021	825614	-	-	WD	06/04/2021	\$0
Appraiser Public Remarks	INCLUDES: R8171372 R8171374						
Grantor	EDEN PARK DRIVE ASSOCIATES LIMITED PARTNERSHIP						
Grantee	ALPINE MOUNTAIN RANCH AT STEAMBOAT SPRINGS, LLLP						
+	02/15/2008	670589	-	-	WD	02/13/2008	\$2,050,000
Appraiser Public Remarks	04/07 SOA#650153 AUTHORIZING ANDREW P DALY OR WILLIAM P BUTLER. KL						
Grantor	ALPINE MOUNTAIN RANCH AT						
Grantee	EDEN PARK DRIVE ASSOCIATES, LP						

COMMON AREAS

TAX AUTHORITIES

TAX AREA	TAX AUTHORITY ENTITY	AUTHORITY TYPE	2022 LEVY BY ENTITY	2022 TAX AREA LEVY	ENTITY % OF TAX BILLS	ESTIMATED AD VALOREM TAX
20AMR	ALPINE MOUNTAIN METRO DISTRICT	Metropolitan Districts	5	67.622	7.39%	\$2,988
20AMR	COLORADO MOUNTAIN COLLEGE	Local District College	4.085	67.622	6.04%	\$2,441
20AMR	COLORADO RIVER WATER CONSERVATION DISTRICT	Water Conservancy	0.501	67.622	0.74%	\$299
20AMR	EAST ROUTT REGIONAL LIBRARY	Library Districts	3.075	67.622	4.55%	\$1,838
20AMR	ROUTT COUNTY GOVERNMENT	County	17.911	67.622	26.49%	\$10,704
20AMR	STEAMBOAT SPINGS AREA FIRE PROTECTION DISTRICT	Fire Protection Districts	9.427	67.622	13.94%	\$5,634
20AMR	STEAMBOAT SPRINGS CEMETERY	Cemetery Districts	0.088	67.622	0.13%	\$53
20AMR	STEAMBOAT SPRINGS SCHOOL DISTRICT (RE-2)	School Districts	24.715	67.622	36.55%	\$14,771
20AMR	UPPER YAMPA WATER CONSERVATION DISTRICT	Water Conservancy	1.82	67.622	2.69%	\$1,088
20AMR	YAMPA VALLEY HOUSING AUTHORITY	Housing Authorities (Municipal)	1	67.622	1.48%	\$598

PRIOR YEAR ASSESSMENT INFORMATION

YEAR	ACTUAL VALUE	ASSESSED VALUE	MILL LEVY	AD VALOREM TAXES
2022	\$518,480	\$150,360	67.62	\$10,168
2021	\$518,480	\$150,360	65.78	\$9,891
2020	\$29,360	\$2,380	64.89	\$154
2019	\$29,360	\$2,380	63.08	\$150
2018	\$23,700	\$2,700	61.13	\$165
2017	\$23,700	\$2,700	60.54	\$163
2016	\$21,630	\$2,750	56.80	\$156

Contact the Treasurer's Office for current property tax amount due. Do not use the figures above to pay outstanding property taxes.

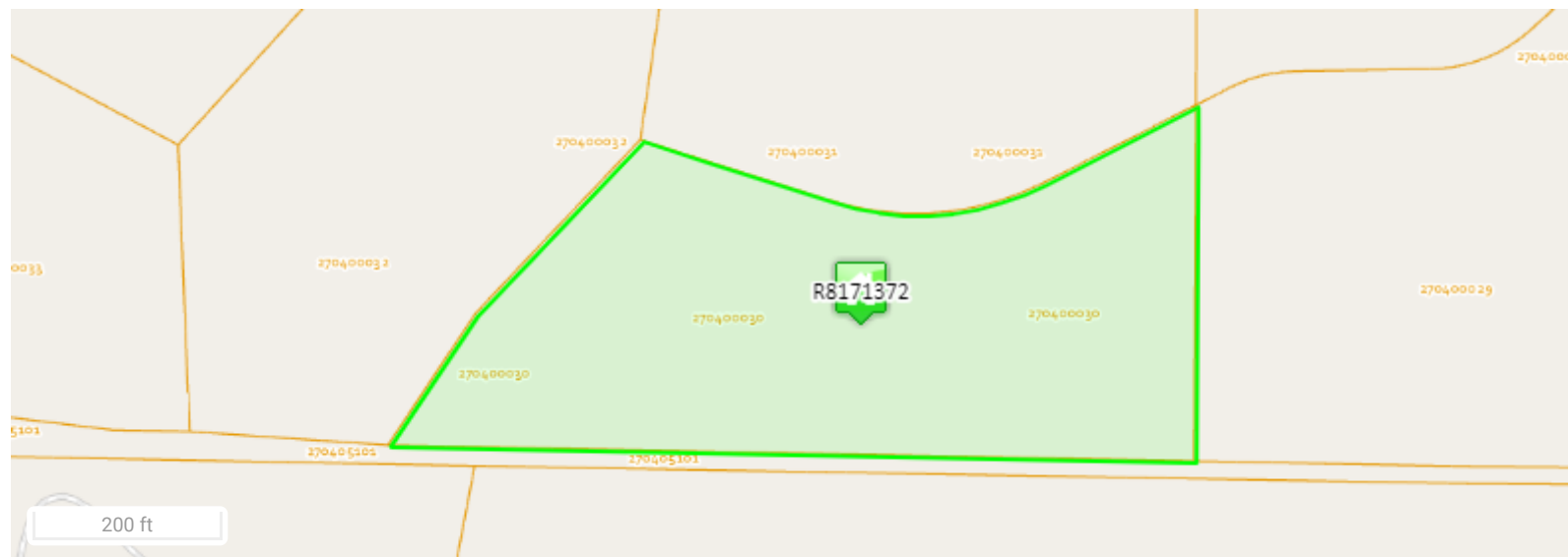



Data last updated: 08/29/2023