

### TYPICAL 4-PLEX LANDSCAPE

1:118

#### General Notes and Specifications:

- All areas disturbed by construction and not designated a shrub bed or wildflower seed, shall be planted with the specified native grass seed.
- The contractor shall maintain positive drainage away from all walls and walkways. Fine grading shall be approved prior to planting.
- The Landscape Plan shall be reviewed on site prior to installation to ensure planting meets the intent of the design guidelines and county wildfire mitigation standards.
- Quantity and location of "natural" shrub plantings within Wildfire Mitigation Zone 2 shall be subject to field review by Wildfire Mitigation Officer.
- See Civil Engineering sheets for final grading and drainage.
- Snow Storage area shall be a min. of 25% of all driveway and parking areas.

#### Revegetation Notes:

- Seed shall be broadcast and raked to 1 4" depth.
- Apply Biodegradable Green Dyed-Wood Cellulose-Fiber Mulch to all seeded Areas at a rate of 20 lbs. per 1,000 s.f.
- Prior to seeding, apply min. 6" topsoil, 10 lbs./1,000 s.f. Superphosphate and 40 lbs./1,000 s.f. Biosol Complete Fertilizer.

#### Fire Mitigation Notes:

- Zone 1 (0 - 30' from building): no flammable plants shall be planted within 30' of the structure or attachments.
- Zone 2 (30 - 100' from building): a 10' crown separation must be maintained for all conifers and shrubs over 4'. A 4' crown separation must be maintained for shrubs under 4'.
- Plants listed on forest service publication 6.305 FireWise Plant Material can be used in any zone.
- Final existing vegetation to be limbed or removed will be subject to the constraints of the final unit site plans and reviewed on site with a representative from the Wildfire Mitigation Officer.

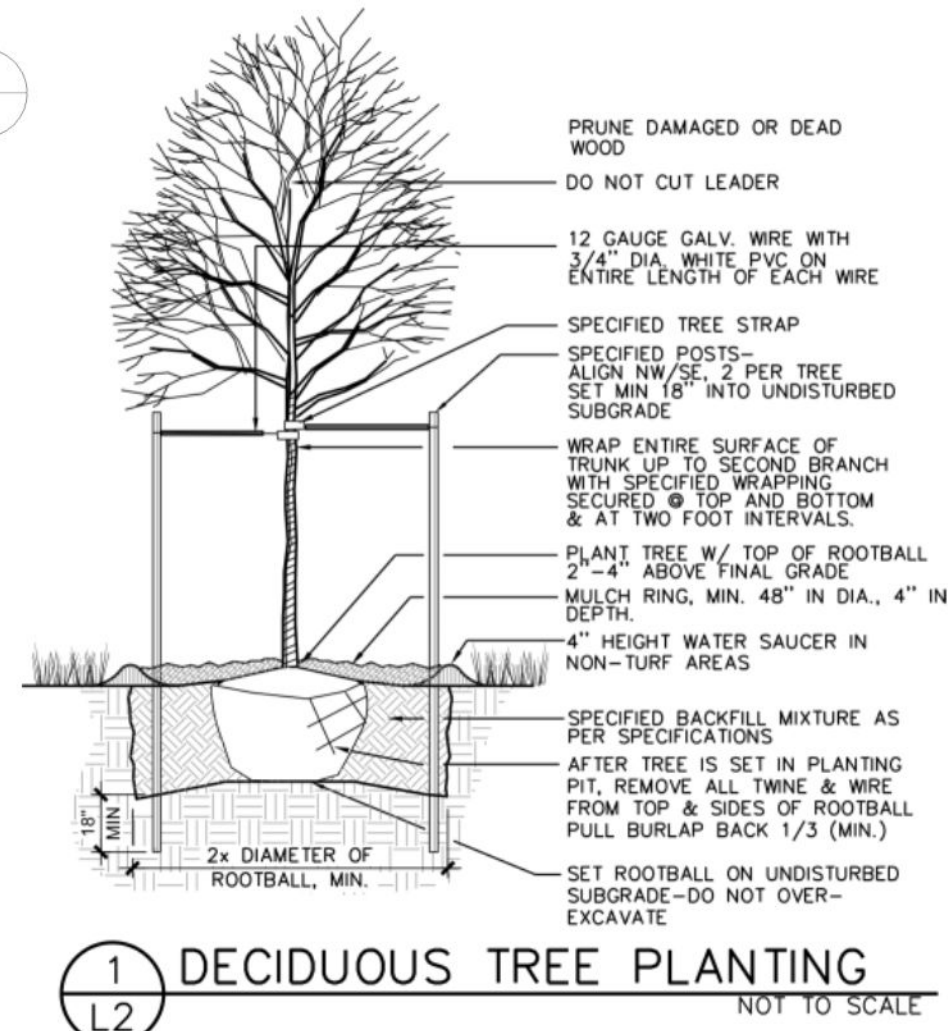

1 DECIDUOUS TREE PLANTING NOT TO SCALE

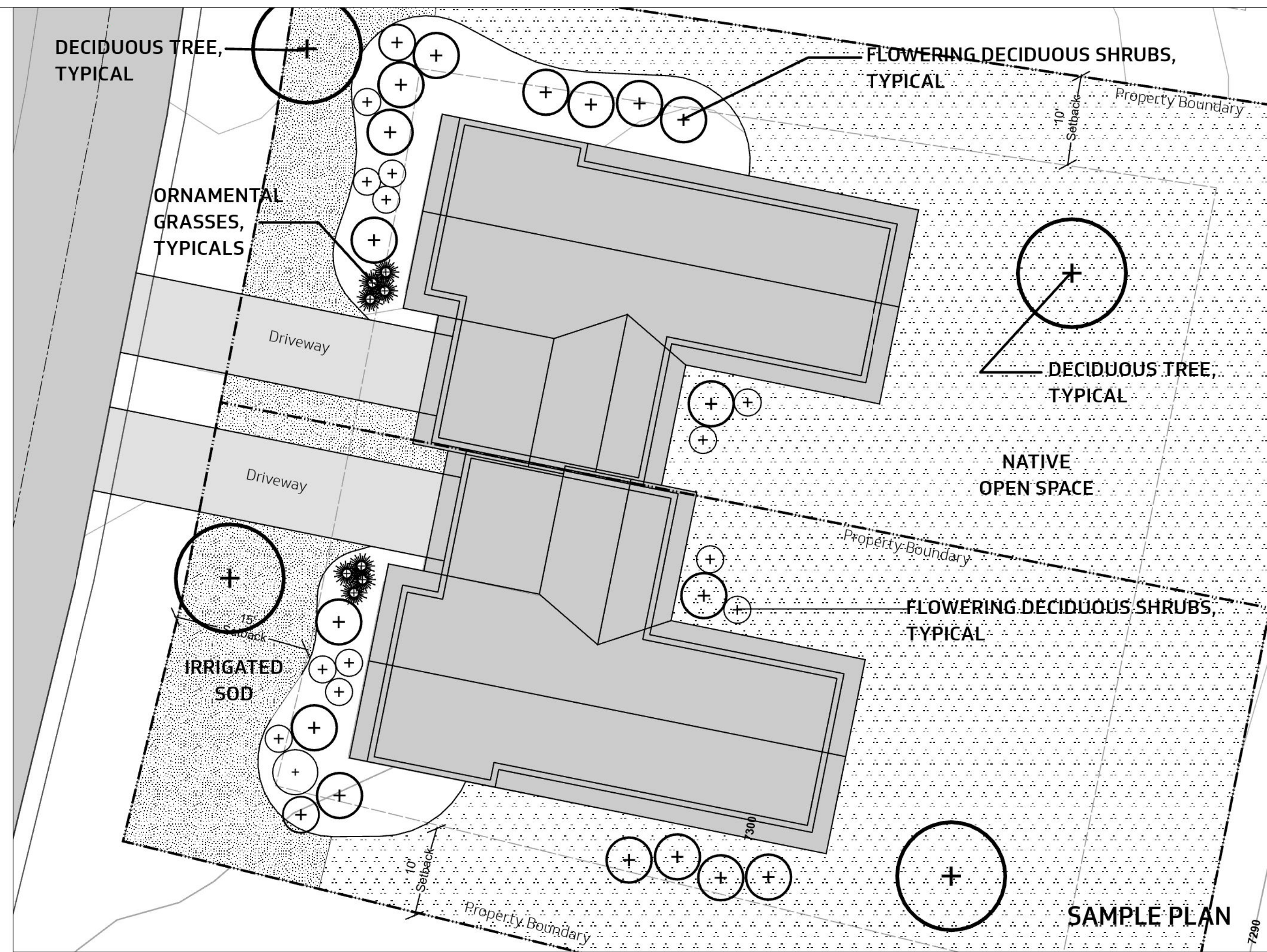

### PLANT LIST FOR TYPICAL LOT LAYOUT

NOTE: ALL PLANT MATERIAL FOUND WITHIN 30' WILDFIRE DEFENSIBLE ZONE IS CHOSEN FROM THE FIREWISE PLANT MATERIALS LIST

COMMON/BOTANICAL NAME	FIRE MITIGATION ZONE	SIZE	COMMENTS
<b>EVERGREEN TREES (ONLY TO BE LOCATED OUTSIDE THE 30' DEFENSIBLE ZONE)</b>			
Colorado Blue Spruce <i>Picea pungens</i>	2	8' ht.	Specimen quality B&B, staked
Colorado Blue Spruce <i>Picea pungens</i>	2	10' ht.	Specimen quality B&B, staked
White Fir <i>Abies concolor</i>	2	8' ht.	Specimen quality B&B, staked
<b>DECIDUOUS TREES</b>			
Quaking Aspen <i>Populus tremuloides</i>	1 & 2	2.5" cal.	Specimen quality B&B, staked
Amur Maple <i>Acer ginnala</i>	1 & 2	2.5" cal.	Specimen quality B&B, staked
Patmore Ash <i>Fraxinus pennsylvanica 'Patmore'</i>	1 & 2	3" cal.	Specimen quality B&B, staked
Shuber Chokecherry <i>Prunus virginiana 'shubert'</i>	1 & 2	3" cal.	Specimen quality B&B, staked
<b>PERENNIALS (Approximately X sf. @ 12" O.C. spacing)</b>			
Assorted Perennials (All perennials to be chosen by landscape installer from FIREWISE PLANT MATERIALS LIST)			
Blue Avena Grass <i>Helictotrichon sempervirens</i>	1 & 2	1 gal.	Container Full
Little Bluestem <i>Schizochyrium scoparium</i>	1 & 2	1 gal.	Container Full
<b>SEMI-EVERGREEN/BROADLEAF EVERGREEN SHRUBS</b>			
Common Mountain Mahogany <i>Cercocarpus montanus</i>	1 & 2	5 gal.	Container, 5 canes Minimum 24" - 36" ht.

### NATIVE SEED REVEGETATION MIX

Scientific name	Common name	Variety
<i>Pascopyrum smithii</i>	Western wheatgrass	Arriba
<i>Pseudoroegneria spicata</i>	Beardless wheatgrass	Whitmar
<i>Elymus trachycaulus</i>	Slender wheatgrass	San Luis
<i>Bromus marginatus</i>	Mountain brome	Bromar
<i>Leymus cinereus</i>	Basin wildrye	Magnar
<i>Poa secunda</i>	Sandberg bluegrass	
<i>Poa fendleriana</i>	Muttongrass	
<i>Achnatherum hymenoides</i>	Indian ricegrass	
<i>Festuca idahoensis</i>	Idaho fescue	

### TYPICAL DUPLEX LANDSCAPE

1:120

COMMON/BOTANICAL NAME	FIRE MITIGATION ZONE	SIZE	COMMENTS
<b>DECIDUOUS SHRUBS</b>			
Arnold's Red Honeysuckle <i>Lonicera tatarica 'Arnold's Red'</i>	1 & 2	5 gal.	Container, 5 canes Minimum 24" - 36" ht.
Burkewood Daphne <i>Daphne burkwoodii 'Somerset'</i>	1 & 2	5 gal.	Container, 5 canes Minimum 18" - 24" ht.
Common Lilac <i>Syringa vulgaris</i>	1 & 2	5 gal.	Container, 5 canes Minimum 24" - 36" ht.
Golden Currant <i>Ribes aureum</i>	1 & 2	5 gal.	Container, 5 canes Minimum 24" - 36" ht.
Mountain Ninebark <i>Physocarpus monogynus</i>	1 & 2	5 gal.	Container, 5 canes Minimum 12" - 18" ht.
Mountain Snowberry <i>Symphoricarpos oreophilus</i>	1 & 2	5 gal.	Container, 5 canes Minimum 10" - 12" ht.
Redtwig Dogwood <i>Cornus stolonifera</i>	1 & 2	5 gal.	Container, 5 canes Minimum 24" - 36" ht.
Sacktoot Serviceberry <i>Amelanchier alnifolia</i>	1 & 2	5 gal.	Container, 5 canes Minimum 24" - 36" ht.
Boulder Raspberry <i>Rubus deliciosus</i>	1 & 2	5 gal.	Container, 5 canes Minimum 18" - 24" ht.
Wax Flower <i>Jamesia americana</i>	1 & 2	5 gal.	Container, 5 canes Minimum 24" - 36" ht.
Russel Buffaloberry <i>Shepherdia canadensis</i>	1 & 2	5 gal.	Container, 5 canes Minimum 24" - 36" ht.

### NATIVE SEED REVEGETATION MIX (Continued)

Scientific name	Common name	Variety
<i>Eriogonum umbellatum</i>	Sulfur-flowered buckwheat	
<i>Achillea m. lanulosa</i>	Western Yarrow	
<i>Symphytotrichum chilensis</i>	Pacific aster	
<i>Astragalus cicer</i>	Cicer milkvetch	Monarch
<i>Balsamorhiza sagittata</i>	Arrowleaf balsamroot	
<i>Linum perenne</i>	Blue flax	Appar
<i>Medicago sativa</i>	Alfalfa	Ladak
<i>Penstemon strictus</i>	Rocky Mtn penstemon	Bandera
<i>Sanguisorba minor</i>	Small burnett	Delar
<i>Onobrychis viciaefolia</i>	Sainfoin	
<i>Crepis acuminata</i>	Tapertip hawksbeard	
<i>Viguera multiflora</i>	Showy Goldeneye	
<i>Artemisia tridentata</i>	Big sage	Vaseyana
<i>Ericameria nauseosus</i>	Rubber rabbitbrush	

## TYPICAL LANDSCAPE PLANS

PROJECT Preliminary Plan Submittal

CLIENT Saltbox Custom Homes Inc.

LOCATION

LEGEND



DATE 01.03.2024 DRAWN BY MSJ

VERSION 01 SHEET 2 / 3

PROJECTION State Plane Colorado North (US Feet)

DATUM North American Datum 1983 (NAD83)

SCALE 1:120 1:120

20'

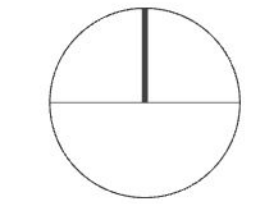

**DISCLAIMER**  
This product is for informational purposes and may not have been prepared for, or be suitable for legal, engineering, or surveying purposes. Users of this information should review or consult the primary data and information sources to ascertain the usability of the information. The maps are distributed "AS-IS" without warranties of any kind, either expressed or implied, including but not limited to warranties of suitability to a particular purpose or use.



**CONTOUR**  
DESIGN COLLECTIVE

WEB www.contourdesigncollective.com

EMAIL info@contourdesigncollective.com

PHONE 970.409.9012