

K:\cos\_civil\196778000\_stagecoach\CADD\plansheets\Early Activation\EA-GP-OVR.dwg Lundberg, Andrew 12/3/2024 3:22 PM

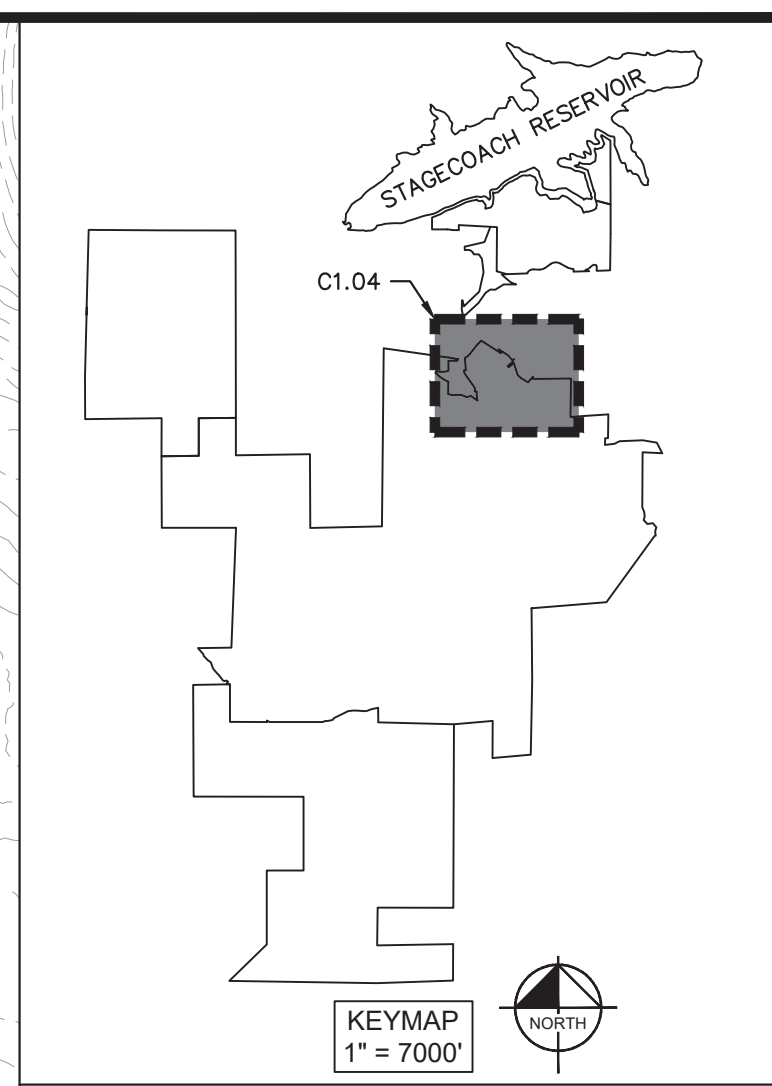

**LEGEND**

W	EXISTING WATER LINE
S	EXISTING SANITARY SEWER LINE
UT	EXISTING TELEPHONE LINE
FO	EXISTING FIBER OPTIC LINE
COM	EXISTING COMMUNICATION LINE
E	EXISTING ELECTRIC LINE
OH	EXISTING OVERHEAD POWER LINE
W	PROPOSED WATER DISTRIBUTION LINE
W (T)	PROPOSED WATER TRANSMISSION LINE
NPW	PROPOSED NON-POTABLE WATER LINE
S	PROPOSED SANITARY SEWER LINE
S (FM)	PROPOSED SANITARY SEWER LINE (FORCEMAIN)
S (LP)	PROPOSED SANITARY SEWER LINE (LOW PRESSURE)
E	PROPOSED ELECTRIC LINE
	PROPOSED COMMUNICATION LINE
	PROPOSED RIGHT-OF-WAY LINE
	PROPERTY LINE
	PROPOSED LOT LINE
	PROPOSED ROADWAY Q
X	EXISTING FENCE
	EXISTING SKI RUN
	PROPOSED SKI RUN
	EXISTING WETLAND
	PROPOSED DETENTION POND AREA
	PROPOSED BRIDGE
	PROPOSED SKI LIFT
	EXISTING EDGE OF GRAVEL ROAD
	EXISTING EDGE OF ASPHALT ROAD
	PROPOSED 50' WETLAND BUFFER
	PROPOSED CULVERT
	EXISTING CULVERT
-6000-	EXISTING MAJOR CONTOUR
6000	EXISTING MINOR CONTOUR
6000	PROPOSED MAJOR CONTOUR
6000	PROPOSED MINOR CONTOUR

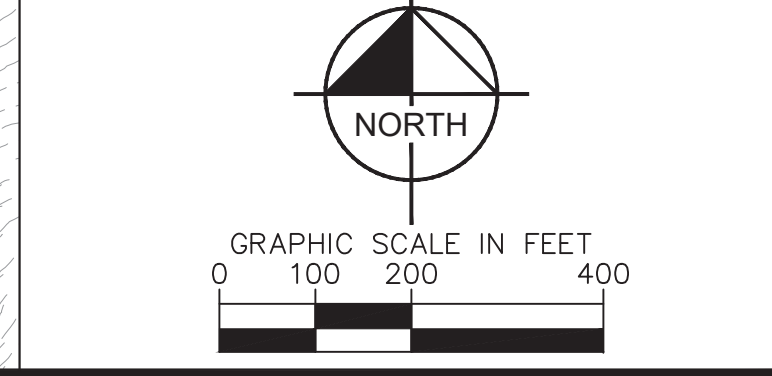

NO.	REVISION	BY	DATE	APPR.

**Kimley»Horn**  
 2024 KIMLEY-HORN AND ASSOCIATES, INC.  
 2 North Nevada Avenue, Suite 900  
 Colorado Springs, Colorado 80903 (719) 453-0180

DESIGNED BY: JGJ  
 DRAWN BY: VALUE  
 CHECKED BY: EJG  
 DATE: 09/20/24

STAGECOACH MOUNTAIN RANCH  
 ROUTT COUNTY, COLORADO  
 EARLY ACTIVATION PLANS  
 OVERALL GRADING & DRAINAGE PLAN

**PRELIMINARY**  
 FOR REVIEW ONLY  
 NOT FOR  
 CONSTRUCTION

**Kimley»Horn**  
 Kimley-Horn and Associates, Inc.

PROJECT NO.  
196778000

SHEET  
C1.04

K:\\_civil\196778000\_ststagecoach\CADD\plansheets\Early Activation\EA-GDP.dwg Lundberg, Andrew 12/3/2024 3:22 PM

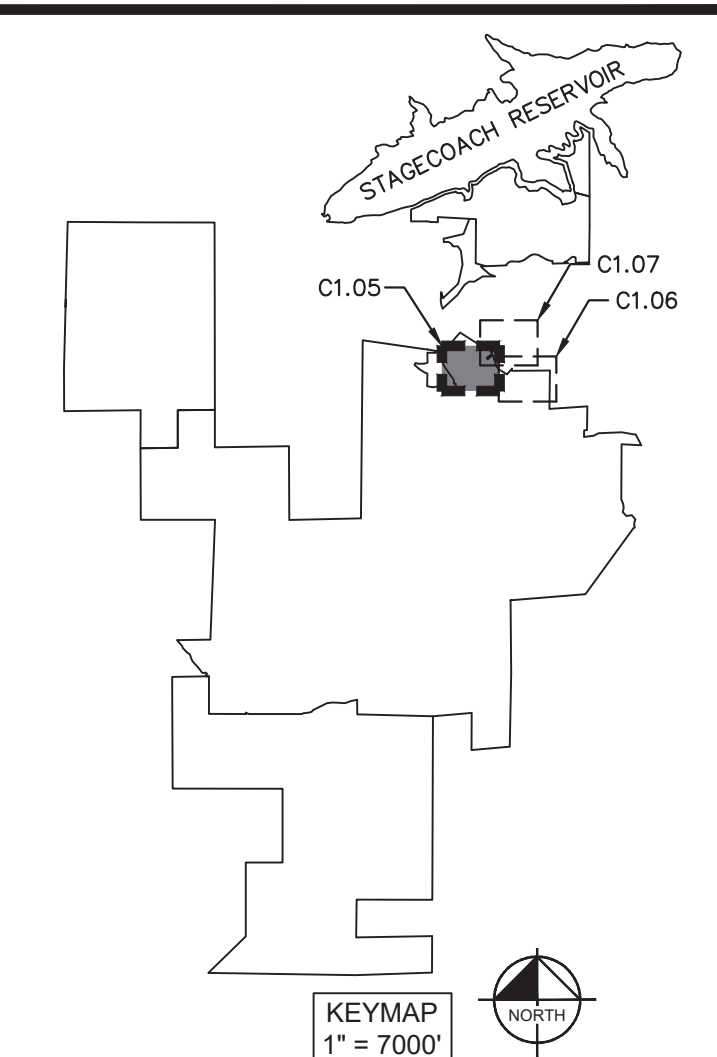

LEGEND	
W	EXISTING WATER LINE
S	EXISTING SANITARY SEWER LINE
UT	EXISTING TELEPHONE LINE
FO	EXISTING FIBER OPTIC LINE
COM	EXISTING COMMUNICATION LINE
E	EXISTING ELECTRIC LINE
OH	EXISTING OVERHEAD POWER LINE
W	PROPOSED WATER DISTRIBUTION LINE
W (T)	PROPOSED WATER TRANSMISSION LINE
NPW	PROPOSED NON-POTABLE WATER LINE
S	PROPOSED SANITARY SEWER LINE
S (FM)	PROPOSED SANITARY SEWER LINE (FORCEMAIN)
S (LP)	PROPOSED SANITARY SEWER LINE (LOW PRESSURE)
E	PROPOSED ELECTRIC LINE
	PROPOSED COMMUNICATION LINE
	PROPOSED RIGHT-OF-WAY LINE
	PROPERTY LINE
	PROPOSED LOT LINE
	PROPOSED ROADWAY
X X	EXISTING FENCE
	EXISTING SKI RUN
	PROPOSED SKI RUN
	EXISTING WETLAND
	PROPOSED DETENTION POND AREA
	PROPOSED BRIDGE
	PROPOSED SKI LIFT
	EXISTING EDGE OF GRAVEL ROAD
	EXISTING EDGE OF ASPHALT ROAD
	PROPOSED 50' WETLAND BUFFER
	PROPOSED CULVERT
	EXISTING CULVERT
-6000-	EXISTING MAJOR CONTOUR
-6000-	EXISTING MINOR CONTOUR
-6000-	PROPOSED MAJOR CONTOUR
-6000-	PROPOSED MINOR CONTOUR

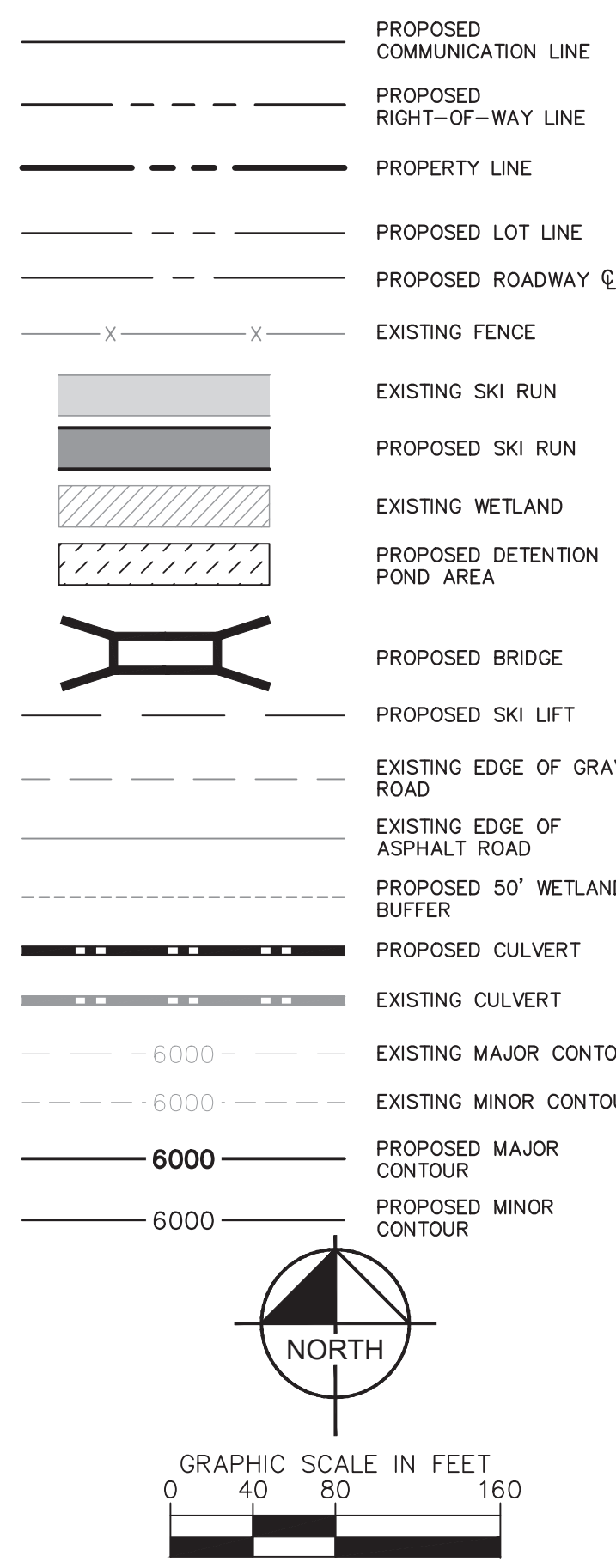

NO.	REVISION	BY	DATE	APPR.

**Kimley»Horn**  
 2024 KIMLEY-HORN AND ASSOCIATES, INC.  
 2 North Nevada Avenue, Suite 900  
 Colorado Springs, Colorado 80903 (719) 453-0180

DESIGNED BY: JGJ  
 DRAWN BY: VALUE  
 CHECKED BY: EJG  
 DATE: 09/20/24

**STAGECOACH MOUNTAIN RANCH**  
**ROUTT COUNTY, COLORADO**  
**EARLY ACTIVATION PLANS**  
**GRADING & DRAINAGE PLAN**

**PRELIMINARY**  
 FOR REVIEW ONLY  
 NOT FOR  
 CONSTRUCTION  
**Kimley»Horn**  
 Kimley-Horn and Associates, Inc.  
 PROJECT NO.  
 196778000  
 SHEET  
 C1.05