

Reclamation Plan:  
THUs, water conex, sewer, dumpsters, transformers, and all other associated material will be removed from the site. The pad site will be reclaimed and returned to a vegetated state with a native seed mix.

Reclamation of THUs to be completed as specified in the terms defined in the SUP.

LEGEND

- 5660 SURFACE CONTOUR
- X FENCE LINE
- CL DRAINAGE
- PROPERTY LINE
- GAS LINE
- TELEPHONE LINE
- DIRT ROAD
- POWERLINE (WOOD POLES)
- PERMIT BOUNDARY
- POWERLINE TOWER
- SEDIMENT POND

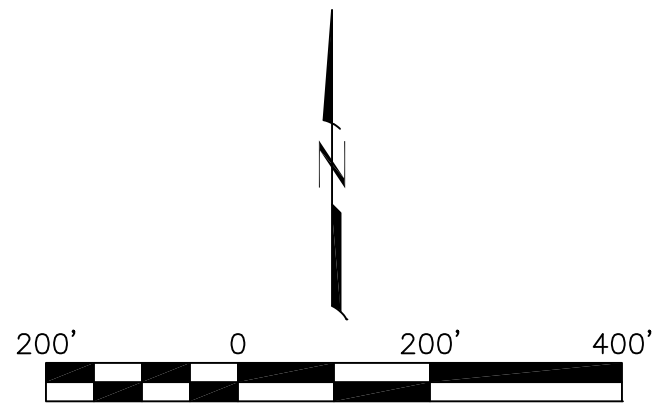
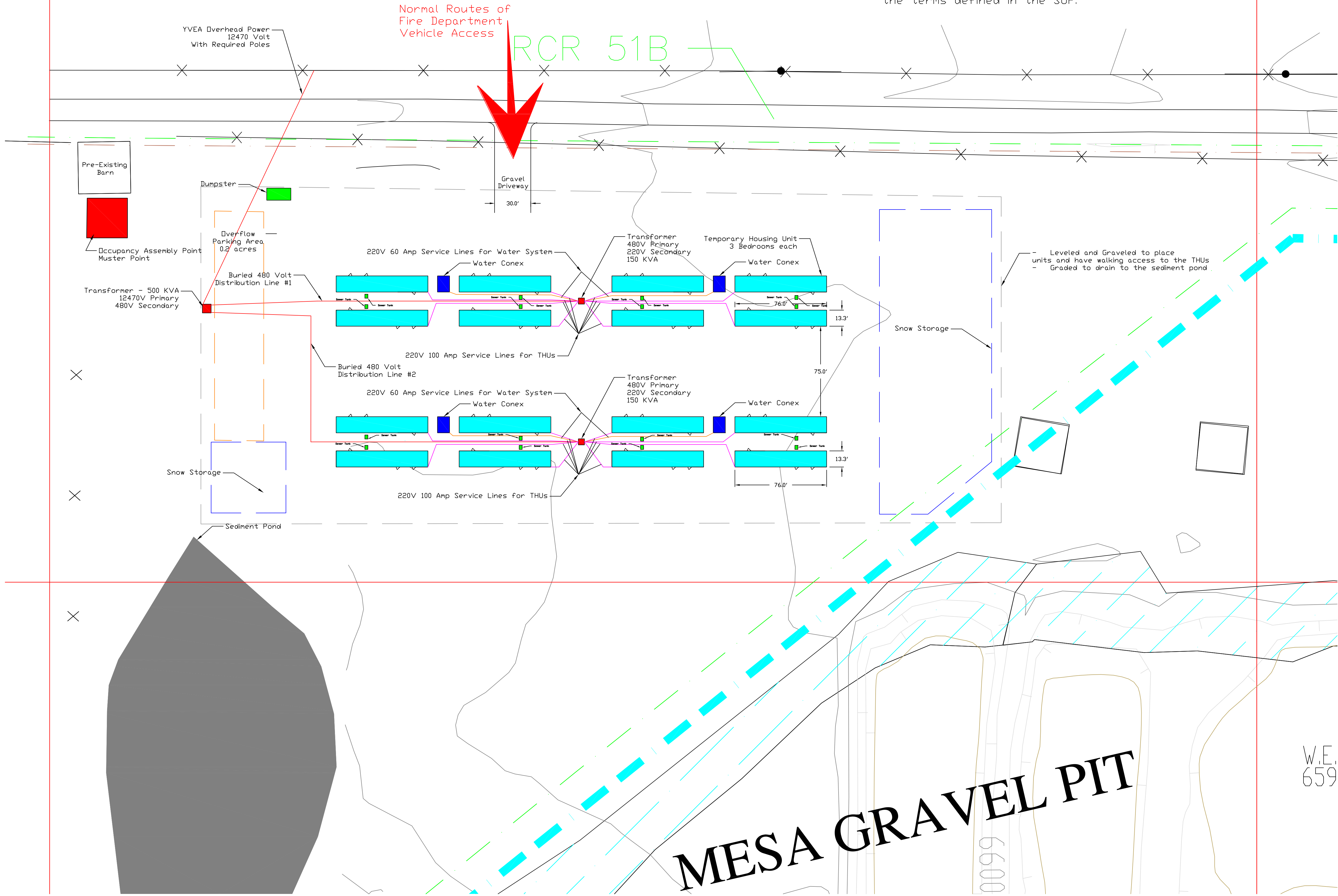

SCALE  
SAGECREEK\Seneca Data VCAMPBELL\MESAGRAVEL\MESA2012RECLAM.dwg

PEABODY  
TEMPORARY HOUSING  
SITE PLAN

**Peabody Sage Creek Mining, LLC.**  
PEABODY SAGE CREEK MINE  
36600 Routt County Road # 27  
Hayden, Colorado 81639

Location: Routt County, Colorado

Date Created: 02-04-2025

Map Projection: Seneca local

Drawn By: MLK