

BUCKETHEAD RANCH HEADQUARTERS

MAIN RESIDENCE

PORTIONS OF THE S1/2 S1/2 NE1/4 OF SECTION 19
T5N R88W, 6th P.M., ROUTT COUNTY, COLORADO

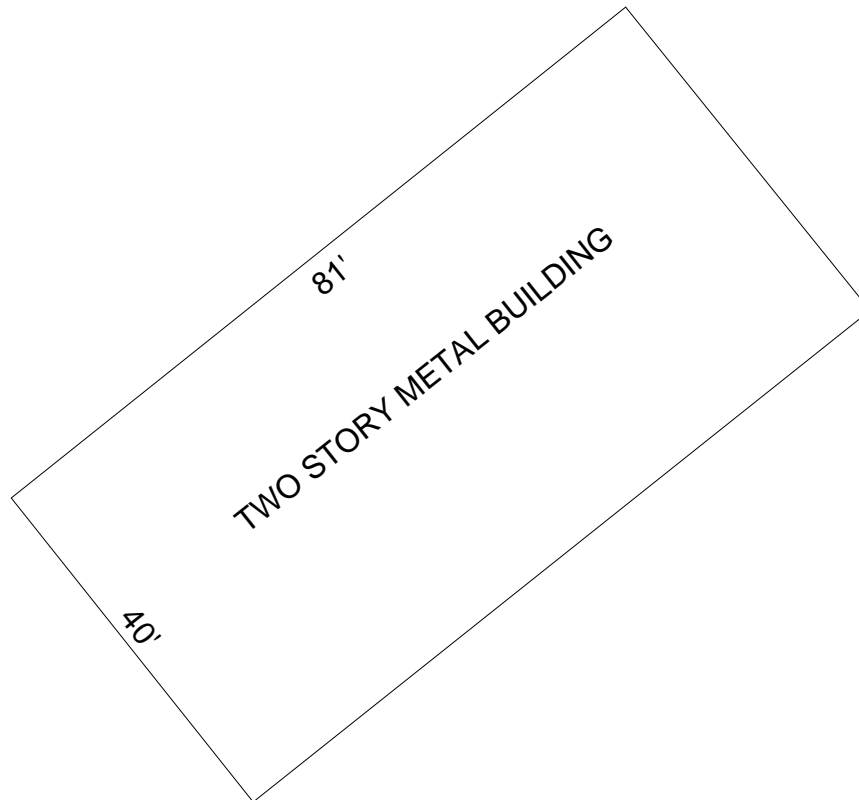

TWO STORY METAL BUILDING
CONCRETE FOUNDATION
4 BEDROOM, 4 1/2 BATH LIVING QUARTERS ABOVE
STORAGE & RECREATION BELOW

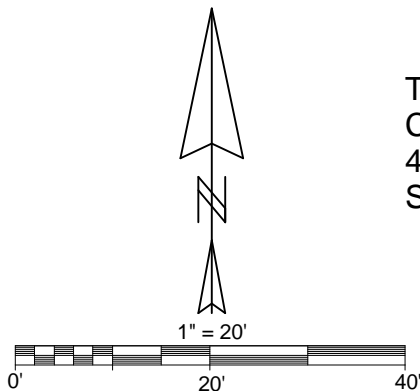

NOTICE: According to Colorado Law, you must commence any legal action based on any defect in this survey within three years after you first discover such defect, in no event may any action be commenced more than ten years from the date of certification shown hereon.

JMS BEAR RANCH

BUCKETHEAD RANCH
HEADQUARTERS

S1/2 S1/2 NE1/4 OF SECTION 19
T5N R88W, 6th P.M.

ROUTT COUNTY, COLORADO

DOWLING LAND SURVEYORS, LLC
P.O. BOX 954
HAYDEN, COLORADO 81639
(970) 276-3613
dowling@plotz.biz

SCALE	DRG	DATE	FILE
1" = 20'	GRD	1/6/25	JMSRES25