

GRADING:

- GRADING SHALL OCCUR WITHIN THE PROPERTY LIMITS. WHERE OFF-SITE WORK IS APPROVED, WRITTEN PERMISSION OF THE ADJACENT PROPERTY OWNER MUST BE OBTAINED PRIOR TO ANY OFF-SITE GRADING OR CONSTRUCTION.
- NO WORK SHALL OCCUR IN WETLANDS OR FLOODPLAINS WITHOUT APPROPRIATE PERMITS. ANY WORK SHALL BE IN ACCORDANCE WITH THE ISSUED PERMITS.
- GRADING DESIGN DOES NOT CALL FOR THE CONSTRUCTION OF SLOPES GREATER THAN 2:1.

EROSION CONTROL:

- CONTRACTOR SHALL SUBMIT A CONSTRUCTION SITE MANAGEMENT PLAN TO THE CITY FOR APPROVAL PRIOR TO BUILDING PERMIT ISSUANCE.
- CONTRACTOR SHALL WORK IN A MANNER THAT MINIMIZES THE POTENTIAL FOR EROSION.
- CONTRACTOR SHALL BE RESPONSIBLE FOR INSTALLING, INSPECTING, AND MAINTAINING ALL NECESSARY EROSION AND SEDIMENT CONTROL DURING CONSTRUCTION AND REMOVING EROSION CONTROL WHEN PROJECT IS COMPLETE AND VEGETATION IS ESTABLISHED.
- ANY AREA DISTURBED BY CONSTRUCTION AND NOT PAVED OR NATURAL ROCK SURFACE SHALL BE REVEGETATED WITHIN ONE CONSTRUCTION SEASON.



DRIVEWAY EARTHWORK QUANTITIES:

AREA OF DISTURBANCE:	38,527	SQ. FT.
TOPSOIL STRIPPING:	713	CU. YDS.
TOTAL CUT:	900	CU. YDS.
TOTAL FILL:	4,745	CU. YDS.
NET (FILL):	4,559	CU. YDS.

NOTES:

- TOPSOIL STRIPPING VOLUME ASSUMES AN AVERAGE TOPSOIL DEPTH OF 0.5 FEET. ACTUAL TOPSOIL DEPTH MAY VARY ACROSS THE ENTIRE AREA OF DISTURBANCE.
- THE TOTAL CUT VOLUME INCLUDES TOPSOIL STRIPPING.
- A FILL FACTOR OF 1.10 WAS USED FOR CUT-FILL VOLUME CALCULATIONS.
- FILL VOLUME INCLUDES NATIVE MATERIAL AND ALL IMPORT MATERIALS. (I.E. GRAVEL, ASPHALT, CONCRETE, ETC.)
- STRIPPED TOP SOIL MAY ONLY BE USED FOR MINIMUM 4" LIFT ACROSS ALL DISTURBED AREAS NOT RECEIVING HARDSCAPING.

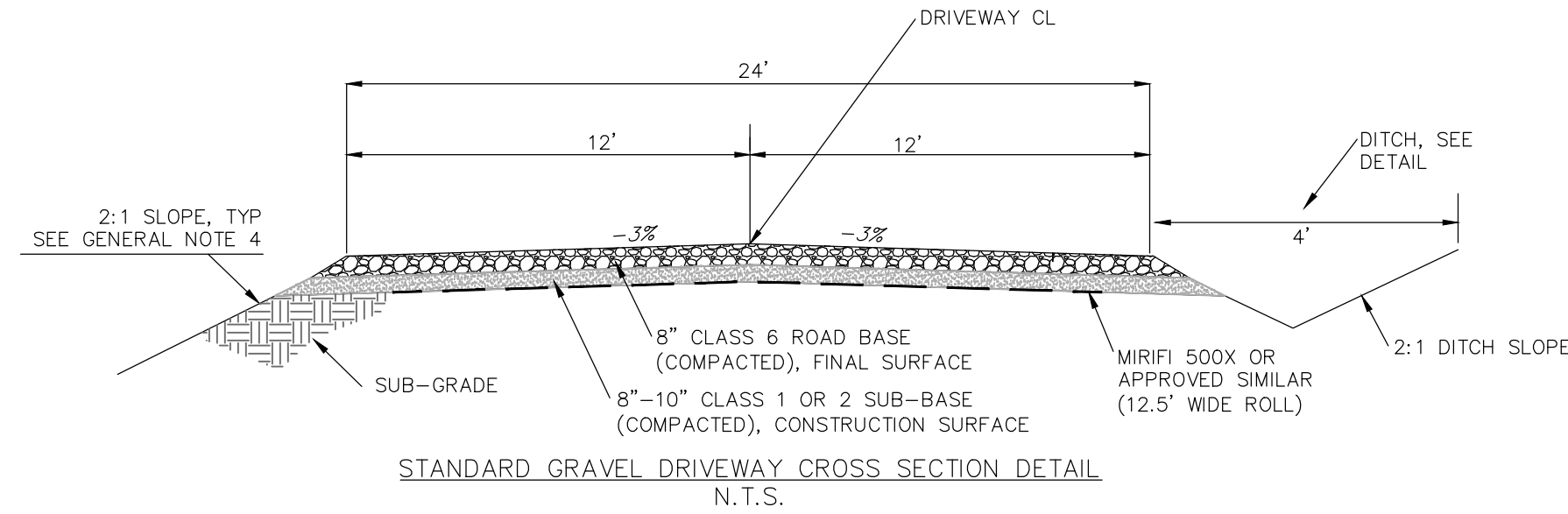
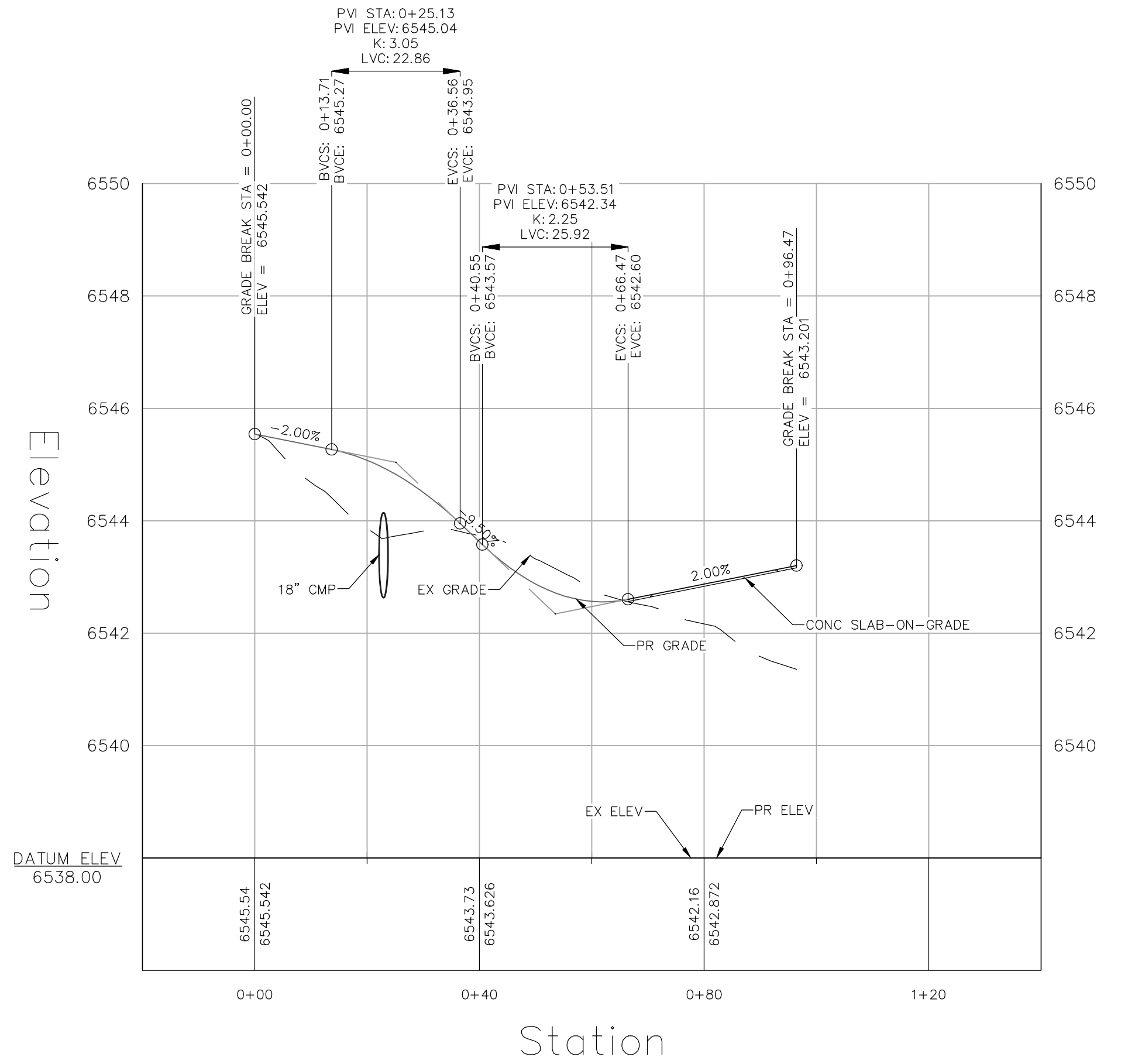

GRAVEL DRIVEWAY SURFACING NOTES:

- STRIP TOP LAYER OF VEGETATION AND ORGANICS FROM THE EXISTING TOPSOIL (3"-4"). MIRIFI 500X OR APPROVED SIMILAR GEO-TEXTILE FABRIC SHALL BE USED TO BRIDGE TOPSOIL AND SUB-BASE COURSE. CONSULT THE GEO-TECHNICAL ENGINEER OF RECORD FOR ADDITIONAL INFORMATION.
- PRIOR TO THE PLACEMENT OF SUB-BASE AGGREGATES, THE EXPOSED SUB-GRADE SOILS SHALL BE UNIFORMLY SCARIFIED, MIXED, AND MOISTURE TREATED TO WITHIN 2% OF THE OPTIMUM MOISTURE CONTENT, AND THEN RE-COMPACTED TO AT LEAST 95% OF THE MAXIMUM STANDARD PROCTOR DENSITY.
- BASE COURSE AND SUB-BASE AGGREGATES SHALL MEET THE CDOT CLASS 6 ABC AND CLASS 2/1 ABC SPECIFICATIONS, RESPECTIVELY. BASE COURSE AND SUB-BASE AGGREGATES SHALL BE PLACED IN ONE LIFT AND COMPACTED TO AT LEAST 95% OF THE MAXIMUM MODIFIED PROCTOR DENSITY IN ACCORDANCE WITH ASTM 1557.
- DRIVEWAY SLOPES SHALL BE FINE GRADED AND TRACKED PERPENDICULAR TO THE DRIVEWAY CENTERLINE. ALL 2:1 SLOPES SHALL BE SEEDED WITH NATIVE GRASS SEED AND STABILIZED STRAW BLANKET OR SIMILAR EROSION CONTROL MAT. SEED SHALL BE WATERED AS NECESSARY TO PROMOTE AND SUSTAIN GROWTH.

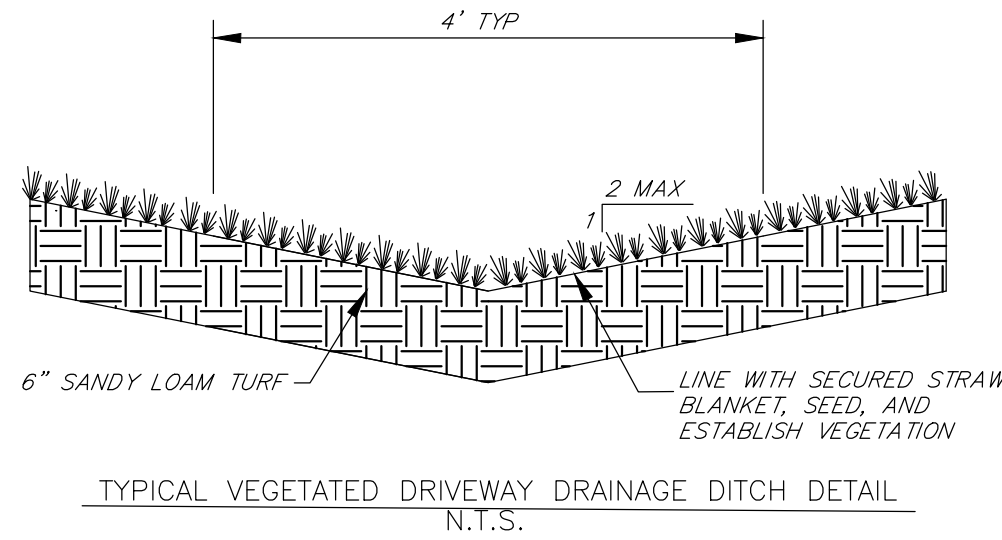

ABBREVIATIONS:

BOW	BOTTOM OF WALL
BLDG	BUILDING
CL	CENTERLINE
CMU	CONCRETE MASONRY UNITS
CO	CLEAN OUT
CONC	CONCRETE
ELEV	ELEVATION
EOC	EDGE OF CONCRETE
EOG	EDGE OF GRAVEL
EX	EXISTING
FFE	FINISHED FLOOR ELEVATION
FND	FOUNDATION
HP	HIGH POINT
INV	INVERT
LF	LINEAR FEET
PR	PROPOSED
SCH	SCHEDULE
SF	SQUARE FEET
SS	SNOW STORAGE
TOW	TOP OF WALL

LEGEND	
	PROPERTY BOUNDARY
	ADJACENT PROPERTY BOUNDARY
	EXISTING EASEMENT
	EXISTING EDGE OF ASPHALT
	EXISTING FENCE
	EXISTING 2' CONTOUR
	EXISTING 10' CONTOUR
	PROPOSED 2' CONTOUR
	PROPOSED 10' CONTOUR
	EXISTING DRAINAGE DITCH
	EXISTING STORM SEWER
	PROPOSED STORM SEWER
	EXISTING SEWER MAIN
	PROPOSED SEWER SERVICE
	EXISTING WATER MAIN
	PROPOSED WATER SERVICE
	EXISTING FIRE HYDRANT
	PROPOSED GRAVEL PAVING
	PROPOSED CONCRETE PAVING
	PROPOSED BUILDING FOOTPRINT
	EXISTING LABEL
	PROPOSED LABEL

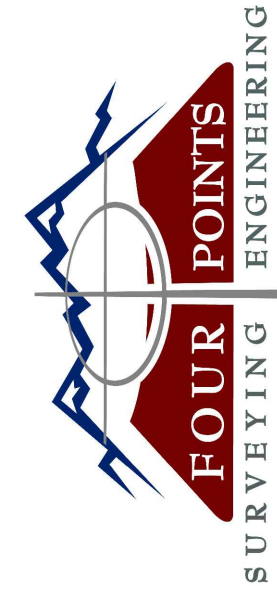

440 S. Lincoln Ave, Suite 4A
P.O. Box 775966
Steamboat Springs, CO 80487
(970)-871-6772
www.fourpointse.com

INT	REVISIONS	DATE

THUNDERSTICK ADVENTURES
SUP AMENDMENT
TBD
HAYDEN, CO 81639

Horizontal Scale

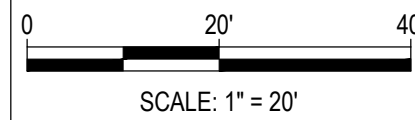

Contour Interval = 2 ft

DATE: 6-13-2022
JOB #: 2118-002
DRAWN BY: CFB
DESIGN BY: CFB
REVIEW BY:

IF THIS DRAWING IS PRESENTED IN A FORMAT OTHER THAN 24\"/>

DRAWING:

SITE PLAN

SHEET #

C1